

# **INITIAL ENVIRONMENTAL COMPLIANCE REPORT**

**15 ACRE "CYBER PARK" PROJECT AT SECTOR 69,  
VILLAGE FAZILPUR, JHARSA & BADSHAHPUR  
DISTRICT GURGAON, HARYANA**

**BEING DEVELOPED BY  
M/S UNITECH LIMITED**

**Ref: UL/15AcresCyberPark/1207/2016**

**To,**

**The Director(S)**

**Northern Regional Office, Ministry of Environment, Forests & Climate Change**

**Bays No.24-25, Sector-31-A**

**Dakshin Marg, Chandigarh – 160030**

**The Member Secretary,**

**State Environment Impact Assessment Authority (SEIAA), Haryana**

**Bays No. - 55-58, Prayatan Bhavan, Sector-2, Panchkula-134109**

**Haryana**

**Date: 12.07.2016**

**Sh. P.K. Mishra, Scientist E & Incharge Zonal Office (North),**

**Central Pollution Control Board**

**Zonal Office (North) PICUP Bhawan**

**Vibhuti Khand, Gomti Nagar**

**Lucknow - 226 010**

**The Chairman,**

**Haryana State Pollution Control Board,**

**C-11, Sector-6, Panchkula, Chandigarh-134109**

**Haryana**

**Subject: Submission of Initial Compliance report (along with soft copy in CD) for monitoring of implementation status of Conditions laid down in Environmental Clearance letter issued by SEIAA, Haryana for 15 acre "Cyber Park" Project at Sector 69, Village Fazilpur, Jharsa & Badshahpur District Gurgaon, Haryana being developed by M/s Unitech Limited**

**Ref: EC letter No. SEIAA/HR/2016/330 dated 04.05.2016 received on 10.05.2016.**

**Respected Sir,**

With reference to the above mentioned subject we are pleased to inform you that we have received the Environmental Clearance (EC) letter of the proposed 15 acre "Cyber Park" Project at Sector 69, Village Fazilpur, Jharsa & Badshahpur District Gurgaon, Haryana being developed by M/s Unitech Limited vide letter no EC letter No. SEIAA/HR/2016/330 dated 04.05.2016 received on 10.05.2016.

As per the Environmental Clearance, General Condition point no.ii we are submitting herewith the Initial Six-Monthly EC compliance report for the said project which includes the point wise reply to the conditions mentioned in the above said EC letter along with the relevant annexure.

We are committed to comply with the conditions mentioned in the above said EC letter as applicable and technically feasible of compliance for the project. Hope, you will find the information in order and it will meet your expectations to assess the implementation status of environmental safeguard measures for the project. This is for your kind information and necessary office records.

Thanking you in anticipation,

Yours faithfully,

**For Unitech Limited**

  
**Authorised Signatory**

**Encl: Initial Compliance report with relevant Annexure (with soft Copy in CD).**

<b>1</b>	<b>Project type:</b>	"Cyber Park"
<b>2</b>	<b>Name of the project</b>	15 acre "Cyber Park" Project at Sector 69, Village Fazilpur, Jharsa & Badshahpur District Gurgaon, Haryana being developed by M/s Unitech Limited
<b>3</b>	<b>Clearance letter (s) O. M No. &amp; dates:</b>	EC letter No. SEIAA/HR/2016/330 dated 04.05.2016 received on 10.05.2016.
<b>4</b>	<b>Location:</b> a) District (S) b) State (S) c) Latitudes/Longitudes	Gurgaon Haryana Latitude 28° 24' 31. 07" N and Longitude 76° 54' 27. 04" E
<b>5.</b>	<b>Address for correspondence:</b> a) Address of concerned project Chief Engineer (with pin code/Tel no./Telex/Fax No. E. mail address)  b) Address of Executive project Engineer/ manager (with pin code/ Tel No. Telex/ Fax No./E.mail address)	<b>Mr. Sunil Kher (Project Coordinator )</b> Telephone No. : 0124-4125-200 E-mail address : <a href="mailto:sunil.kher@unitechgroup.com">sunil.kher@unitechgroup.com</a>  <b>Mr. Sameer Singh ( Project In charge)</b> <b>Mobile: +91-9891990860</b> <b>sameer.s@unitechgroup.com</b>
<b>6.</b>	<b>Salient Features:</b> a) of the project          b) of the environmental management plans	The project involves the construction of " <b>Cyber Park</b> " project at the plot area of <b>15 Acres i.e. 60702.75 Sq.m.</b> The built up area of the project <b>349976.90 Sq.m</b> Total Green area 15849.3 sqm. i.e. 25.98% of plot area.  The total water requirement is estimated as <b>1174 KLD</b> . The fresh water requirement shall be <b>340 KLD</b> . Total quantity of wastewater generation will likely to be <b>878 KLD</b> . The generated sewage will be collected and treated in Sewage Treatment Plant of total capacity <b>1000 KLD</b> (200 KLD, 300KLD & 500 KLD). Treated waste water will be used for flushing, Horticulture and DG & HVAC cooling purposes and excess water will be used for construction activity(after treatment so that it is fit for being used in construction activities and conforms to the Indian standard for Plain and Reinforced Concrete- Code of Practice (Fourth Revision)- IS 456:2000).  ► Parking provision for the project is <b>4191 ECS</b> . ► Total power requirement approx 20844 KVA which will be supplied by DHBVN and others convenient sources. ► Solid waste collection, segregation and disposal will be as per the MSW Rules, 2000. ► The DG sets will be acoustically enclosed to meet the noise standards and will have proper stack height as per CPCB norms.
<b>7.</b>	<b>Break of the project area:</b> a) Submergence area: Forest & non-forest. b) Others	N/A, 15 acre "Cyber Park" Project does not fall in Aravali. In this regards, we have already obtained the NOC from concerned Deputy commissioner, stating that the project area does not fall under reserved forest/ protected forest and Section 4 & 5 of PLPA, 1900. The details are enclosed herewith as <b>Enclosure-I</b> for your ready reference.

8.	<p><b>Break of the project affected population with numeration of those losing houses/dwelling units only, agricultural land only both dwelling units and land less labourers/artisans.</b></p> <p>a) SC/ST/Adivasis b) Others</p> <p>(Please indicate whether these figures are based on any scientific and systematic survey carried out or only provisional figures. If survey has been carried out, give details and year of survey)</p>	<p>The proposed project site is earmarked for development of Cyber Park (residential) as per Master plan of Gurgaon Manesar Urban Complex 2031 and as per the license granted by DTCP, Haryana. The land is a vacant piece of land hence there will be no displacement of population. The license and google map copy of the project is enclosed herewith as <b>Enclosure-II</b> for your ready reference.</p>
9.	<p><b>Financial Details:</b></p> <p>Project cost as originally planned subsequent revised estimates and the year of price reference.</p> <p>a) Allocations made for environmental management plans with item wise and year wise break up. b) Benefit cost ratio/internal rate of return and the year of assessment. c) Weather ((c)) includes the cost of environmental management as shown in (b) above. d) Actual expenditure incurred on the project so far. e) Actual expenditure incurred on the environmental management so far:</p>	<p>Estimated project cost of the project is approximately Rs. <b>502.56 Crores</b></p> <p>Enclosed as <b>Enclosure-III</b>. N/A. N/A. We are yet to start the construction activities at the project site. Estimated project cost of the project is approximately <b>Rs. 502.56 Crores</b> The estimated project cost of Environmental Management plan is approximately <b>Rs. 257.8 Lacs</b> capital cost &amp; approximately <b>Rs. 29.58 Lacs/year</b> recurring expenses. Please refer <b>Enclosure-III</b> for details.</p>
10.	<p><b>Forest land requirement:</b></p> <p>a) The status of approval for diversion of forest land for non-forestry use. b) The status of clear felling. c) The status of compensatory afforestation, if any. d) Comments on the viability &amp; Sustainability of compensatory afforestation programme in the light of actual field experience so far.</p>	<p>N/A, already the license has been obtained from Department of Town and Country Planning, Haryana vide License No. 29 of 2009 dated 24/06/2009. Renewed license is valid upto 23-06-2017. (Copy of License enclosed as <b>Enclosure-II</b>). N/A. N/A. The proposed project site is earmarked for development of Cyber Park (residential) as per Master plan of Gurgaon Manesar Urban Complex 2031 and as per the license granted by DTCP, Haryana. The land is a vacant piece of land hence no compensatory a forestation plan is required for the project.</p>
11.	<p><b>The status of clear felling in non-forest areas (such as submergence area of reservoir, approach road) if any, with quantitative information.</b></p>	<p>N/A, 15 acre "Cyber Park" Project does not fall in Aravali. In this regards, we have already obtained the NOC from concerned Deputy commissioner, stating that the project area does not fall under reserved forest/protected forest and Section 4 &amp; 5 of PLPA, 1900. The details are enclosed herewith as <b>Enclosure-I</b> for your ready reference.</p>
12.	<p><b>Status of construction:</b></p> <p>a) Date of commencement (actual and/or planned). b) Date of completion (actual and/or planned).</p>	<p>The project will consist of 5 nos of Towers, Presently we have started the work for Tower No. 4. The construction schedule for the same has been attached as <b>Enclosure-IV</b>. 05.05.2016 31.12.2017 (For Tower No. 4)</p>
13	<p><b>Reasons for the delay if the project is yet to start:</b></p>	<p>Please refer the construction schedule attached as <b>Enclosure-IV</b>.</p>

**15 acre "Cyber Park" Project at Sector 69, Village Fazilpur, Jharsa & Badshahpur District  
Gurgaon, Haryana being developed by M/s Unitech Limited**

	<b>SPECIFIC CONDITION</b> <b>Construction Phase:-</b>	
1	A first aid room as proposed in the project report will be provided during construction and operation phase of the project.	Adequate first Aid facilities will be ensured at the project site to the labours which will engaged for the construction activities both during construction and operational phase of the project.
2.	Adequate drinking water and sanitary facilities shall be provided for construction workers at the site. Provision should be made for mobile toilets. Open defecation by the laboures is strictly prohibited. The safe disposal of waste water and solid wastes generated during the construction phase should be ensured. Efforts should be made to provide mobile STP for treatment of waste water during the construction phase.	Adequate facilities in regard to drinking water, sanitation for construction labours and solid waste management will be provided at the project site as per our Standard Operation Plan-Environment. Open defecation by the laborers will be strictly prohibited. Details are enclosed as <b>Annexure-I</b> .
3.	All the top soil excavated during construction activities shall be stored for use in horticulture/ landscape development within the project site.	Yes, Top soil excavated during the construction will be stored and be used later for horticulture/landscape development within the project site.
4.	The project proponent shall ensure that the building material required during construction phase is properly stored within the project area and disposal of construction waste should not create any adverse effect on the neighboring communities and should be disposed of after taking necessary precaution for general safety and health aspects of people, only in approved sites with the approval of competent authority.	Building material will be properly store in adequate place within the project area and will not be required any kind of disposal except of building material waste which will be reused in construction activity.  The site safety and health aspects measures will be implemented as per our Standard Operation Plan for Environment & Health enclosed as <b>Annexure-I</b> for your ready reference.
5	Construction spoils, including bituminous material and other hazardous materials, must not be allowed to contaminate watercourse and the dump sites for such material must be secured so that they should not leach into the ground water and any hazardous waste generated during construction phase, should be disposed off as per applicable rules and norms with necessary approval of the Haryana State Pollution Control Board.	As such no hazardous/ bituminous material will be proposed to use in construction activity. All possible precautions will be taken to prevent contamination of groundwater/leaching if any.
6	The diesel generator sets to be used during construction phase shall be of Ultra low sulphur diesel type and should conform to Environment (Protection) Rules prescribed for air and noise emission standards.	We have already received assurance from DHBVN for power supply to the project. Please refer to <b>Annexure-II</b> for the assurance letter from DHVBN. D.G. sets used in the construction phase are as per Environment (Protection) Rules for air and Noise emission standard. Only low sulphur diesel will used for DG sets. Regular six monthly monitoring of Ambient air quality and noise will be carried out by MoEF approved Lab where

		directly/indirectly we will monitor the D.G. sets with respect to pollution. This environmental monitoring report shall be submitted to your office for your necessary records.
7	The diesel required for operating DG sets shall be stored in underground tanks and if required, clearance from Chief controller of Explosive shall be taken.	During the construction phase diesel required for the running the D.G sets will be arranged on need base only. However, in the operational phase all the required clearance will be taken from Chief Controller of Explosives and submit to your office for your necessary records.
8	Ambient noise levels shall conform to residential standards both during day and night. Incremental pollution loads on the ambient air and noise quality should be closely monitored during construction phase. Adequate measures should be taken to reduce ambient air and noise level during construction phase, so as to conform to the stipulated residential standards of CPCB/MoEF.	Available best construction practices will be followed to take care of the Environment. Regular six monthly monitoring of Ambient air quality and noise will be carried out by MoEF&CC approved Lab and submitted to your office for your necessary records.
9	Fly ash shall be used as building material in the construction as per the provision of Fly Ash notification of September 1999 and amended as on 27 <sup>th</sup> August 2003.	Yes, Project Proponent will use adequate quantity of fly ash as building construction material.
10	Storm water control and its reuse as per CGWA and BIS standard for various applications should be ensured.	Storm water control and its re-use will be as per CGWB and BIS standards. Kindly refer the dual plumbing plan attached as <b>Annexure-III</b> .
11	Water demand during construction shall be reduced by use of Premixed concrete, curing agents and other best practices.	Yes, pre-mixed concrete will be used to reduce the water demand during the construction phase of the project.
12	Roof must meet perspective requirements as per Energy conservation Building Code by using appropriate thermal insulation material.	All the roofs will be designed as per ECBC norms and will be insulated to minimize heat gain
13	Opaque wall must meet prescriptive requirements as per Energy Conservation Building Code which is proposed to be mandatory for all air conditioned spaces while it is desirable for non-air-conditioned spaces by use of appropriate thermal insulation material to fulfill requirement.	The opaque wall will meet prescriptive requirements as per ECBC requirement as far as possible.
14	Approval of the competent authority shall be obtained for structural safety of the building on account of earthquake, adequacy of fire fighting equipments, etc. as per National Building Code including protection measures from lightning etc.	Will be complied with.
15	The Project Proponent as stated in the proposal shall construct 15nos. rain water harvesting pits under expansion for recharging the ground water within project premises. Rain water harvesting pits shall be designed to make provision for silting chamber and removal of floating matter before entering harvesting pit. Maintenance budget and persons responsible for maintenance must be provided. Care shall also be taken that contaminated water do not enter any RWH pit.	Yes, unit will be provide 15 Nos of rain water harvesting pits for the project. A design detail of rain water harvesting pits is enclosed herewith as <b>Annexure-IV</b> for your ready reference. Unit will take care for complete annual maintenance program for inhibition of contamination.

16	The project proponent shall provided adequate fire safety measure and equipment as required by Haryana fire service Act 2009 and instructions issued by the local Authority/Directorate of fire from time to time. Further the project proponent shall take necessary permission regarding fire safety scheme/NOC from competent Authority as required.	Yes, we will take care of the said stipulated condition and take all necessary permission from the competent Authority as applicable to the project.
17	The project proponent shall obtained assurance from DHBVN for supply of 20844 KVA of power supply before the start of construction. In no case project will be operational solely on generators without any power supply from any external power utility.	We have already received assurance from DHBVN for supply of 20844 KVA of power supply to the project. Please refer to <b>Annexure-II</b> .
18	Detail Calculation of power load and ultimately power load of project shall be submitted to DHBVN under intimation to SEIAA Haryana before the start of construction. Provision shall be made for electrical infrastructure in the project area.	Calculation of power load and ultimately power load of project has submitted to DHBVN. We have also received assurance from DHBVN for power supply to the project. Please refer to <b>Annexure-II</b> for the assurance letter from DHVBN.
19	The Project proponent shall not raise any construction in the natural land depression/Nallah/water course and shall ensure that the natural flow from the Nallah/water course is not obstructed.	Unit will comply with the said condition, there is no Nallah/water course existing in our project area.
20	The project proponent shall keep the plinth level of the building blocks sufficiently above the level of the approach road to the project. Levels of the other areas in the projects shall also be kept suitable so as to avoid flooding.	PP will comply with the said condition. Properly designed drainage system for domestic as well as storm water shall be provided to prevent Flooding.
21	Construction shall be carried out so that density of population does not exceed norms approved by Director General Town and country Department Haryana.	Yes, the construction of the said project will be carried out as per approved layout plan with population density norms approved by Director General Town and Country Department Haryana
22	The project proponent shall submit an affidavit with the deceleration that ground water will not be used for construction and only treated water should be used for construction.	Yes, the affidavit in this regard is already submitted to the SEAC, Haryana for the environmental clearance of the project. For carrying out the construction activities we will use STP treated water (after treatment so that it is fit for being used in construction activities and conforms to the Indian standard for Plain and Reinforced Concrete- Code of Practice (Fourth Revision)- IS 456:2000) at the project site. This STP treated water will be procured from our other operational projects as well as purchased from HUDA STP as per requirement.
23	The project proponent shall not cut any existing tree and project landscaping plan should be modified to including those trees in green area.	We will take care of the said stipulated condition for the project.
24	The project proponent shall ensure that the ECBC norms for composite climate zone are met. In particular building envelope, HVAC services,	We will take care of the said stipulated condition for the project.

	water heating, pumping, lighting and electrical infrastructure must meet	
25	Project proponent shall provide 3 meter high barricade around the project area, dust screen for every floor above the ground, proper sprinkling and covering of stored material to restrict dust and air pollution during construction.	To restrict dust and air pollution during construction the following measures will be undertaken: <ul style="list-style-type: none"> <li>• All the loose material either stacked or transported shall be provided with suitable covering;</li> <li>• Water sprinkling shall be done at the location where dust generation is anticipated;</li> </ul>
26	The project proponent shall construct a sedimentation basin in the lower level of the project site to trap pollutant and other wastes during rains.	Yes, PP will construct the necessary sedimentation basin in the project area if required for trapping project site pollutant and other wastes during rainy season.
27	Project proponent shall provide proper rasta of proper width and power strength for the project before the start of construction.	Appropriate road will be provided for construction materials and construction related vehicles in the project site as per approved layout.
28	The project proponent shall ensure that the U value of the glass is less than 3.177 and maximum solar heat gain co efficient is 0.25 for vertical fenestration.	Yes, PP will comply with said condition. Please refer to <b>Annexure-V</b> for details.
29	The project proponent shall adequately control construction dusts like silica dust, non silica dust, and wood dust. Such dust shall not spread outside project premises. Project proponent shall provide respiratory protective equipment to all construction workers.	To minimize the impact of the dust generated during construction activities the following measures will be adopted: <ul style="list-style-type: none"> <li>• All the loose material either stacked or transported shall be provided with suitable covering;</li> <li>• Water sprinkling shall be done at the location where dust generation is anticipated;</li> <li>• Proper masks shall be provided to workers who will be engaged in dust generation activity;</li> </ul>
30	The project proponent shall provide fire control room and fire officer for building above 30 meter as per National Building Code.	Yes, Project proponent shall take care of the said stipulated condition as per applicable and technically feasible for the project.
31	The project proponent shall obtain permission of Mines and Geology Department for excavation of soil before the start of construction.	Please refer to <b>Annexure-VI</b> for the approval from the Department of Mines & Geology, Gurgaon/ Mewat.
32	The project proponent shall provide refuge area till 24 meter, one till 39 meter and one after 15 meter each, as per National Building Code. The project proponent shall not convert any refuge area in the habitable space and it should not be sold out/commercialized.	Agreed, Will be complied as per National Building Code.
33	The project proponent shall seek specific prior approval from concerned local Authority/HUDA regarding provision of storm drainage and sewerage system including their integration with external services of HUDA/Local authorities	Yes, Project proponent shall take care of the said stipulated condition as per applicable and technically feasible for the project.

	besides other required services before taking up any construction activity.	
34	The project proponent shall discharge excess of treated waste water/storm water in the public drainage system and shall seek permission of HUDA before the start of construction.	<p>Treated waste water will be used for flushing, Horticulture and DG &amp; HVAC cooling purposes and excess water will be used for construction activity(after treatment so that it is fit for being used in construction activities and conforms to the Indian standard for Plain and Reinforced Concrete- Code of Practice (Fourth Revision)- IS 456:2000).</p> <p>Please find enclosed the assurance from HUDA for discharge of excess treated water for the project enclosed as <b>Annexure-VII</b></p>
35.	The project proponent shall ensure that structural stability to withstand earthquake of magnitude 8.5 on Richter scale.	The project is located in sector-69, Gurgaon The mandatory requirement of National Building Code and IS Code is being followed w.r.t. structure stability i.e. seismic zone-IV for buildings located in Gurgaon.
36	In view of the severe constrains in water supply augmentation in the region and sustainability of water resources, the developer will submit the NOC from CGWA specifying water extraction quantities and assurance from HUDA/utility provider indicating source of water supply and quantity of water with detail of intended use of water-potable and non potable. Assurance is required for both construction and operation stage separately. It shall be submitted to the SEIAA and RO, MoEF, Chandigarh before the start construction.	The proposed project site is located in the sector-69 of HUDA. As per their assurance letters they will provide water for our project in operation phase. Please find the assurance letter enclosed as <b>Annexure- VIII</b> . For carrying out the construction activities we will use STP treated water (after treatment so that it is fit for being used in construction activities and conforms to the Indian standard for Plain and Reinforced Concrete- Code of Practice (Fourth Revision)- IS 456:2000) at the project site. This STP treated water will be procured from our other operational projects as well as purchased from HUDA STP as per requirement.
37	Overexploited groundwater and impending severe shortage of water supply in the region requires the developer to redraw the water and energy conservation plan. Developer shall reduce the overall footprint of the proposed development. Project proponent shall incorporate water efficiency/saving measure as well as water reuse/recycling within 3 months and before start of construction to the SEIAA Haryana and RO, MoEF, GOI, Chandigarh.	<p>The planning of the project has been done keeping in mind the following measures for water efficiency/ saving savings measures as well as water reuse/recycling on the completion of the project:</p> <ul style="list-style-type: none"> <li>• Cisterns will be of 3-5 Lt. Capacity.</li> <li>• There will be use of ultra low flush toilets, low-flow showerheads of discharge 5 L/min. in place of 11 L/min.</li> </ul> <p>The treated water from STP shall be reused for flushing, cooling, gardening and construction purposes.</p>
38	Vertical Fenestration shall not exceed 40% of total wall area.	Will be complied as per National Building Code.

	Operational Phase	
a	"Consent to Operate" shall be obtained from Haryana State Pollution Control Board under Air and Water Act and copy shall be submitted to SEIAA, Haryana.	Yes, After the completion of the construction activities of the project PP will apply for the consent to operate from the Haryana State Pollution Control Board for the commissioning of the project.
b	The Sewage Treatment Plant (STP) shall be installed for the treatment of sewage to the prescribed standard including odour and treated effluent will be recycled to achieve to zero exit discharge. The installation of STP should be certified by an independent expert and report in this regard should be submitted to SEIAA, Haryana before the project is commissioned for operation. Tertiary treatment of waste water is mandatory. The project proponent shall remove not only Ortho-Phosphorous but total phosphorous to the extent of less than 2mg/liter Similarly total Nitrogen level shall be less than 2mg/liter in tertiary treated waste water. Discharge of treated sewage shall conform to the norms and standards CPCB/HSPCB, whichever is environmentally better. Project Proponent shall implement such STP technology which does not require filter backwash. The project proponent shall essentially provide two numbers of STPs preferably equivalent to 50% of total capacity or as per the initial occupancy as the case may be.	<p>The total water requirement is estimated as 1174 KLD. The fresh water requirement shall be 340 KLD. Total quantity of wastewater generation is likely to be 878 KLD. The generated sewage will be collected and treated in Sewage Treatment Plant of total capacity 1000 KLD (200 KLD, 300 KLD &amp; 500 KLD) capacity. Treated waste water will be used for flushing, Horticulture and misc purposes and excess water will be used for construction activity (after treatment so that it is fit for being used in construction activities and conforms to the Indian standard for Plain and Reinforced Concrete- Code of Practice (Fourth Revision)- IS 456:2000).</p> <p>The filter backwash water will again sent to the equalization tank for retreating and filter backwash will not be disposed in to the main Huda Drain.</p> <p>Discharge of treated sewage shall conform to the norms and standards CPCB/HSPCB</p> <p>After the installation of the STP we will submit structural &amp; operational design with tertiary treatment facility to your office certified through independent expert. The details of water balance diagram are enclosed herewith as <b>Annexure-IX</b></p>
c	Separation of grey and black water should be done by the use of dual plumbing line. Treatment of 100% grey water by decentralized treatment should be done ensuring that the re-circulated water should have BOD level less than 5 mg/litre and the recycled water will be used for flushing, gardening and DG set cooling etc.	PP will be providing Dual plumbing line system for separation of grey water and black water. All the waste water generated from the project will be further treated through the adequate capacity STP of SAFF technology and utilized for recirculation in flushing, gardening and cooling purpose. Discharge of treated sewage shall conform to the norms and standards CPCB/HSPCB
d	For disinfection of the treated waste water ultra violet radiation or ozonization process should be used.	For disinfection of the treated waste water ultra violet radiation or ozonization will be used as per requirement of the project.
e.	Diesel power generating sets proposed as source of back-up power for lifts, common area illumination and for domestic use should be enclosed type and conform to rules made under	DG sets proposed for the project will be installed in the basement of the project. All the D.G sets proposed for the project

	Environment (Protection) Act 1986. The location of the DG set shall be in basement as promised by the project proponent with appropriate stack height above the highest roof level of the project as per the CPCB norms. The diesel used for DG sets should be ultra low sulphur diesel (35 ppm) instead of low sulphur diesel.	will be acoustically enclosed or kept acoustically enclosed insulated rooms in basements and will be kept on solid ground as per the norms and will have appropriate stack height as per CPCB norms conform to rules made under Environment (Protection) Act 1986 . We have already received assurance from DHBVN for supply of 20844 KVA of power supply to the project. Please refer to <b>Annexure-II</b> .
f.	Ambient noise level should be controlled to ensure that it does not exceed the prescribed standards both within and at boundary of the Proposed Cyber Park.	All the D.G sets proposed for the project will be acoustically enclosed and will have appropriate stack height as per CPCB norms. However, adequate landscaping with broad canopy area will be provided at the peripheral area of the project for controlling unnecessary noise level in prescribed standard both within and at boundary of Project.
g	The project proponent should maintain at least 25.98% as green cover area for tree plantation especially all around the periphery of the project and on the road sides preferably with local species which can provide protection against noise and suspended particulate matter. The open spaces inside the project should be preferably landscaped and covered with vegetation/grass, herbs & shrubs. Only locally available plant species should be used.	Yes, the green cover area for tree plantation especially all around the periphery of the project and on the road side will be developed as per our submitted Landscape plan to committee. Where we are proposing <b>25.98%</b> of total plot area for the green The open space inside the project will be preferably landscape and covered with vegetation/grass, herbs & shrubs
h	The project proponent shall strive to minimize water in irrigation of landscape by minimizing grass area, using native variety, xeriscaping and mulching, utilizing efficient irrigation system, scheduling irrigation only after checking evapotranspiration data.	Unit will be providing adequate landscaping and minimizing water in irrigation through for utilizing efficient irrigation system scheduling.
i	Rain water harvesting for roof runoff and surface runoff, as per plan submitted should be implemented. Before recharging the surface run off, pre treatment through sedimentation tanks must be done to remove suspended matter, oil & grease. The bore well for rain water recharging shall be kept at least 5 mtrs above the highest ground water table. Care shall be taken that contamination water do not enter any RWH pit. The project proponent shall avoid rain water harvesting of first 10 min of rain fall. Roof top of the building shall be without any toxic material or paint which can contamination rain water. Wire mess and filter should be used wherever required.	Yes, <b>15 Nos</b> of rain water harvesting pits are proposed for the project. A design detail of rain water harvesting pits is enclosed herewith as <b>Annexure-IV</b> for your ready reference.
j	The ground water level and quality should be monitored regularly in consultation with Central Ground Water Authority.	Yes, we will take care of the said stipulated condition for the project.

k	A report on the energy conservation measures conforming to energy conservation norms finalized by Bureau of Energy efficiency should be prepared incorporating detail about building material & technology, R & U factor etc and submitted to SEIAA, Haryana in three months time.	PP will take care of Energy conservation measures through ECBC .Building material proposed with R & U values and quantification of energy saved and energy conservation measures is enclosed herewith as <b>Annexure-V</b> .
l	Energy conservation measure like installation of LED only for lighting the areas outside the building should be integral part of the project design and should be in place before project commissioning. Use of solar panels must be adapted to maximum energy conservation.	Energy conservation measure like installation of LED for lighting will be done. The building will be provided as an integral part of the project design and Dual Lighting system will be provided in common areas.
m	The project proponent shall use zero ozone depleting potential material in insulation, refrigeration, air conditioning and adhesive. Project proponent shall also provide halon free fire suppression system.	Yes, PP will adhere to the said condition as far as applicable and technically feasible for the project.
n	The solid waste generated should be properly collected and segregated as per the requirement of the MSW Rules, 2000 and as amended from time to time. The biodegradable waste should be treated by appropriate technology (proposed OWC) at site ear marked within the project area and dry /inert solid waste should be disposed off to the approved site for land filling after recovering recyclable material.	The solid waste generated will be managed as per per the requirement of the MSW Rules, 2000 and as amended from time to time. Please refer <b>Annexure-X</b> for details of proposed management of solid waste.
o	The provision of solar water heating system shall be as per norms specified by HAREDA and shall be made operational in each building block.	Since the project is a Cyber Park, the hot water requirement will be approximately nil.
p	The traffic plan and parking plan proposed by the project proponent should be meticulously adhered to with further scope of additional parking for future requirement. There should be no traffic congestion near the entry and exit points from the roads adjoining the proposed project site. Parking should be fully internalized and no public space should be used.	Proper traffic circulation with separate entry and exits will be provided at the project site to avoid the traffic conjunction. As per our submitted plan total parking proposed to be provided for the project is <b>4191 ECS</b> . Details are enclosed as <b>Annexure-XI</b> .
q	Project shall be operationalized only when HUDA/public authority will provide domestic water supply system in the area.	PP has already obtained the assurance letter from HUDA for domestic water supply for the operational phase of the project. Details are enclosed as <b>Annexure-VIII</b> .
r	Operation and maintenance of STP, solid waste management and electrical infrastructure. Pollution control measure shall be ensured even after the completion of project.	Yes, PP will take care of the said stipulated condition of the environment clearance letter. Due care will be taken for the operation and maintenance of STP, solid waste management, electrical infrastructure and pollution control measure even after the completion of project.
s	Different type of wastes should be disposed off as per provisions of municipal solid waste, biomedical waste, hazardous waste, e-waste, batteries & plastic rules made under Environment Protection Act 1986. Particularly E-waste and	The solid waste generated will be managed as per per the requirement of the MSW Rules, 2000 and as amended from time to time. Please refer <b>Annexure-X</b> for details of proposed management of solid

	batteries waste shall be disposed of as per existing E-waste Management Rules 2011 and Batteries Management Rules 2001. The project proponent should maintain a collection centre for E-waste and it should be disposed of to only register authorized dismantler as per existing E-waste Management Rules 2011.	waste. E-waste shall be generated periodically due to different activities lessee/ rented companies at the project after the project is operational. The E-waste generated by the different companies shall be managed by them as per the prevailing guidelines. The companies will tie-up with the authorized recyclers/ reproducers of E-waste by MoEF&CC/CPCB/HSPCB for management of E-Waste.
t	Standard of discharge of environmental pollution as enshrined in various schedule of rule 3 of Environment Protection Rule 1986 shall be strictly complied with.	All adequate controlling measures will be proposed for discharge of environmental pollution as enshrined in various schedule of rule 3 of environment protection act 1986 as far as applicable and technically feasible of compliance.
u	The project proponent shall make provision for guard pond and other provisions for safety against failure in the operation of wastewater treatment facilities. The project proponent shall also identify acceptable outfall for treated effluent.	In case of emergency situation of failure in operation of STP the project's sewerage line will be connected to HUDA Sewer line. HUDA has a common STP and the project sewage will be discharged in HUDA sewage line on payment.
v	The project proponent shall ensure that the stack height of DG sets is as per the CPCB guide lines and also ensure that the emission standard of noise and air are within the CPCB prescribed limits. Noise and emission level of DG sets greater than 800 KVA shall be as per CPCB latest standard for high capacity DG sets.	Will be complied.
w	All electric supply exceeding 100 amps, 3 phases shall maintain the power factor between 0.98 lag to 1 at the point of connection.	Unit will be providing highly efficient DG set for power back which providing 0.98 lag to 1 at point of connection with 0.85 lag of alternator for electrical supply exceeding 100 amps, 3 phases.
x	The project proponent shall minimize heat island effect through shading and reflective or pervious surface instead of hard surface.	Will be complied with as per technical feasibility for the said project.
y	The project proponent shall not use fresh water for HVAC and DG cooling, Air based HVAC system should be adopted and only treated water shall be used by project proponent for cooling, if it is all needed. The project proponent shall also use evaporation cooling technology and double state cooling system for HVAC in order to reduce water consumption. Further temperature relative humidity during summer and winter season should be kept at optimal level. Variable speed drive, best co efficient of performance (CoP) as well as optimal Integrated Point Load Value and minimum outside fresh air supply may be resorted for conservation of power and water. Coli type cooling DG sets shall be used for saving cooling water consumption for water cooled DG sets.	Treated water from STP shall be utilized for HVAC & DG cooling. As we will not be using freshwater and the project will have adequate quantity of treated water for cooling purpose coil cooling system for DG sets will not be required. The project is construction of a Cyber Park and will comprise of offices. The double state cooling system for HVAC is required in areas where low temperature is to be maintained. As stated above, the project will comprise of mainly offices, the single state cooling system for HVAC will be sufficient to attain the required comfort level.

Z	The project proponent shall ensure that the transformer is constructed with high quality grain oriented, low loss silicon steel and virgin electrolyte grade copper. The project proponent shall obtain manufacturer's certificate also for that.	Before purchasing of transformer from the manufacture manufacturer's certificate will be obtain to ensure that the transformer is constructed with high quality grain oriented, low loss silicon steel and virgin electrolyte grade copper.
aa	Water supply shall be metered among different users and different utilities	Will be complied.
ab	The project proponent shall ensure that exit velocity from the stack should be sufficiently high. Stack shall be designed in such a way that there is no stack down water under any meteorological conditions.	Will be complied.
ac	The project proponent shall provide water sprinkling system in the project area to suppress the dust in addition to the already suggested mitigation measures in Air Environment Chapter of EMP	The open area inside the project will be suitably landscaped hence minimizing the probability of dust generation. If required water sprinkling will be done via water tanker as per requirement.
ad	The project proponent shall provide additional green area on terrace and roof top	As per our plan submitted to SEIAA we will be providing 25.98% of project area as green area.
ae	The project proponent shall ensure proper Air Ventilation and light system in the basements area for comfortable living of human being and shall ensure that number of Air Changes per Hour (ACH) in basement never falls below 15. In case of emergency capacity for increasing ACH to the extent of 30 must be provided by the project proponent.	PP will ensure proper Air Ventilation and light system in the basements area for comfortable living of human being. The provisions of NBC in this regard will be complied with. As per latest NBC amendment 12 of Air Changes per Hour (ACH) in basement are required. Please refer Annexure-XII for the said NBC amendment.
af	The project proponent shall install solar panel for energy conservation.	Solar panels will be provided for energy conservation.
<b>General Conditions</b>		
i	The project proponent shall ensure that commitments made in Form-1, Form-1A, EIA/EMP and other documents submitted to the SEIAA for the protection of environment and proposed environmental safeguard are complied within letter and spirit. In case of contradiction between two or more documents on any point, the most environmentally friendly commitment on the point shall be taken as commitment by project proponent.	The Environmental safeguards contained in Form-1, /Form-1A, EMP and environmental clearance letter will be implemented in true spirit.
ii	The Project Proponent shall also submit six monthly reports on the status of compliance of the stipulated EC condition including result of monitored data (both in hard copies as well as by email) to the northern regional office of MoEF, HSPCB and SEIAA Haryana.	Yes, PP is committed to comply with the said stipulated condition for project and regularly submit the six monthly compliance report of the project along with the Environmental Monitoring report carried out by MoEF&CC approved Lab to HSPCB and Regional Office, MoEF&CC, GOI, Northern Region, Chandigarh and SEIAA, Haryana.
iii	STP outlet after stabilization and stack emission shall be monitored monthly. Other environmental parameters and green belt shall be monitored on	As per MoEF& CC EIA Guidelines Six monthly EC compliance report will be submitted along with environmental

	<p>quarterly basis. After every 3 (three) months the project proponent shall conduct environmental audit and shall take corrective measure, if required, without delay.</p>	<p>monitoring report of STP, Noise, Ambient Air &amp; Stack to the HSPCB and Regional office, MoEF&amp;CC, GOI, Northern Region, Chandigarh and SEIAA, Haryana.</p> <p>The Maintenance team will take care of smooth functioning of the STP and D.G. sets via AMC with competent company/ vendor/ expert. They will monitor their relevant parameters of STP &amp; D.G. sets on daily basis via online or manual system. All the D.G. sets will be provided with acoustic enclosure and adequate stack height as per CPCB norms. So the probability of air &amp; noise emissions is low.</p> <p>Periodic maintenance work of STP &amp; D.G. sets will be carried out for ensuring the smooth &amp; proper functioning of STP &amp; D.G. sets.</p>
iv	<p>The SEIAA, Haryana reserves the right to add additional safeguard measures subsequently, if found necessary. Environmental Clearance granted will be revoked if it is found that false information has been given for getting approval of this project. SEIAA reserves the right to revoke the clearance if conditions stipulated are not implemented to the satisfaction of SEIAA/MoEF.</p>	<p>PP will abide by the additional safeguards if suggested by the Ministry in future as applicable and technically feasible of compliance.</p>
v	<p>The project proponent shall be not violating any judicial orders/ pronouncements issued by any Court/Tribunal.</p>	<p>PP shall comply with the said condition for the project.</p>
vi	<p>All other statutory clearances such as the approvals for storage of diesel from Chief Controller of Explosives, Fire Department, Civil Aviation Department, Forest Conservation Act, 1980 and Wildlife (Protection) Act, 1972. Forest Act, 1927, PLPA 1900, etc shall be obtained as applicable by project proponent from the respective authorities prior to construction of the project.</p>	<p>All other statutory clearances such as the approvals from:</p> <ul style="list-style-type: none"> <li>• Chief Controller of Explosives: will be obtained in time.</li> <li>• Fire Department: will be obtained in time</li> <li>• PLPA, 1900, Forest Act, 1927: enclosed as <b>Enclosure-I</b></li> <li>• Civil Aviation: enclosed as <b>Annexure XIII</b></li> <li>• Forest Conservation Act: N/A</li> <li>Wildlife Act : N/A</li> </ul>
vii	<p>The project proponent should inform the public that the project has been accorded Environment Clearance by the SEIAA and copies of the clearance letter are available with the Haryana State Pollution Control Board &amp; SEIAA. This should be advertised within 7 days from the date circulated in the region and the copy of the same should be forwarded to SEIAA Haryana. A copy of Environment clearance conditions shall also be put on project proponent's web site for public awareness.</p>	<p>Received the <b>EC letter vide letter no. SEIAA/HR/2016/330 dated 04.05.2016 received on 10.05.2016</b> and in compliance with the said condition PP duly published an advertisement in <b>THE TIMES OF INDIA NEW DELHI /GURGAON) and NAVBHARAT TIMES (Hindi)</b> informing the public about the grant of EC for our project. Copies of the advertisement are enclosed as <b>Annexure-XIV</b> for your reference. Apart from this PP has also uploaded the EC accorded for the project on the</p>

		<p>company's official website: <a href="http://www.unitechgroup.com">www.unitechgroup.com</a> for public awareness.</p> <p>Also PP has submitted the above said advertisements to SEIAA, Haryana vide letter no. <b>UL/Advertisement/SEIAA-15-CP /1606/2016</b> dated <b>16.06.2016</b>. Please refer <b>Annexure-XIV</b> for the said letter.</p>
viii	Under the Provision of Environment (Protection) Act, 1986, legal action shall be initiated against the project proponent if it was found that construction of the expansion project has been started before obtaining prior Environmental Clearance.	PP has already obtained Environmental Clearance vide letter no <b>EC letter vide letter no. SEIAA/HR/2016/330</b> dated <b>04.05.2016</b> received on <b>10.05.2016</b>
ix	Any appeal against the Environmental Clearance shall lie with the National Green Tribunal. if preferred, within a period of 30 days as prescribed under Section 16 of the National Green Tribunal Act, 2010.	PP is committed to comply with all the directions/Rules/Instructions issued time to time by the Board as applicable and technically feasible of the project.
x	Corporate Environment and Social Responsibility (CSER) shall be laid down by the project proponent (2% shall be earmarked) as per guidelines of MoEF, GOI, OM 1-11013/41/2006-IA II (I) dated 18.05.2012 and Ministry of Corporate Affairs, GOI Notification Dated 27.02.2014. A separate audit statement shall be submitted in the compliance. Environment related work proposed to be executed under this responsibility shall be undertaken simultaneously. The project proponent shall select and prepare list of the work for implementation of CSER of its own choice and shall submit the same before the start of construction.	Environment Management Plan & Corporate Social Responsibility cost details are enclosed as <b>Enclosure-III</b> . The environmental policy has been enclosed as <b>Annexure-XV</b> .
xi	The fund ear-marked for environmental protection measures should be kept in separate account and should not be diverted for other purposes and year wise expenditure shall be reported to the SEIAA/RO MoEF, GOI under rules prescribed for Environment Audit.	The Environment Management Plan cost details proposed for the project is enclosed herewith as <b>Enclosure-III</b> .
xii	The project proponent shall ensure the compliance of Forest Department, Haryana Notification no S.O. 121/PA2/1900/S.4/97 dated 28.11.1997.	Our project is 15 acre "Cyber Park" Project does not fall in Aravali. In this regards, we have already obtained the NOC from concerned Deputy commissioner, stating that the project area does not fall under reserved forest/protected forest and Section 4 & 5 of PLPA, 1900. The details are enclosed herewith as <b>Enclosure-I</b> for your ready reference.
xiii	The Project proponent shall ensure that no vehicle during construction/operation phase enters the project premises without valid "Pollution Under Control" certificate from competent Authority.	PP will take care of the said stipulated condition. Vehicles will not be allowed during construction/operational phase both without the "Pollution Under Control" certificate from the competent authority.

xiv	Besides the developer/applicant the responsibility to ensure the compliance of Environmental safeguards/conditions imposed in the Environmental clearance letter shall also lie on the license/licenses in whose name/names the license/CLU has been granted by the Town & Country Planning Department Haryana.	The project site is earmarked for development of Cyber Park (residential) as per Master plan of Gurgaon Manesar Urban Complex 2031 and as per the license granted by DTCP, Haryana already the license has been obtained vide License No. 29 of 2009 dated 24/06/2009. Renewed license is valid upto 23-06-2017. Copy of License enclosed as <b>Enclosure-II</b>
xv	The proponent shall upload the status of compliance of the stipulated EC conditions including results of monitored data on their website and shall update the same periodically. It shall simultaneously be sent to the Regional Office of MoEF, the respective Zonal office of CPCB, and the SPCB. The criteria pollutant levels namely; SPM, RSPM, SOx, Nox, Ozone, Lead, CO, Benzene, Ammonia, Benzopyrine, arsenic and Nickel (ambient levels as well as stack emissions) or critical sectoral parameters indicated for the project shall be monitored and displayed at a convenient location near the main gate of the company in the public domain.	Yes, PP will take care of the said stipulated conditions as applicable and technically feasible of the project.
xvi	The Environmental Statement for each financial year ending 31st March in form-V as is mandated to be submitted by the project proponent to the HSPCB Panchkula as prescribed under the Environment (Protection) Rules, 1986, as amended subsequently shall also put on website of the company along with the status of compliance of the EC conditions and shall also be sent to the respective Regional Offices of MoEF by email.	Agreed, we will take care of the said stipulated conditions as applicable and technically feasible of the project. After the completion of construction activities of the project we will obtain the Consent To Operate from HSPCB for the project. Accordingly we will start submitting the Environmental statement as Form -V and submit the same to your office.
xvii	The project proponent shall conduct environment audit at every three months interval and thereafter corrected measures shall be taken without any delay. Details of environmental audit and corrective measures shall be submitted in the monitoring report.	Yes, PP will take care of the said stipulated conditions as applicable and technically feasible of the project.
xviii	The project proponent shall seek fresh Environmental clearance in case any modification/revision is required at a later stage due to exchange of revenue rasta existing in the project area or change in any plan due to combined zoning plan.	Yes, we will take care of the said stipulated condition for the project. The project development will be carried out as per the project configuration submitted for the Environmental clearance of the project.

# Enclosure I

प्रेषक

उपायुक्त, गुडगांव।

सेवा में

**M/s Unitech Limited**

क्रमांक 3905 /एस0के02 दिनांक 24-12-13

**विषय: Request for issuing Aravali Notification 1992 & PLPA 1900 from DFO and Tehsildar through Deputy Commissioner of Gurgaon of our project at village Fazilpur Jharsa & Badshahpur, Sector-69, Gurgaon.**

यादि

उपरोक्त विषय पर आपके प्रार्थना पत्र के सन्दर्भ में।

विषयाधीन मामले में इस कार्यालय द्वारा तहसीलदार गुडगांव व उप-वन संरक्षक गुडगांव से रिपोर्ट प्राप्त की गई जो निम्न प्रकार है :-

तहसीलदार गुडगांव के कार्यालय के पत्र क्रमांक 1233/ओ.के. दिनांक 10.12.2013 द्वारा प्राप्त रिपोर्ट अनुसार अराजी मुश्तकिल नं० 51 किला नं० 1/2, 2/2, 9/1, 10/1, 10/2, 11/1, 11/2, 19/2, 20, 21, 22 मुश्तकिल नं० 52 किला नं० 6/1 मीन, 6/2 मीन, 6/3 मीन, 15/1 मीन, 15/2, 16 कुल रकबा 58 कनाल 5 मरला मौजा फाजिलपुर झाड़सा व मुश्तकिल नं० 42 किला नं० 1 मीन, 2 मीन, 9, 10, 11, 12, 19, 22, मुश्तकिल नं० 43 किला नं० 6, 15 मुश्तकिल नं० 65 किला नं० 2, 3 मीन कुल रकबा 61 कनाल 15 मरला मौजा बादशाहपुर अरावली क्षेत्र में नहीं आती है। उपरोक्त भूमि पर अरावली की नोटिफिकेशन का कोई इन्द्राज नहीं है। वर्ष 1992 से पूर्व उपरोक्त भूमि कि किस्म चाही व इसके बाद खाली है।

उप-वन संरक्षक गुडगांव के कार्यालय के पत्र क्रमांक 3061-G दिनांक 11.12.2013 द्वारा इस कार्यालय में रिपोर्ट अनुसार M/s Unitech Limited, vide letter No. Nil dated 25.03.2013 made a request in connection with land measuring 7.28125 having Rect. No 51 Killa No. 1/2, 2/2, 9/1, 10/1, 10/2, 11/1, 11/2, 19/2, 20, 21, 22 Rect. No. 52 Killa No. 6/1 min, 6/2 min, 6/3 min, 15/1 min, 15/2, 16, land located at village Fazilpur Jharsa, and land measuring 7.7187 Acres having Rect. No. 42 Killa No. 1 min, 2 min, 9, 10, 11, 12, 19, 22, Rect. No. 43 Killa No. 6, 15 Rect. No. 65 Killa No. 2, 3 min land located at village Badshahpur 7.719 Acres (Total land measuring 15.00 Acres) District Gurgaon. Applicant made a proposal to use this land for Development of Cyber Park/IT Park Project Purpose. In continuation of report submitted by RFO, Sohna vide letter no. 349-S dated 17.10.2013. It is made clear that:

- A As per records available above said land is not part of notified Reserved Forest, Protected Forest under Indian Forest Act, 1927 or any area closed under section 4 & 5 of Punjab Land Preservation Act, 1900.
- B It is clarified that by the Notification No. S.O.8/PA. 2/1900/S.4/2013 dated 4<sup>th</sup> January 2013, all revenue estate of Gurgaon Tehsil is notified u/s 4 of PLPA 1900 and S.O. 81/PA.2/1900/S.3/12 dated 19<sup>th</sup> December, 2012 u/s 3 of PLPA 1900. The area is however not recorded as forest in the Government record but felling of any tree is strictly prohibited without the permission of Divisional Forest Officer, Gurgaon.

- C If approach is required from Protected Forest by the user agency, the clearance/regularization under Forest Conservation Act 1980 will be required without prior clearance from Forest Department, the use of Forest land for approach road is strictly prohibited M/s Unitech Limited whose land is located at village Fazilpur Jharsa & Badshahpur District Gurgaon must obtain clearance as applicable under Forest Conservation Act 1980.
- D As per records available with forest Department, Gurgaon, the area does not fall in areas where plantations were raised by the Forest Department under Aravalli project.
- E All other statutory clearance mandated under the Environment Protection Act. 1986 or any other Act/order shall be obtained as application by the project proponents from the concerned authorities.
- F The project proponent will not violate any judicial orders/Pronouncement issued by the Hon'ble Supreme Court/High Courts.
- G It is clarified that the Hon'ble supreme Court has issued various judgment dated 07.05.2002, 29.20.2002, 16.12.2002, 18.03.2004 etc. pertaining to Aravalli region in Haryana, Which should be compiled with.
- H It shall be the responsibility of user agency/applicant to get necessary clearances/permissions under various Acts and Rules applicable if any, from the respective authorities/Department.

रिपोर्ट सेवा में प्रेषित है।

  
कृते: उपायुक्त, गुडगांव।

कमांक

/एस0के02 दिनांक

इसकी एक प्रति Director General, Town & Country Planning, Haryana, Chandigarh को सूचनार्थ एवं आवश्यक कार्यवाही हेतु प्रेषित है।

  
कृते: उपायुक्त, गुडगांव।

Annexure-V

From: Dy. Conservator of Forests,  
Gurgaon, Haryana.

To, **M/s Unitech Limited,**  
**Unitech House, L-Block,**  
**South City-I, Gurgaon-122001**

No.: 3060-6

Date: 11/12/13

Sub.: Clarification regarding Applicability of forest laws on Non Forest land Applied **M/s Unitech Limited** land located at Village- **Fazilpur Jharsa & Badshahpur**, District-Gurgaon.

Applicant **M/s Unitech Limited, Unitech House, L-Block, South City-I, Gurgaon** vide letter no. Nil dated 25.03.2013 made a request in connection with land measuring **7.28125 Acres** having Rect. No. 51 Killa No. 1/2, 2/2, 9/1, 10/1, 10/2, 11/1, 11/2, 19/2, 20, 21, 22, Rect. No. 52 Killa No. 6/1min, 6/2min, 6/3min, 15/1min, 15/2, 16, land located at village **Fazilpur Jharsa**, and land measuring **7.7187 Acres** having Rect. No. 42 Killa No. 1min, 2min, 9, 10, 11, 12, 19, 22 Rect. No. 43 Killa No. 6, 15 Rect. No. 65 Killa No. 2, 3min land located at Village **Badshahpur** (Total land measuring **15.00 Acres**) District Gurgaon. Applicant made a proposal to use this land for **Development of Cyber park/IT Park Project Purpose**. In continuation of report submitted by RFO, **Sohna** vide Letter No. **349-S** dated 17.10.2013 it is made clear that:

- As per records available above said land is not part of notified Reserved Forest, Protected Forest under Indian Forest Act, 1927 or any area closed under section 4 & 5 of Punjab Land Preservation Act, 1900.
- It is clarified that by the Notification No. S.O.8/P.A 2/1900/S.4/2013 dated 4th January, 2013, entire Revenue Estate of Gurgaon is notified u/s 4 of PLPA 1900 and S.O.81/PA.2/1900/S.3/2012 dated 19th December, 2012 u/s 3 of PLPA 1900. The area is however not recorded as forest in the Government record but felling of any tree is strictly prohibited without the permission of Divisional Forest Officer, Gurgaon.
- If approach is required from Protected Forest by the user agency, the clearance/regularization under Forest Conservation Act 1980 will be required. Without prior clearance from Forest Department, the use of Forest land for approach road is strictly prohibited. **M/s Unitech Limited** whose land is located at village **Fazilpur Jharsa & Badshahpur** District Gurgaon must obtain clearance as applicable under Forest Conservation Act 1980.
- As per the records available with the Forest Department, Gurgaon, the area does not fall in areas where plantations were raised by the Forest Department under Aravalli project.
- All other statutory clearances mandated under the Environment Protection Act, 1986, as per the notification of Ministry of Environment and Forests, Government of India, dated 07-05-1992 or any other Act/order shall be obtained as applicable by the project proponents from the concerned authorities.
- The project proponent will not violate any Judicial Order/ direction issued by the Hon'ble Supreme Court/ High Courts.
- It is clarified that the Hon'ble Supreme Court has issued various judgments dated 07.05.2002, 29.10.2002, 16.12.2002, 18.03.2004, 14.5.2008 etc. pertaining to Aravalli region in Haryana, which should be complied with.
- It shall be the responsibility of user agency/applicant to get necessary clearances/permissions under various Acts and Rules applicable if any, from the respective authorities/Department.

Date:  
Place. **Gurgaon.**

  
**Dy. Conservator of Forest,**  
**Gurgaon.**

Endst.No.

Dated:

A copy is forwarded to:-

1. Conservator of Forests, South Circle, Gurgaon for kind information,
2. D.G, T.C.P, Ayojana Bhawan, Sec-18, Madhya Marg, Chandigarh for kind information,
3. Dy. Commissioner, Gurgaon for kind information.
4. Guard File.

  
**Dy. Conservator of Forest,**  
**Gurgaon.**

# Enclosure II

**FORM LC-V**  
**(See Rule-12)**  
**Haryana Government**  
**Town and Country Planning Department**

Licence No. --29--of 2009

1. This licence has been granted under The Haryana Development and Regulation of Urban Areas Act, 1975 and Rules made there under to M/s Landscape Builders Ltd., M/s Zanskar Builders Pvt. Ltd., M/s Zanskar Realtors Pvt. Ltd., M/s Somerville Developers Ltd, M/s Sublime Properties Pvt. Ltd., and M/s Unising Projects Pvt. Ltd. C/o M/s Unitech Ltd, Unitech House, L-Block, South City-I, for setting up of a Cyber Park at Village Fazilpur Jharsa and Bhadshahpur in Sector -69 of Gurgaon Manesar Urban Complex.
2. The particulars of land wherein the aforesaid Cyber Park is to be set up are given in the schedule annexed hereto and duly signed by the Director, Town and Country Planning, Haryana.
3. The licence is granted subject to the following conditions:-
  - a) That the Cyber Park is laid out to conform to the approved layout plan and the development works are executed according to the designs and specifications shown in the approved plan.
  - b) That the conditions of the agreements already executed are duly fulfilled and the provisions of Haryana Development and Regulation of Urban Areas Act, 1975 and Rules, 1976 made thereunder are duly complied with.
  - c) That the demarcation plan of the Cyber Park area is submitted before starting the development works in the colony and for approval of the zoning plan.
4. That you shall construct the portion of 12 mtr wide service road/24 mtr wide internal circulation road forming part of licenced area at his own cost and will transfer the same free of cost to the Government.
5. That you shall derive permanent approach from the service road only.
6. That you will not give any advertisement for sale of Cyber Park area, shops/office/floor area before the approval of layout plan/building plans.
7. That the portion of sector/Master plan road which shall form part of the licenced area shall be transferred free of cost to the Government in accordance with the provisions of Section 3(3)(a)(iii) of the Haryana Development and Regulation of Urban Areas Act, 1975.
8. That you shall obtain approval/NOC from the competent authority to fulfill the requirements of notification dated 14.09.2006 issued by the Ministry of Environment & Forests, Govt. of India before starting the development works in the colony.
9. That the licensee shall make arrangement for water supply, sewerage, drainage etc to the satisfaction of DTCP till the services are made available from external infrastructure to be laid by HUDA.
10. That you will use only CFL fittings for internal lighting as well as for campus lighting in the complex.
11. That you shall convey "Ultimate Power Load Requirement" of the project to the concerned power utility, with a copy to the Director, with in two month period from the date of grant of licence to enable provision of site in your land for Transformers/Switching Station/ Electric Sub-Stations as per the norms prescribed by the power utility in the zoning plan of the project.
12. The licence is valid upto 23-6-2012  
Dated: Chandigarh  
The 24-6-2009

  
(T.C. Gupta)

Director  
Town and Country Planning,  
Haryana, Chandigarh.

Endst No. LC-1661 PA (SA)-2009/ 60 / 4

Dated:- 25-6-09

A copy is forwarded to the following for information and necessary action:-

1. M/s Land Scape Builders Ltd., M/s Zanskar Builders Pvt. Ltd., M/s Zanskar Realtors Pvt. Ltd., M/s Sublime Properties Pvt. Ltd., M/s Somerville Developers Ltd and M/s Unising Projects Pvt. Ltd. C/o M/s Unitech Ltd, Unitech House, L-Block, South City-I, along with copies of agreement, LC-IV and Bilateral.
2. Chairman, Pollution Control Board, Haryana, Sector-6, Panchkula.
3. Chief Administrator, HUDA, Panchkula.
4. Managing Director, HVPN, Planning Directorate, Shakti Bhawan, Setor-6, Panchkula.
5. Joint Director, Environment Haryana -Cum-Secretary, SEAC, SCO No. 1-3, Sector -17D Chandigarh.
6. Addl. Director Urban Estates, Haryana, Panchkula.
7. Administrator, HUDA, Gurgaon.
8. Chief Engineer, HUDA, Panchkula.
9. Superintending Engineer, HUDA, Gurgaon along with a copy of agreement.
10. Land Acquisition Officer, Gurgaon.
11. Senior Town Planner, Gurgaon. He will ensure that the colonizer shall obtain approval/NOC as per condition No. 8 above before starting the Development Works.
12. Senior Town Planner (Enforcement), Haryana, Chandigarh.
13. Senior Town Planner (Monitoring Cell) Haryana, Chandigarh.
14. District Town Planner, Gurgaon along with a copy of agreement.
15. Accounts Officer, O/o Director, Town & Country Planning, Haryana, Chandigarh along with a copy of agreement.

  
Devendra Nimbokar

District Town Planner (HQ),  
For Director, Town and Country Planning,  
Haryana, Chandigarh.

TO BE READ WITH LICENCE NO 29 OF 2009

1. Detail of land owned by M/s Landscape Builders Ltd. , Village Fazilpur

Jharsa , Sector -69, District Gurgaon

Village	Rect. No.	Killa No.	Area (K-M)
Fazilpur Jharsa	51	11/2	1-16
		19/2	3-0
		20	8-0
		21	8-0
		22	3-14
		Total	24-10 Or 3.062 Acres

2. Detail of land owned by M/s Zanskar Builders Pvt. Ltd., Village Fazilpur

Jharsa , Sector -69, District Gurgaon

Village	Rect. No.	Killa No.	Area (K-M)
Fazilpur Jharsa	51	9/1	4-4
		Total	4-4 Or 0.525 Acres

3. Detail of land owned by M/s Zanskar Realtors Pvt. Ltd., Village Fazilpur

Jharsa , Sector -69, District Gurgaon

Village	Rect. No.	Killa No.	Area (K-M)
Fazilpur Jharsa	51	1/2	1-11
		10/1	4-18
		10/2	3-2
		2/2	0-5
		11/1	6-4
		Total	16-0 Or 2.0 Acres

4. Detail of land owned by M/s Somerville Developers Ltd., Village Fazilpur

Jharsa , Sector -69, District Gurgaon.

Village	Rect. No.	Killa No.	Area (K-M)
Fazilpur Jharsa	52	15/2	0-18
		16	3-17
		Total	4-15 Or 0.593 Acres

D.T.C.P. Hr.

*Patel*

5. Detail of land owned by M/s Sublime Properties Pvt. Ltd., Village Fazilpur  
Jharsa , Sector -69, District Gurgaon.

Village	Rect. No.	Killa No.	Area (K-M)
Fazilpur Jharsa	52	6/1	0-11
		6/2	2-11
		6/3	1-14
		15/1	4-0
		Total	8-16 Or 1.10 Acres

6. Detail of land owned by M/s Unising Projects Pvt. Ltd., Village Badshahpur,  
Sector -69, District Gurgaon.

Village	Rect. No.	Killa No.	Area (K-M)
Badshahpur	42	1 min	1-3
		2 min	1-7
		9	8-0
		10	7-18
		11	6-13
	43	12	8-0
		6	1-1
		15	3-7
	42	19	8-0
		22	8-0
	65	2	8-0
		3 min	0-6
		Total	61-15 Or 7.719 Acres
Grand Total			120- 0 Or 15.0 acres

Director  
Town & Country Planning,  
Haryana, Chandigarh  
*Patelwari*

**Directorate of Town & Country Planning, Haryana**

SCO-71-75, 2<sup>nd</sup> Floor, Sector 17 C, Chandigarh  
Phone: 0172-2549349 e-mail:tcphry@gmail.com  
website:-http://tcpharyana.gov.in

To

✓ Landscape Builders Ltd.  
Zanskar Builders Pvt. Ltd.  
Zanskar Realtors Pvt. Ltd.  
Somerville Developers Pvt. Ltd.  
Sublime Properties Pvt. Ltd.  
Unising Projects Pvt. Ltd.  
C/o Unitech Ltd.  
Unitech House, Block L, South city,  
Gurgaon-122001.

Memo No. LC-1661-JE (VA)-2015/ 13230

Dated 21/7/15

Subject: - **Renewal of licence no. 29 of 2009 dated 24.06.2009.**

Ref. Your letter dated 21.03.2014 & 05.05.2015 above.

1. Licence no. 29 of 2009 dated 24.06.2009 granted to you vide this office Endst No. LC-1661-PA (SA)-2009/6014-28 dated 25.06.2009 for setting up of IT Park at village Fazilpur Jharsa & Badshapur falling in Sector 69, Gurgaon Manesar Urban Complex is hereby renewed upto **23.06.2017** after deleting the clause 3 (e) and after adding the new clauses as per details given below :
  - a) That you shall complete atleast 60% of the permitted FAR as covered on all floor and obtain occupation certificate within a period of four years from issuance of instructions dated 05.11.2013 and also apply for grant of completion certificate under Rule 16, failing which the license shall be considered to have lapsed.
  - b) Your further request for renewal of licence shall be considered for the period of two years beyond the above mentioned four years license validity period if the undersign is satisfied that the execution of the project has been satisfactory and the delay has been caused on account of reasons beyond the control of the licensee.
  - c) The renewal of license beyond the said two year period shall not be considered and the licence shall be considered as lapsed in case the colonizer fails to complete the project and to apply for grant of completion certificate within the overall period of six years.
2. This renewal will not tantamount to certification of your satisfactory performance entitling you for further renewal of licence.
3. That you shall transfer portion of service road forming part of the licenced area to the Government free of cost within the validity period of license.
4. That you shall submit the revalidated Bank Guarantee on account of IDW one month before expiry of renewal of licence.
5. Licence no. 29 of 2009 dated 24.06.2009 is also returned herewith in original.

  
**ARUN KUMAR GUPTA**  
Director General, Town & Country Planning  
Haryana Chandigarh

# LOCATION ON MASTER PLAN

## GURGAON - MANESAR URBAN COMPLEX - 2031 AD

FINAL DEVELOPMENT PLAN FOR CONTROLLED AREAS  
DENOTED ON DRG NO.-D.T.P.(G)1836 DATED 16.04.2010  
UNDER SECTION 5 (7) OF ACT NO. 41 OF 1983

LEGEND:-

- 100 RESIDENTIAL (GROUP HOUSING PLOTTED)
- 200 COMMERCIAL
- 300 INDUSTRIAL
- 400 TRANSPORT AND COMMUNICATION
- 500 PUBLIC UTILITIES
- 600 PUBLIC AND SEMI PUBLIC USE
- 700 OPEN SPACES
- 800 AGRICULTURAL ZONE
- 900 SPECIAL ZONE
- 1000 NATURAL CONSERVATION ZONE

1:50,000  
SCALE  
IN CENTIMETERS (1:50,000)

DRAWING NO DTP(G) 2104/2012 DATED 09.11.2012

DESIGNED BY  
ASST. CHIEF TOWN PLANNER  
GURGAON  
CHIEF TOWN PLANNER  
GURGAON  
P.T.O. (G) 2104/2012  
TOWN & COUNTRY PLG  
HARYANA

DEPARTMENT OF TOWN AND COUNTRY PLANNING, HARYANA

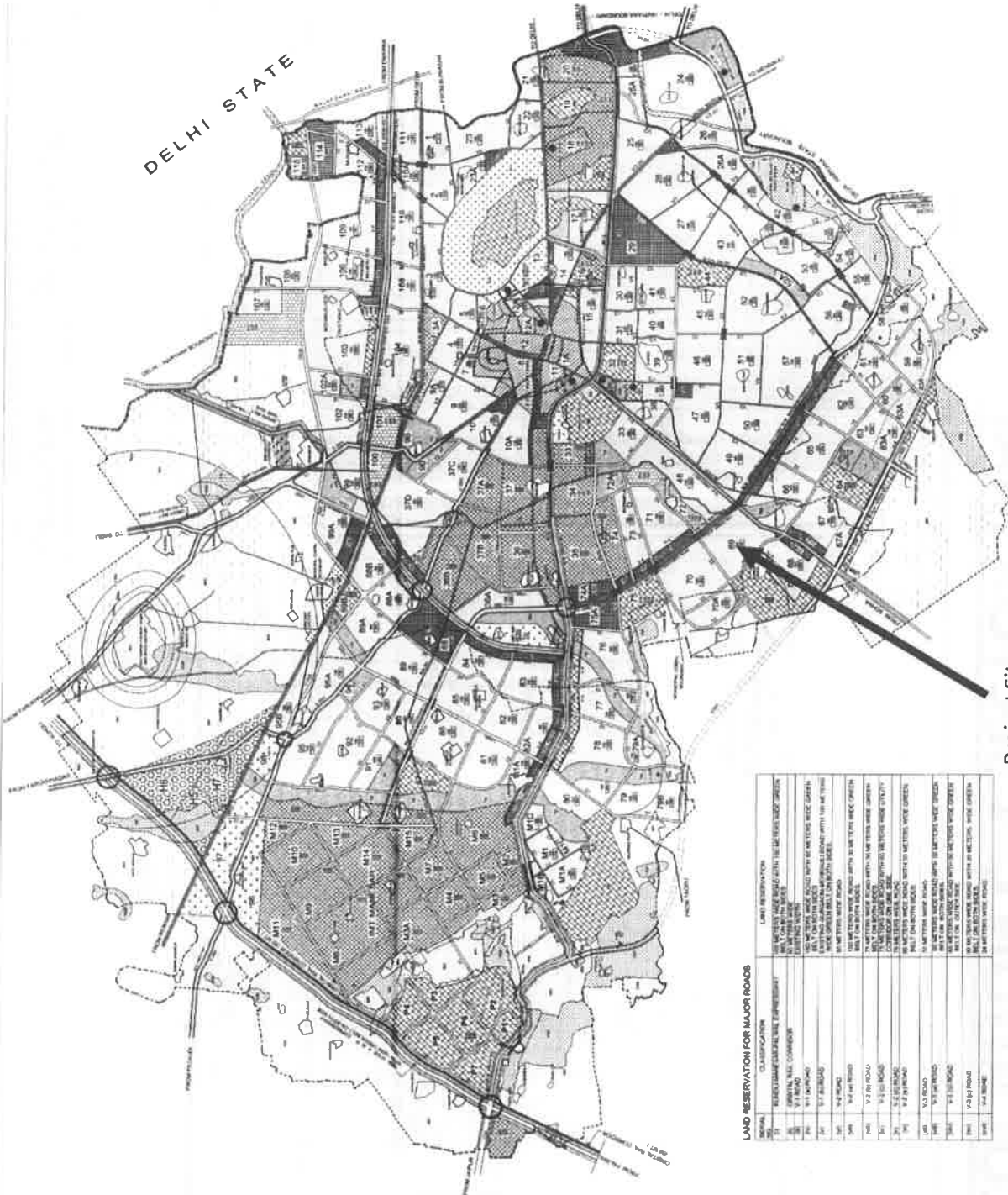

LAND RESERVATION FOR MAJOR ROADS	CLASSIFICATION	LAND RESERVATION
100	RESIDENTIAL	RESIDENTIAL
200	COMMERCIAL	COMMERCIAL
300	INDUSTRIAL	INDUSTRIAL
400	TRANSPORT AND COMMUNICATION	TRANSPORT AND COMMUNICATION
500	PUBLIC UTILITIES	PUBLIC UTILITIES
600	PUBLIC AND SEMI PUBLIC USE	PUBLIC AND SEMI PUBLIC USE
700	OPEN SPACES	OPEN SPACES
800	AGRICULTURAL ZONE	AGRICULTURAL ZONE
900	SPECIAL ZONE	SPECIAL ZONE
1000	NATURAL CONSERVATION ZONE	NATURAL CONSERVATION ZONE

Project Site

The map illustrates the layout of Sector 69 (Residential) and its immediate surroundings. Key features include:

- Sector 69 (Residential):** The central focus, showing a grid of residential plots and internal roads.
- Surrounding Sectors:**
  - Sector 48:** Located to the north of Sector 69.
  - Sector 72:** Located to the east of Sector 69.
  - Sector 71:** Located to the south of Sector 69.
  - Sector 70 (Residential):** Located to the west of Sector 69.
- Road Network:**
  - 90 M WIDE SOUTHERN PERIPHERY ROAD:** A major road running horizontally across the middle of the map.
  - 30 M WIDE GREEN BELT:** A green belt area located south of the 90m wide road.
  - 24 M WIDE ROADS:** Multiple roads of this width are shown, including one running vertically through Sector 69 and others forming the perimeter.
  - 60.0 M WIDE ROAD:** A wide road located to the west of Sector 69.
  - 60 M WIDE ROAD:** A road located to the north of Sector 69.
- Other Features:**
  - PROJECT SITE:** Indicated in the northern part of the map.
  - VILLAGE ABADI BADSHAPUR:** Located in the far north, beyond Sector 48.
  - Plot Numbers:** Various numbers (e.g., 26, 27, 33, 42, 43, 44, 45, 46, 47, 48, 49, 50, 53, 54, 55, 56, 57, 58, 59, 60, 61, 62, 63, 64, 65, 66, 67, 68, 69, 70, 71, 72, 73, 74, 75, 76, 77, 78, 79, 80, 81, 82, 83, 84, 85, 86, 87, 88, 89, 90, 91, 92, 93, 94, 95, 96, 97, 98, 99, 100) are scattered across the map, likely representing individual plots or specific locations.

LATITUDE	28°24'31.07"N
LONGITUDE	76°54'27.04"E

# GOOGLE MAP

## GOOGLE MAP SHOWING 500m RADIUS



- Nearest railway station:  
Basai Dhankot Railway Station – 9.2 Km NW  
Garhi harsaru Railway Station - 11.8 Km wwn
- Nearest airport: Indira Gandhi International Air Port -19.5 Km  
NNE
- Nearest Highway: SH - 13 (Sohna Road) – (Gurgaon City Centre  
to Sohna City Centre) adjacent
- Entry Road: Entry is from 24 mtr wide road



# Enclosure III

# COST ON ENVIRONMENT MANAGEMENT PLAN

## CAPITAL EXPENDITURE

S. No	Description	Capital Cost (Rs. in Lakhs)
1	Landscaping / Plantation	70.0
2	STP / Waste water treatment	130.0
3	Rain Water Collection	30.0
4	Acoustic Treatment	12.8
5	Solid Waste Management	10.0
6	Others	5.0
	<b>Total</b>	<b>Rs. 257.8 lacs</b>

## RECURRING EXPENDITURE

S. No	Description	Cost (Rs. in Lakhs/ Year)
1	Landscaping	7.0
2	Water Management(STP )	13.0
3	Air Management	2.0
4	Environmental Monitoring	2.58
5	Solid Waste Management	3.0
6	Misc.	2.0
	<b>Total</b>	<b>Rs. 29.58 lacs/Year</b>

## CORPORATE SOCIAL RESPONSIBILITY

<b>S No</b>	<b>Activity</b>	<b>Budget Allocated (in Crores)</b>
1	Provision of health check-up centre & ambulance for workers during construction phase.	0.5
2	To Construct toilets in nearby villages	3.0
3	Provision for providing clean drinking water in nearby villages	3.0
4	Provision for basic primary school infrastructure for Education of surrounding area children.	2.0
5	Village youths shall be provided vocational training for skill development	1.5
	<b>Total</b>	<b>10.0 Crores</b>

# Enclosure IV

**PROJECT : 15 Acres, Badshahpur, Gurgaon.**

**CONSTRUCTION SCHEDULE (15 Acres), Sector-69, Gurgaon**

Built Up Area	317342 Sft
Basement Area	271252.8 Sft
Total Area	588594.8 Sft

								2016								2017											
Sr. No.	Name of work	Estimate Cost in Lacs	Cost/ Sft	Date Start	Date of Completion	%age Completed	Duration in Days	May	June	July	Aug	Sept	Oct	Nov	Dec	Jan	Feb	Mar	Apr	May	June	July	Aug	Sept	Oct	Nov	Dec
A	PRE-CONSTRUCTION WORKS	20.63	6.50																								
i)	Misc Work & Enabling Services	20.63	6.50	05.05.2016	30.06.2016	-	-	10.31	10.32																		
B	BUILDING WORKS	2,749.81	866.51																								
i)	Civil works	2,158.42	680.16	01.06.2016	30.09.2017	-	-		50.00	100.00	110.00	120.00	130.00	140.00	150.00	170.00	180.00	180.00	180.00	170.00	160.00	150.00	89.00	80.00	-	-	
ii)	Aluminium & Glass Works	574.39	181.00	01.06.2017	30.11.2017	-	-														80.00	80.00	90.00	100.00	100.00	74.00	
iii)	Damper	17.00	5.36	01.01.2017	30.08.2017	-	-									1.00	1.50	2.50	3.00	3.50	3.00	1.50	1.00	-	-	-	
C	SERVICES	2,235.48	704.44																								
i)	Electrical Works	126.94	40.00	01.10.2016	15.10.2017	-	-						5.00	8.00	10.00	12.00	14.00	14.00	15.00	15.00	12.00	8.00	5.00	5.00	4.00	-	
ii)	Basement Conduiting Works	15.87	5.00	15.10.2016	31.12.2016	-	-						5.00	8.00	3.00												
iii)	Plumbing Works i/c Pump Rooms	154.72	48.76	01.11.2016	15.12.2017	-	-							6.00	8.00	10.00	12.00	12.00	12.00	15.00	18.00	15.00	12.00	12.00	10.00	8.00	
iv)	HVAC Works (Excluding Chiller	539.48	170.00	01.12.2016	30.12.2017	-	-									20.00	30.00	35.00	40.00	50.00	55.00	60.00	60.00	55.00	50.00	40.00	
v)	Basement Vantilation Works	203.44	64.11	01.10.2016	30.04.2017	-	-						25.00	25.00	30.00	40.00	35.00	30.00	18.00								
vi)	Fire Fighting	255.80	80.61	01.11.2016	15.12.2017	-	-							10.00	15.00	20.00	25.00	25.00	30.00	30.00	30.00	25.00	20.00	20.00	15.00	10.00	
vii)	Lifts	334.00	105.25	01.02.2017	30.09.2017	-	-										40.00	40.00	50.00	80.00	65.00	30.00	19.00	10.00	-	-	
viii)	Security / B.M.S	47.60	15.00	01.02.2017	30.09.2017	-	-										5.00	5.00	8.00	10.00	8.00	5.00	4.00	3.00	-	-	
ix)	Fire Check door	9.52	3.00	01.01.2017	30.09.2017	-	-									0.50	0.50	1.00	1.50	2.00	1.50	1.00	1.00	0.50	-	-	
x)	Sub-station	253.87	80.00	01.11.2016	30.10.2017	-	-							10.00	15.00	20.00	25.00	30.00	35.00	30.00	25.00	25.00	20.00	12.00	7.00	-	
xi)	D.G.Sets Enabling Works	126.94	40.00	01.11.2016	30.10.2017	-	-							5.00	10.00	10.00	15.00	20.00	15.00	10.00	10.00	10.00	8.00	8.00	6.00	-	
xii)	Solar Panel	49.98	15.75	01.05.2017	30.10.2017	-	-													5.00	10.00	15.00	10.00	5.00	5.00	-	
xiii)	Gas Flooding System	19.99	6.30	01.04.2017	30.10.2017	-	-												2.00	3.00	5.00	3.00	3.00	2.00	2.00	-	
xiv)	Façade Access System	18.00	5.67	01.07.2017	31.12.2017	-	-							3.00	3.00	4.00	4.00	4.00	5.00	5.00	5.00	5.00	4.00	3.00	3.00	-	
xv)	External Drainage / Serage System	47.60	15.00	01.11.2016	30.10.2017	-	-																5.00	7.00	10.00	6.00	
xvi)	Fire Curtain in Drivways Only	31.73	10.00	01.08.2017	31.12.2017	-	-																				
D	DEVELOPMENT OF LAND	350.07	110.31																								
i)	Soil Investigation	1.59	0.50																								
ii)	Land Scaping Works													10.00	15.00	15.00	20.00	20.00	25.00	30.00	25.00	20.00	15.00	10.00	5.00	-	
a)	Hard Landscaping	210.08	66.20	01.11.2016	30.10.2017	-	-													3.00	5.00	8.00	5.00	3.00	3.00	-	
b)	Soft Landscaping	27.19	8.57	01.05.2017	30.10.2017	-	-																			-	
iii)	Boundary wall	51.93	16.36	01.06.2016	31.10.2016	-	-		5.00	12.00	15.00	12.00	8.00													-	
iv)	Basement Deck Proofing work	33.89	10.68	01.01.2017	31.03.2017	-	-									9.00	15.00	10.00								-	
v)	External Electrical	19.04	6.00	01.01.2017	30.06.2017	-	-									2.00	3.00	4.00	5.00	4.00	3.00					-	
E	UNITECH SUPPLY	3,371.34	1,062.37																								
i)	RMC	1,314.99	414.38	01.06.2016	31.12.2017	-	-		25.00	50.00	80.00	80.00	90.00	90.00	100.00	100.00	100.00	90.00	90.00	80.00	80.00	70.00	60.00	50.00	40.00	30.00	
ii)	Reinforcement Steel	1,424.40	448.85	01.06.2016	31.05.2017	-	-		80.00	90.00	100.00	150.00	200.00	200.00	175.00	150.00	100.00	80.00	60.00	40.00						-	
iii)	Cement	128.27	40.42	01.06.2016	30.11.2017	-	-		5.00	8.00	8.00	10.00	10.00	10.00	10.00	10.00	10.00	7.00	5.00	5.00	5.00	5.00	5.00	5.00	5.00	33.00	
iv)	D.G.Sets	363.00	114.39	01.06.2017	31.12.2017	-	-														5.00	5.00	10.00	15.00	10.00	5.00	
v)	Transformer & Panel	55.00	17.33	01.06.2017	31.12.2017	-	-															5.00	5.00	5.00	3.00	3.00	
vi)	Cable	47.60	15.00	01.02.2017	31.12.2017	-	-															8.00	5.00	5.00	3.00	3.00	
v)	Sanitary and Electrical fixtures & Energy Meters.	38.08	12.00	01.06.2017	31.12.2017	-	-														5.00	8.00	8.00	6.00	5.00	4.00	
F	MISCELANEOUS WORK	306.82	96.69																		2.00	3.00	5.00	5.00	4.00	3.00	
i)	Signages	23.80	7.50	01.06.2017	31.12.2017	-	-														0.50	1.00	1.50	2.00	1.50	0.50	
ii)	Maint. equipments	7.93	2.50	01.06.2017	31.12.2017	-	-								5.00	5.00	5.00	8.00	8.00	5.00	5.00	3.00	3.00	3.00	-	-	
iii)	STP Work	49.50	15.60	01.12.2016	30.09.2017	-	-										7.00	8.00								-	
iv)	Boom gate & Security (CCTV)	14.28	4.50	01.02.2017	31.03.2017	-	-															20.00	20.00	30.00	15.00	-	
v)	Interior works Lobby (GF only)	84.39	26.59	01.06.2017	30.09.2017	-	-															5.00	10.00	10.00	7.00	-	
vi)	G. F. Toilets finishing and Sanitaryware	31.72	10.00	15.06.2017	15.09.2017	-	-																				

# **Annexure I**

# STANDARD OPERATION PLAN FOR ENVIRONMENTAL & HEALTH ASPECTS AT PROJECT SITE

## **GENERAL REQUIREMENTS ON ENVIRONMENTAL & HEALTH ASPECTS**

### **GENERAL CONDITION**

1. It should be the contractor's fundamental responsibility to conform to the relevant Environmental Laws or Codes as established by MoEF and other Governmental Statutory agencies to maintain the pristine Environmental Standards as applicable for the project construction works. The contractor should comply with all the enactments which should include but are not limited to:
  - a. Water (Prevention and Control of pollution) Act, 1974
  - b. Air (Prevention and Control of pollution) Act, 1981
  - c. Environment (Protection) Act, 1986
  - d. The Hazardous Wastes (Management & Handling) Rules, 1989
  - e. The Public Liability Insurance Act, 1991
  - f. The Municipal Solid Wastes (Management & Handling) Rules, 2000
  - g. Noise Pollution (Regulation & Control) Rules, 2000
2. The contractor should comply with all the required Site Environmental & Health Aspects at Project Site as mentioned in the following documents for his construction activity. The contractor should specify in **Annexure B** of the tender document, the minimum no. of manpower (cleaners/sweepers) suppose to be operated exclusively for cleaning & housekeeping. In case of non-compliance, the Employer may deduct an amount as stipulated in the said **Annexure B** as penalty for cleaning charges. It may herein be noted that requirement of manpower for cleaning & housekeeping may vary as per site conditions, as such, the Contractor will have to deploy the additional manpower as per requirement & as directed by Project Incharge.
3. The contractor should be responsible to construct labour camp/hutment, canteen, appropriate no of separate male and female toilet, crèche, etc. for construction labours as may be applicable for the project and should be responsible for arrangement of other proper basic amenities required by the construction labour during the construction phase. Maintenance of health and sanitation in the construction site will be contractor's responsibility.
4. To keep the area clean and uncluttered (**as per Annexure II**) the contractor should appoint cleaning supervisor with appropriate no. of support staff to clean the site on daily basis and should arrange for regular proper disposal of waste generated over the area.
5. Within two weeks of acceptance of the Contract, the contractor shall submit Environmental Compliance Checklist (**Annexure I**) and his specific consideration for Site Environmental & Health Management practices followed by employer for their review. If the Contractor fails to submit the said reports by stipulated time;

he shall be given a three week time for submission. The assessment shall be made after that period and if the Contractor fails to submit the reports, an amount equal to the 0.25% of the Contract value shall be put on hold from his next running bill. The reassessment of the same shall be made after further three weeks & even after completion of six weeks in running, if the Contractor unable to furnish the said reports to the satisfaction of Project Incharge, a penalty equal to 0.25% of the contract value shall be deducted from his next Running Account Bill subject to maximum of Rs. 2,50,000/- which shall be irreversible.

6. The contractor should submit Assessment Report for Environmental & Health Aspects for Project Site (**Annexure II**) on monthly basis and contractor should submit Initial Environmental Compliance Checklist Report as (**Annexure-I**) on quarterly basis. The report should be prepared generally accompanying Company designated person at project site or as may be decided by the Company's own site office. Company authorized person in this behalf may inspect the project site at any time in order to assess the Company's own standard of Site Environmental and Health Aspects at project site.
7. The principle employer will carried out for Environmental Pollution Monitoring at project site by any authorized laboratory for cross checking the actual condition of project site with respect to various environmental aspects. If there is any critical consideration by the Employer' side, the contractor should follow the recommendations of the employer, if any, in this regard.
8. The contractor should adopt an appropriate emergency plan to deal with any accidental situations to safeguard the life and property and to prevent accidental spillage or pollution of the environment during the whole construction work.
9. If the contractor does not complies with the Monthly Assessment Report for Environmental & Health Aspects (**Annexure-II**) and Quarterly Initial Environmental Compliance Checklist (**Annexure-I**) for project site for whole construction phase; the Principal Employer may hold 0.25% of the bill from their monthly billing amounts. Successive failure to comply with the Monitoring Schedule will result in deduction of 0.25% of the Contract value as penalty subject to maximum of Rs. 2,50,000/-. This penalty shall be other than the one described in clause 5 above.

#### **SPECIFIC REQUIREMENTS:**

##### ***A. Health aspects of labors:***

1. Proper First Aid facility/Room will be provided in the project during whole construction phase of the project.
2. All the laborers to be engaged for construction works should be screened for health and adequately treated before the issue of work permits and necessary fitness certificate of the labors should be kept at site.

3. Proper record of medical checkup and first aid cases of the labors should be maintained at site in separate register.
4. A Contract/ tie up with the nearby nursing home should be taken in case of any emergency in construction phase.

**B. Good Housekeeping Practices:** The contractor shall take all precautions to avoid any nuisance arising from his operations. For good house keeping purposes, work area laid out planning in relation to sitting of labour camp, canteen, toilet, storage yard, etc. should be decided in consultation with the Company designated person in the project site before schedule to start of the construction. The designated places for specific purposes must have appropriate labeling with necessary documentations, if any. The contractor should appoint Cleaning Supervisor with appropriate nos. of workforce and following considerations should be implemented strictly for good housekeeping purposes:

1. The contractor should provide adequate number of toilets (at least one for every 50 labours) with proper septic tank, vent pipe connector and soak pit for the construction labours separate for male and female. In case of high rise building the toilet should be provided at suitable intermittent towers.
2. The contractor should ensure proper disposal of sewage so that sanitary conditions are maintained. Regular cleaning of toilet and soak pit should be ensured.
3. Areas with regular movement of vehicles should have a pacca road/hard surface so that the dust may be controlled during transportation of construction materials inside the construction site.
4. The Contractor should have appropriate water sprinkler systems and shall water down construction sites as required to suppress dust, during handling of excavated soil or debris or during demolition.
5. There should be different provision for construction material storage according to their physical and chemical property. The contractor should arrange tarpaulin cover on fine dust generating construction materials; chemicals and hazardous materials should have concrete slab on their floor.
6. The contractor should ensure separate management facilities for handling Construction related wastes and domestic wastes generated from labour camp/office.
7. Work areas are kept uncluttered and are cleaned upon completion of operations or at the end of each workday. Equipments/ items associated should be returned to their proper place after use.
8. The contractor should construct canteen of appropriate size for consuming food and snacks by the labours to prevent random disposal of all garbage or trash associated with food.

9. The temporary dumping areas shall be maintained by the contractor at all times until the excavate is reutilized as per the employer's requirements. Stockpiles should be covered with tarpaulin and should be sprinkled to stabilize until they are effectively managed.
10. The contractor should provide "Refuse Containers" with tight fitting lids at site for the management of domestic waste generated by the construction labours and these containers shall be emptied at least once daily by the contractor to maintain site sanitation.
11. Chemicals, if any, associated should never be stored on the open place, except in closed door cabinets suitable for the materials to be stored.
12. Hazardous Wastes are to be stored in properly labeled containers, and at separate designated places for the same, and should be returned to that location after each use.
13. Hazardous waste materials should have separate storage facility and should be transferred only to authorized contractor or operators for this facility.

**C. Air Environment:** Every feasible measure should be considered to maintain or improve the pristine air quality over the work place. To achieve compliance with air contaminant standards, administrative, or engineering, or other controls must first be determined and implemented, wherever feasible, as follows:

1. Before taking up the construction work the area should be enclosed with sheeted enclosure.
2. All construction related equipments and/or technical measures must strive with relevant IS Code with appropriate air pollution abatement system.
3. The contractor should arrange "Consent to Establish" and "Consent to Operate" against Air Pollution Act from concerned State Pollution Control Boards as may be applicable for operation of certain facilities (e.g. batching plant, D.G. set, Concrete mixer, etc.). They should be responsible for periodic renewal of its Consent to Operate as may be applicable for the facilities.
4. If conveyers are used, conveyer belt should be fitted with wind board. Hopper discharge areas shall be enclosed to minimize dust emission.
5. The vehicles, which will be used for transportation of construction materials to the site, should possess valid Pollution Under Control (PUC) Certificates. All the transport vehicles should have proper spark arrester/muffler to minimize the risk of fire during transportation.

6. Care should be ensured so that the dust generation during transport and handling be minimum. The vehicles which will carry loose materials should be covered and loaded with sufficient free boards to avoid spills through the tail board or side board. Dust generating materials should be loaded and unloaded only in closed systems or wind protected areas.
7. Contractor should obtain necessary permission for running the DG set from concerned State Electricity Board and the installation of DG set should be carried out by the Executive-Engineer of the Electricity Inspectorate.
8. Sprinkling of water and fine spray from nozzle to suppress the dust.
9. On road inspection should be done for black smoke generating machinery/vehicle.
10. Promotion of use Clear fuel should be done.
11. Use of covering sheet should be done for trucks to prevent dust dispersion from the trucks.
12. Temporary roads should be provided for controlling of dust suppression onsite.
13. Reducing Speed upto 20Kmph or as per site requirement for dust suppression.
14. We will have to put tarpaulin on scaffolding around area of construction.
15. Materials like particular sand and construction material should not be stored on open area or street.
16. Construction material should be fully covered through sheet or other thing.
17. Construction materials carrying vehicle should be cleaned after loading/unloading from project site.
18. Every working labor on site should have proper PPE (Personal protective equipment) for prevention of dust particle.
19. Unit should have tie-up with medical agency for routine checkup of all labors.  
Also first aid facility should be readily available on site.
20. We should have wetjet in grinding and stone cutting work.
21. Wind erosion problem mitigate through vegetation, windbreak and shelter.
22. Open burning of wastes to be completely avoided.

#### ***OPERATION PHASE AIR MANAGEMENT***

1. Dense canopy tree plantation is must, except of shrubs and herbs (we will have local species as per climate condition).
2. "Pollution under Check" certificate of all vehicle in premises.
3. We will have to provide adequate DG sets stack height and low sulphur diesel.

4. We should have adequate ventilation in STP (Sewerage Treatment Plant) area for gases dilution.
5. Area should have good housekeeping practices.
6. Open burning of wastes to be completely avoided.

**D. Water Environment:** The Contractor should manage the waste water arising out of the project activity as long as practicable. The contractor shall at all times ensure that all existing stream courses and drains within and adjacent to the site are kept safe and free from any pollutant arising due to construction activities. The contractor shall ensure that earth, chemicals, and concrete agitator washings, etc. are not deposited in the water course. Following considerations should be strictly maintained by the contractor:

1. The contractor shall arrange an adequate supply of potable water @ 5 lpcd for the domestic use of labourers in the camp. The contractor should provide storage tank of suitable capacity for the storage of water to be consumed by labour. The tank should be cleaned at least once in a week.
2. Proper drainage facility should be provided to handle the waste water arising out of the site. The drainage should be planned in a way that there is no accumulation of water within the project area or vicinity to the site. Regular cleanup of the drainage system should be practiced.
3. The waste water should be disposed off suitably and in a manner that will cause neither pollution nor nuisance. The contractor should adopt necessary precautions against storm water for erosion control measures as well as for minimizing runoff from any spoil piles.
4. The Contractor shall discharge wastewater arising out of site office, canteen or toilet facilities constructed by him into sewers. The Contractor should take approval from nodal agencies for that in their own credit. If sewer is not availed in nearby sources appropriate septic tank/soak pit to be constructed and adequate control measures to be ensured on that behalf to maintain the sanitary conditions over the work place.
5. The contractor should adopt every feasible option to prevent the run-off from construction debris or excavated materials polluting local water body or creating problem for local drainage system.
6. Storage of debris would be planned by avoiding natural waterways/drainage pattern of the project site.

**E. Noise Environment:** Excessive noise exposure can cause permanent hearing loss, which could be totally preventable if appropriate precautions are taken. The Contractor shall take all appropriate measures to ensure that work carried out by the contractors, whether on or off the sites, will not cause any unnecessary or excessive noise which may be beyond the legitimate standards specified by the nodal agencies and may be a cause of irritation to local neighbours. He should take all necessary control measures to bring down the sound level generated by various instruments by appropriate enclosures, if applicable.

1. Work area lay out plan and entire work scheduling should be planned prior to start of the job in a way that there should be maximum physical separation between noise generators and noise receptors and to avoid simultaneous activities that both generate high noise levels.
2. Silencers and mufflers on construction equipments should be properly fitted and maintained so that the ambient noise level standards prescribed in the Noise Pollution (Regulation & Control), 2000 are maintained.
3. The contractor shall ensure that all powered mechanical equipment used in the works has the most modern techniques available but not limited to silencers and mufflers.
4. The contractor shall construct acoustic enclosures around any plants of the works from where excessive noise may be generated.
5. Mechanical equipments, to be used in the work should have "Conformance Labeling" as applicable.

**F. Solid Waste Management:** With careful designing, planning, and good site management solid waste generated from the project can be minimized. Before starting the job, adequate measures should be ensured for temporary storage of construction wastes after consultation with Company designated person and following considerations should be taken care of:

1. Entire construction planning should be in a way that there is minimum generation of construction wastes like concrete, mortars and cement grouts.
2. Reuse of entire construction wastes should be planned as far as possible.
3. Construction solids should be removed from the site as frequent as possible.
4. Litter disposal and collection points should be established around all construction sites.
5. Adequate measures should be adopted to check any runoff from spoil piles.

6. The transportation of construction spoil shall be allowed only to officially designated dumpsites after obtaining necessary permission from relevant authorities.

***G. Chemical and Hazardous Material Safety:*** The construction works may be associated with handling of many hazardous wastes. If so, will be handled as per the provisions of the Hazardous Wastes (Management & Handling) Rules, 1989 and should adhere to following conditions:

1. Chemical containers should be labeled with contents, capped, and in good condition. Contents label should include full name of material; formula. The original label should be defaced if it is not consistent with the current contents.
2. The contractor should be responsible for proper collection, reception, treatment, storage and disposal of hazardous wastes, if any. All the hazardous storage containers should have proper labeling and should be stored properly
3. The contractor should ensure definitive care in handling chemical and hazardous materials to minimize every possible risk of accidental release or spillage of chemicals to the environment.
4. All containers of hazardous materials that are stored in fifty-five-gallon containers or larger are required to be stored in secondary containers. If gas cylinders are to be used; should be transported through wheeled cart and should be stored properly in ventilated areas.
5. For disposal, they can be sold only to authorized contractors or Operators of Centralized Hazardous Wastes-Treatment, Storage and Disposal
6. There shall be constant vigilance for any sign of chemical leakage. Containers storing chemical waste must be inspected weekly for any sign of chemical leakage.
7. Compressed Gas Safety: The cylinders that contain compressed gases are primarily shipping containers and should not be subjected to rough handling or abuse. Such misuse can seriously weaken the cylinder and render it unfit for further use
  - Empty and full cylinders should be stored in separate areas.
  - Cylinders should never be rolled or dragged.
  - When moving large cylinders, they should be strapped to a properly designed wheeled cart to ensure stability.
  - Only one cylinder should be handled (moved) at a time.

## **ANNEXURE I**

### **INITIAL ENVIRONMENTAL COMPLIANCE CHECKLIST REPORT**

#### ***Facility information:***

**PROJECT NAME:**

**PROJECT LOCATION:**

**COMPANY/CONTRACTOR NAME:**

**CONTACT PERSON:**

**CONTACT NO:**

Please answer each question and mark the appropriate answer where applicable

## *Health Aspects of labours*

S l. n o.	Legal Compliance Issues	<input type="checkbox"/> Yes <input type="checkbox"/> No	Permit No.	Valid till	Compliance date
1	Proper First Aid facility/Room will be provided at project site.				
2	All the laborers to be engaged for construction works should be screened for health before the issue of work permits				
3	All necessary fitness certificates of the labors should be kept at site.				
4	Proper record of medical checkup and first aid cases of the labours should be maintained at site in separate register				
5	A Contract/ tie up with the nearby nursing home should be taken in case of any emergency in construction phase.				
6	Any others:				

**Note:** In case of noncompliance to any above mentioned subject, the contractor should intimate the expected date of compliance. If any other subject, excluding the above mentioned one is under the purview of "Environmental Clearance/any other statutory letter" as per the provisions in Health aspects, the contractor should arrange the same.

Please answer each question and mark the appropriate answer where applicable

## ***Air Environment***

S l. n o.	Legal Compliance Issues	<input type="checkbox"/> Yes <input type="checkbox"/> No	Permit No.	Remarks
1	Do you have PUC Certificate of vehicles transporting construction materials?			
	Have you obtained the "Consent to Establish" Certificate for the DG set from State Pollution Control Board?			
3	Have you obtained the "Consent to Operate" Certificate for the DG set from State Pollution Control Board?			
4	When did you last conduct the Air Quality Assessment for DG set?			
5	Do you have adequate dust suppression measures?			
6	Are you complying with the provisions made under Indian Electricity Rules?			
7	Any others:			

**Note:** In case of noncompliance to any above mentioned subject, the contractor should intimate the expected date of compliance. If any other subject, excluding the above mentioned one is under the purview of "Environmental Clearance/any other statutory letter" as per the provisions in Air Act, the contractor should arrange the same.

Please answer each question and mark the appropriate answer where applicable

### *Water Environment*

Sl. no.	Legal Compliance Issues	<input type="checkbox"/> Yes <input type="checkbox"/> No	Permit No.	Valid till	Expected date of compliance
1	Do you have proper arrangement for supply of water to construction labours?				
2	Are you ready for surveillance of the potable water quality to be supplied to the labours?				
3	Have you provided appropriate drainage system?				
4	Have you constructed appropriate septic tank/soak pit?				

**Note:** In case of noncompliance to any above mentioned subject, the contractor should intimate the expected date of compliance. If any other subject, excluding the above mentioned one is under the purview of "Environmental Clearance/any other statutory letter" as per the provisions in Water Act, the contractor should arrange the same.

Please answer each question and mark the appropriate answer where applicable

## *Noise Environment*

Sl. no.	Legal Compliance Issues	<input type="checkbox"/> Yes <input type="checkbox"/> No	Permit No.	Valid till	Expected date of compliance
1	Have you obtained the "Consent to Establish" Certificate for DG set from State Pollution Control Board?				
2	Have you obtained the "Consent to Operate" Certificate for the DG set from State Pollution Control Board?				
3	Does your DG set have proper Acoustic Enclosure?				
4	Have you obtained the "Conformance Labeling" for DG set from the supplier?				
4	Does your DG set comply with the Max. Ambient Noise level?				
5	When did you last conduct the Noise Quality Assessment for DG set?				
6	Any others:				

**Note:** In case of noncompliance to any above mentioned subject, the contractor should intimate the expected date of compliance. If any other subject, excluding the above mentioned one is under the purview of "Environmental Clearance/any other statutory letter" as per the provisions in Noise Act, the contractor should arrange the same.

Please answer each question and mark the appropriate answer where applicable

## *Waste Management*

Sl. no.	Legal Compliance Issues	Yes/No	Permit No.	Valid till	Expected date of compliance
1	Have you provided any hazardous storage system for your activities?				
2	Have you obtained the "Authorization" Certificate from State Pollution Control Board against Hazardous Waste Management rules?				
3	What is the license number of contractor/occupier (for transfer of hazardous waste) for handling/processing hazardous waste?				
4	Do you have proper solid waste segregation and final disposal facility?				

**Note:** In case of noncompliance to any above mentioned subject, the contractor should intimate the expected date of compliance. If any other subject, excluding the above mentioned one is under the purview of "Environmental Clearance/any other statutory letter" as per the provisions in Hazardous Waste Management Act or Municipal Solid Waste, the contractor should arrange the same.

## ATTIEXURE II

# MONTHLY ASSESSMENT REPORT FOR ENVIRONMENTAL & HEALTH ASPECTS AT PROJECT SITE

**PROJECT NAME:**

**PROJECT LOCATION:**

**REPORT NO.:**

**INSPECTION DATE:**

**INSPECTED BY:**

**PARTICIPANTS:**

Environmental Issues	Key Areas	Compliance status	Recommendations/ Remarks
HOUSEKEEPING	1. Provision of construction material storage yard	<ul style="list-style-type: none"> <li>• Satisfactory</li> <li>• Scope of improvement</li> <li>• Noncompliance</li> </ul>	
	2. Provision of chemical storage yard	<ul style="list-style-type: none"> <li>• Satisfactory</li> <li>• Scope of improvement</li> <li>• Noncompliance</li> </ul>	
	3. Proper stacking of construction material	<ul style="list-style-type: none"> <li>• Satisfactory</li> <li>• Scope of improvement</li> <li>• Noncompliance</li> </ul>	
	4. Provision of tarpaulin cover on fine dust generating construction material.	<ul style="list-style-type: none"> <li>• Satisfactory</li> <li>• Scope of improvement</li> <li>• Noncompliance</li> </ul>	
	5. Provision of concrete slab on ground for storage of hazardous waste.	<ul style="list-style-type: none"> <li>• Satisfactory</li> <li>• Scope of improvement</li> <li>• Noncompliance</li> </ul>	
	6. Provision of wheeled cart for transporting gas cylinders.	<ul style="list-style-type: none"> <li>• Satisfactory</li> <li>• Scope of improvement</li> <li>• Noncompliance</li> </ul>	
	7. Provision of hutment/canteen for construction worker	<ul style="list-style-type: none"> <li>• Satisfactory</li> <li>• Scope of improvement</li> <li>• Noncompliance</li> </ul>	
	8. Provision of adequate no. of toilet for construction workers separate for gents and females.	<ul style="list-style-type: none"> <li>• Satisfactory</li> <li>• Scope of improvement</li> <li>• Noncompliance</li> </ul>	
	9. Provision of proper vent pipe in toilet.	<ul style="list-style-type: none"> <li>• Satisfactory</li> <li>• Scope of improvement</li> <li>• Noncompliance</li> </ul>	
	10. Arrangement for proper regular cleaning of toilet.	<ul style="list-style-type: none"> <li>• Satisfactory</li> <li>• Scope of improvement</li> <li>• Noncompliance</li> </ul>	
	11. Provision of adequate no. of refuse containers for domestic wastes.	<ul style="list-style-type: none"> <li>• Satisfactory</li> <li>• Scope of Improvement</li> <li>• Noncompliance</li> </ul>	
	12. Provision of	<ul style="list-style-type: none"> <li>• Satisfactory</li> </ul>	

	adequate no. of refuse containers for construction wastes.	<ul style="list-style-type: none"> <li>• Satisfactory</li> <li>• Noncompliance</li> </ul>	
	13. Separate proper storage facility for discarded hazardous material	<ul style="list-style-type: none"> <li>• Satisfactory</li> <li>• Scope of improvement</li> <li>• Noncompliance</li> </ul>	
	14. Regular Clean up of the site	<ul style="list-style-type: none"> <li>• Satisfactory</li> <li>• Scope of improvement</li> <li>• Noncompliance</li> </ul>	
	15. Work lay out plan	<ul style="list-style-type: none"> <li>• Satisfactory</li> <li>• Scope of improvement</li> <li>• Noncompliance</li> </ul>	
	<i>Any other noted noncompliance-</i>		
<b>WATER ENVIRONMENT</b>	1. Proper storage facility for drinking water.	<ul style="list-style-type: none"> <li>• Satisfactory</li> <li>• Scope of improvement</li> <li>• Noncompliance</li> </ul>	
	2. Tank of suitable capacity for storage for construction purposes.	<ul style="list-style-type: none"> <li>• Satisfactory</li> <li>• Scope of improvement</li> <li>• Noncompliance</li> </ul>	
	3. Provision of drainage for disposal of domestic sewage	<ul style="list-style-type: none"> <li>• Satisfactory</li> <li>• Scope of improvement</li> <li>• Noncompliance</li> </ul>	
	4. Provision of drainage for management of storm water	<ul style="list-style-type: none"> <li>• Satisfactory</li> <li>• Scope of Improvement</li> <li>• Noncompliance</li> </ul>	
	5. Regular cleanup of drinking water storage tank	<ul style="list-style-type: none"> <li>• Satisfactory</li> <li>• Scope of improvement</li> <li>• Noncompliance</li> </ul>	
	6. Regular cleanup of drainage system	<ul style="list-style-type: none"> <li>• Satisfactory</li> <li>• Scope of improvement</li> <li>• Noncompliance</li> </ul>	
	<i>Any other noted noncompliance-</i>		
<b>AIR ENVIRONMENT</b>	1. Provision for proper loading/unloading facility for	<ul style="list-style-type: none"> <li>• Satisfactory</li> <li>• Scope of improvement</li> <li>• Noncompliance</li> </ul>	

	construction materials.		
	2. Provision of tarpaulin cover on fine dust generating construction materials during transportation.	<ul style="list-style-type: none"> <li>• Satisfactory</li> <li>• Scope of improvement</li> <li>• Noncompliance</li> </ul>	
	3. Provision of “pacca road” at project site for transportation of vehicles.	<ul style="list-style-type: none"> <li>• Satisfactory</li> <li>• Scope of improvement</li> <li>• Noncompliance</li> </ul>	
	4. Stack of appropriate height for DG set.	<ul style="list-style-type: none"> <li>• Satisfactory</li> <li>• Scope of improvement</li> <li>• Noncompliance</li> </ul>	
	5. Regular sprinkling for dust suppression measures.	<ul style="list-style-type: none"> <li>• Satisfactory</li> <li>• Scope of improvement</li> <li>• Noncompliance</li> </ul>	
	6. Provision of wheel washing facility.	<ul style="list-style-type: none"> <li>• Satisfactory</li> <li>• Scope of improvement</li> <li>• Noncompliance</li> </ul>	
	<i>Any other noted noncompliance-</i>		
<b>NOISE ENVIRONMENT</b>	1. Provision of acoustic enclosures on DG set.	<ul style="list-style-type: none"> <li>• Satisfactory</li> <li>• Scope of improvement</li> <li>• Noncompliance</li> </ul>	
	2. Provision of silencers/mufflers on high noise generating instruments.	<ul style="list-style-type: none"> <li>• Satisfactory</li> <li>• Scope of improvement</li> <li>• Noncompliance</li> </ul>	
	<i>Any other noted noncompliance-</i>		
	1. Proper provision for storage of construction wastes.	<ul style="list-style-type: none"> <li>• Satisfactory</li> <li>• Scope of improvement</li> <li>• Noncompliance</li> </ul>	
	2. Provision of colour coding and labeling in waste bins.	<ul style="list-style-type: none"> <li>• Satisfactory</li> <li>• Scope of improvement</li> <li>• Noncompliance</li> </ul>	
	3. Regular sprinkling on	<ul style="list-style-type: none"> <li>• Satisfactory</li> </ul>	

<b>SOLID WASTE MANAGEMENT</b>	construction generated malba, etc.	<ul style="list-style-type: none"> <li>• Scope of improvement</li> <li>• Noncompliance</li> </ul>	
	4. Construction generated malbas are effectively reused within project site	<ul style="list-style-type: none"> <li>• Satisfactory</li> <li>• Scope of improvement</li> <li>• Noncompliance</li> </ul>	
	5. Proper provision for storage of domestic waste.	<ul style="list-style-type: none"> <li>• Satisfactory</li> <li>• Scope of improvement</li> <li>• Noncompliance</li> </ul>	
	6. Proper management of temporary soil bank	<ul style="list-style-type: none"> <li>• Satisfactory</li> <li>• Scope of improvement</li> <li>• Noncompliance</li> </ul>	
	7. Regular transfer of domestic waste.	<ul style="list-style-type: none"> <li>• Satisfactory</li> <li>• Scope of improvement</li> <li>• Noncompliance</li> </ul>	
	<b><i>Any other noted noncompliance-</i></b>		
<b>CHEMICALS AND HAZARDOUS MATERIAL SAFETY</b>	1. Storage container adequate for chemical storage.	<ul style="list-style-type: none"> <li>• Satisfactory</li> <li>• Scope of improvement</li> <li>• Noncompliance</li> </ul>	
	2. Storage containers are properly labeled.	<ul style="list-style-type: none"> <li>• Satisfactory</li> <li>• Scope of Improvement</li> <li>• Noncompliance</li> </ul>	
	3. They are stored in proper place	<ul style="list-style-type: none"> <li>• Satisfactory</li> <li>• Scope of improvement</li> <li>• Noncompliance</li> </ul>	
	4. They are transported properly	<ul style="list-style-type: none"> <li>• Satisfactory</li> <li>• Scope of improvement</li> <li>• Noncompliance</li> </ul>	
	5. They are handled properly	<ul style="list-style-type: none"> <li>• Satisfactory</li> <li>• Scope of improvement</li> <li>• Noncompliance</li> </ul>	
	6. Provision of secondary containment for transfer of chemicals	<ul style="list-style-type: none"> <li>• Satisfactory</li> <li>• Scope of improvement</li> <li>• Noncompliance</li> </ul>	
	7. Proper provisions for spill control measures.	<ul style="list-style-type: none"> <li>• Satisfactory</li> <li>• Scope of improvement</li> <li>• Noncompliance</li> </ul>	
	8. Regular proper clean up of containers	<ul style="list-style-type: none"> <li>• Satisfactory</li> <li>• Scope of improvement</li> </ul>	

		<ul style="list-style-type: none"> <li>• Noncompliance</li> </ul>	
	9. Storage facility for empty drums/containers	<ul style="list-style-type: none"> <li>• Satisfactory</li> <li>• Scope of improvement</li> <li>• Noncompliance</li> </ul>	
	10. They are sold only to authorized contractor or Operators.	<ul style="list-style-type: none"> <li>• Satisfactory</li> <li>• Scope of Improvement</li> <li>• Noncompliance</li> </ul>	
	11. Regular transfer of discarded hazardous materials.	<ul style="list-style-type: none"> <li>• Satisfactory</li> <li>• Scope of improvement</li> <li>• Noncompliance</li> </ul>	
	<i>Any other noted noncompliance-</i>		

**NB:**

- 1) Cases of "Scope of Improvement" up to 10% shall not be penalized.
- 2) Cases of "Non-Compliance" shall be penalized at the rate of Rs.150 per item.
- 3) Cases of "Scope of Improvement" beyond 10% shall be penalized at the rate of Rs. 100 per item.

**Site Environmental Inspection Analysis and Collation:**

## **Section 1 - General**

### **1.1 Introduction**

Safety Manual sets forth safety guidelines to be followed at each construction sites of Real Estate Division, Unitech Ltd.. Air is to achieve zero accident target in our construction sites. It obviously cannot cover each and every situation and is not intended to so.

### **1.2 Responsibility of Site Staff**

Site staff includes all personnel who are responsible for supervision of works e.g. Project Co-ordinators, Project in charge, Site in charge, Site Engineers and Site Supervisors. Responsibilities of site staff are enumerated below :-

- 1.2.1 He/They will assist contractors to work out a safety programme.
- 1.2.2 He/They will inspect the works on a regular basis, making on the spot checks and corrections of unsafe acts of Contractor's workmen.
- 1.2.3 He/They will ensure that contractor's workmen are issued with protective equipments and these are work where required. Site staff shall not allow works to commence unless protective equipments are used/work.
- 1.2.4 Project in charge will designate a Crisis Management Team out of the site staff available and members of the Team will be given training in handling a crisis/emergency ( Please refer Para 1.6 below )

### **1.3 Personal Safety Equipment**

Some of the important personal safety equipments are list below : -

- 1.3.1 Safety Helmet - must be worn where works are being carried out at different levels.
- 1.3.2 Safety Belt/Ropes/Safety rules to be used for workmen working at height or on exterior sites of the building.
- 1.3.3 Hand Gloves - to be used for material handling, gas cutter, welding machine etc.
- 1.3.4 Safety Goggles - to be used for arc/gas welding, machine grinding etc.
- 1.3.5 Gumboots/Shoes - to be used for asphaltting works, concreting works etc.

### **1.4 Safety of Work Place**

- 1.4.1 Install adequate number of security lights all over the project site.
- 1.4.2 Provide fire Extinguishers at a suitable locations for fire fighting including sand buckets and water.
- 1.4.3 No electrical wiring shall run on metal poles, scaffolding or metal working platforms. There should be no naked electrical wiring. All wiring must be taken atleast 7 ft.above the ground level.
- 1.4.4 Electrical equipments must be properly earthed.
- 1.4.5 People working in heights must use full body harness and shock absorbing to arrest/prevent fall.
- 1.4.6 Keep all staircases/passages free from materials and obstructions of any kind.

- 1.4.7 Site staff must ensure that hazardous chemicals and petroleum products are stored in a proper manner and such stores are kept locked when not in use.

#### 1.5 First Aid

- 1.5.1 First aid is an immediate and temporary care given to the victim of an accident or sudden illness till the treatment from the doctor is made available. It is important as careless handling of the injured person may increase the severity of the injury and may even cause a death. A Person qualified and trained in first-aid shall be available at work site to render and direct first-aid to casualties. A first-aid kit ( including a stretcher, if feasible ) shall be provided at site and shall be provided at site and shall contain the following items :-

Dressing cotton  
General medicines  
Trinangular bandage  
Roller bandage  
Potassium permanganate  
Dettol.  
Iodine  
Packet of cotton wool  
Burnol  
Snake Bite Kit

#### 1.6 Crisis Management :

- 1.6.1 Site office including that of contractor must display following important telephone nos.

(a) Fire Brigade  
(b) Ambulance  
(c) Police Station  
(d) Nearest Hospital  
(e) Project in charge (land line/mobile)  
(f) Project Coordinator ( - do - )  
(g) Contractor  
(h) Head ( Real Estate )

- 1.6.2 One vehicle alongwith driver must be kept at the work site during sight work/ night work
- 1.6.3 In case of accident, immediate medical attention may save the precious human lives. Shift the affected person to the nearest hospital as soon as possible.
- 1.6.4 In case of fire, try to stop /attack the fire immediately using any means or equipment(s) available. Once fire is spread, it is very difficult to contain it later.
- 1.6.5 Certain site staff including contractor's workmen should be trained to operate and use the various types of fire extinguishers for different kinds of fire e.g. electrical, petroleum products etc. Fire extinguishers must be checked and kept refilled at regular interval.

#### 1.7 Excavatioi :

- 1.7.1 Deep excavations ( above 2 mtrs.) must be barricades and danzer sign posted
- 1.7.2 Sides should be properly sloped ( generally kept at 1.5 ft. horizontal to 1 ft. vertical.
- 1.7.3 Where deep excavation and such other work is in progress, the area should be fenced with sufficient number of notice boards and danger signs.
- 1.7.4 Shoring should be provided wherever required as decided by the Site in charge During rainy season, importance of shoring cannot be over emphasized.

#### **1.8 Storage of Imflammable and Hazardous Chemicals :**

- 1.8.1 Inflammable material e.g Petrol, Diesel and Hazardous chemicals e.g. Chloro-phos etc. must be stored in a safe place under lock and key.
- 1.8.2 Spillage of chemicals on the floor should be avoided. Have a layer of sand to absorb any spillage.
- 1.8.3 Materials which catch fire easily like timber, tyre should not be stacked nearly.
- 1.8.4 Welding works ( Gas/Electric) or any other works requiring open flames including smoking shall not be allowed in the near vicinity.

#### **1.9 Welding Works ( Electric/Gas ) :**

- 1.9.1 Keeping welding leads and burning hose clear of passage ways. All welding apparatus should be equipped with flash back, arrestors. A separate & safe place for welding should be identified by the Site in charge.
- 1.9.2 No welding or burning is to be done on a closed vessel.
- 1.9.3 Welders should be equipped with eye goggles, hand gloves and protective screens to avoid exposure to arc.
- 1.9.4 While lighting a torch for gas welding, open the fuel gas valve before opening the oxygen valve. Use an approved spark lighter. Do not use matches, cigarette lighters etc.
- 1.9.5 Store gas cylinders and hoses where these are not exposed to sparks.
- 1.9.6 Anti-flash back arrestors shall be installed on all fuel gas cylinders.
- 1.9.7 Keep oil and grease away from oxygen regulator, hose and fittings.
- 1.9.8 Do not exceed 15 PSI on the torch side of the gauge when using acetylene.
- 1.9.9 Never do electric welding from a metal ladder.

## **SAFETY MEASURES AT CONSTRUCTION SITE**

### **Section 2 - Civil Work**

## 2.1 Scaffold & Ladders

The accidents from the scaffolds are generally caused by :

- a. Direct collapse of the scaffold
- b. Workmen falling from the scaffold
- c. Material falling from the top of the scaffold.

Great care is, therefore, necessary in the erection, use and dismantling of scaffold with respect to its various components with a view to bring confidence in workman and to avoid any mishaps due to negligence.

2.1.1 Safety measures with regard to scaffold as indicated below, shall be adhered to at site.

- 2.1.1.1 Every scaffold and every part thereof, including supports, shall be of good construction, suitable and sound materials and having adequate strength for the purpose for which it is used.
- 2.1.1.2 All scaffold shall be properly maintained.
- 2.1.1.3 Construction and dismantling of every scaffold shall be under the supervision of a competent person.
- 2.1.1.4 Boards and planks used for the platforms, gangways and runs shall be of uniform thickness, but jointed, closely laid, and securely fasten in place.
- 2.1.1.5 The use of cross braces or framework as the means of access to the working surface shall not be permitted.
- 2.1.1.6 All scaffold shall be securely fastened to the building or structure. If independent of the building, they shall be braced or guyed properly.
- 2.1.1.7 Men shall not be allowed to work from scaffolds during storms or high winds.
- 2.1.1.8 Whenever, workman have to work or constantly pass under a scaffold on which men are working, a screen or other protection shall be provided to catch any falling material.
- 2.1.1.9 All scaffolds shall be examined and approved by Site in charge/Project in charge.
- 2.1.1.10 During dismantling, necessary precautions shall be taken to prevent injury to persons.
- 2.1.1.11 Wet and slippery conditions shall be avoided. The workers shall be cautioned against use of slippery footwear.
- 2.1.1.12 Care shall be taken to see that no part of scaffold is struck by a truck or other heavy moving equipment and no material shall be dumped against it, to prevent any damage.

- 2.1.1.13 Shuttering material should be handled carefully with sufficient manpower to avoid slippage of the material.
- 2.1.1.14 Crack at pin holes in steel props may get sheared off.
- 2.1.1.15 Loose steel pins in steel spans may fold the steel span. Centre steel span pin to be tightened properly. All the points should be checked thoroughly by foreman / shuttering in-charge.

## **2.2 Form Work**

- 2.2.1 Form work shall be designed after taking into consideration spans, setting temperature of concrete, dead load and working load to be supported and safety factor for the materials used for form work.
  - 2.2.2 All timber form work shall be carefully inspected before use and members having cracks and excessive knots shall be discarded.
  - 2.2.3 As timber centering usually takes an initial set when vertical load is applied, the design of this centering shall make allowance for this factor.
  - 2.2.4 The vertical supports shall be adequately braced or otherwise secured in position so that these do not fall when the load gets released or the supports are accidentally hit.
  - 2.2.5 Tubular steel centering shall be used in accordance with the manufacturer's instructions. When tubular steel and timber centering is to be used in combination necessary precautions shall be taken to avoid any unequal settlement under load.
  - 2.2.6 A thorough inspection of tubular steel centering is necessary before its erection and members showing evidence of excessive rusting, kinks, dents or damaged welds shall be discarded. Buckled or broken members shall be replaced. Care shall also be taken that locking devices are in good working order and that coupling pins are effectively aligned to frames.
  - 2.2.7 After assembling the basic units, adjustment screws shall be set to their approximate final adjustment and the unit shall be level and plumb so that when additional frames are installed the tower shall be in level and plumb. The centering frames shall be tied together with sufficient braces to make a rigid and solid unit. It shall be ensured that struts and diagonal braces are in proper position and are secured so that frames develop full load carrying capacity. As erection progresses, all connecting devices shall be in place and shall be fastened for full stability of joints and units.
- 
- 2.2.8 Centering layout shall be made by a qualified engineer and shall be strictly followed. The bearing capacity of the soil shall be kept in view for every centering job. The effect of weather conditions shall also be taken into consideration as dry clay may become very plastic after a rainfall and show marked decrease in its bearing capacity.

2.2.9 All centering shall be finally, inspected to ensure that :

Footings under every post of the centering are sound.

All lower adjustment screws or wedges are snug against the legs of the panels.

All upper adjustment screws or heads of jacks are in full contact with the form work.

Panels are plumb in both directions.

All cross braces are in place and locking devices are in closed and secured position.

In case of Chhajja's and balconies, the props shall be adequate to transfer the load to the supporting point.

2.2.14 During pouring of the concrete, the centering shall be constantly inspected and strengthened, if required, wedges below the vertical supports tightened and adjustment screws properly adjusted as necessary. Adequate protection of centering shall be secured from moving vehicles or swinging loads.

2.2.15 Forms shall not be removed earlier than as laid down in the specifications and until it is certain that the concrete has developed sufficient strength to support itself and all loads that will be imposed on it. Only workmen actually engaged in removing the form work shall wear helmets, gloves and heavy soled shoes and approved safety belts if adequate footing is not provided above 2 m level. While cutting any tying wires in tension, care shall be taken to prevent backlash which might hit a workman.

2.2.16 The particular order in which the supports are to be dismantled should be followed according to the instructions of the site engineer.

2.2.17 Steel - Except in cases where particular properties are necessary, weldable structural conforming to the Indian Standards should be used in false work for both forms and supports : -

IS : 226-1969, IS : 800-1962 & IS : 806 - 1968

Welding work for the mild steel false work should be carried out in accordance with IS:816 - 1970. The permissible stresses should be assumed as given in IS : 800 -1962 and IS : 806-1968

2.2.18 An experienced team of supervisors and carpenters to watch the behaviour of false work during application of loads must be detailed during execution of work.

2.2.19 Crash striking of large areas of form works should never be allowed. It may damage the structure and can cause accident.

## **2.3 Concrete Work**

2.3.1 Heavy column reinforcement cage may collapse. Proper measures should be taken.

2.3.2 During the placing of steel forms for columns/beams walls form side may slip from worker

and may collapse on or below and injury may be caused.

Remedial Action : Careful handling of steel forms and also inform the workers working below.

- 2.3.3 Plumb bob should be carefully used.
- 2.3.4 Clamps/Pin of column/beam shuttering may slip from position and fall below, proper handling & lightning required.
- 2.3.5 When erecting forms, placing reinforcement and delivering concrete mix to where it is laid, particular care should be taken to provide reliable supporting scaffolding, planking, stairs, guard rails, barriers and slinging devices for lifting framed constructions, form and reinforcement units.
- 2.3.6 Appropriate measures should be taken to ensure the rigidity of forms & scaffoldings.
- 2.3.7 In concreting, attention should be focused on adequate precautions against accidental electrocution. Housing of vibrators should be earthed as well. It should be remembered that despite a relatively low voltage, operation of vibrators without due regard to safe practices may involve a risk of electrocution.
- 2.3.8 Strict conformance to safe practices is also essential in the operation of concrete mixing machines, concrete pumps and other machinery.

## **SAFETY MEASURES AT CONSTRUCTION SITE**

### **Section 3 - Electrical**

### **3.0 Electrical**

- 3.1 Electricians should be familiar with the grounding practices, code requirements, and electrical standards commonly encountered in their work.
- 3.2 Deviations from standard practice should be discussed with the Foreman.
- 3.3 Electricians should always work from non-conducting surfaces - never from metal ladders or platforms.
- 3.4 Safety hats, rulers and whenever possible, other tools should be non-conducting.
- 3.5 Electricians are not to work on live circuits at any time.
- 3.6 The switch controlling a building circuit or an equipment circuit must be opened and tagged out by individual undertaking alterations or repairs to those circuits. The circuit should then be tested with a suitable instrument to prove that it is dead before work is started.
- 3.7 Hold off tags on opened switches must never be removed by anyone other than the individuals who attached them.
- 3.8 A tagged open main breaker should not be closed again until everyone in the vicinity of all portions of the circuit has been determined to be in the clear.
- 3.9 Opened panel and similar live equipment around an electrical job can create a hazard to others working in the area or passing by. The electrician must protect these people by using appropriate barriers and/or warning signs.

## **SAFETY MEASURES AT CONSTRUCTION SITE**

### **Section 4 - Equipment's**

## **4.0 Equipment's**

### **4.1 Concrete Mixers**

- 4.1.1 All gears and roller of concrete mixers shall be adequately guarded to prevent danger.
- 4.1.2 Hoppers into which a person could fall and revolving plates and trough or batch type mixers shall be adequately guarded.
- 4.1.3 Concrete mixers skips shall be protected by side railing to prevent workers from passing under them and operators shall make sure that before lowering the skip, all workers are in the clear.
- 4.1.4 Only well trained operators, who understand all the operations of mixers, should be employed for handling the concrete mixers.
- 4.1.5 When workman are cleaning the inside of the drums, power of the mixers shall be locked in the off position and all fuses shall be removed and a suitable notice hung at the place.

### **4.2 Concrete Vibrators**

- 4.2.1 Vibrating units shall be completely enclosed and belt transmitting the power to the unit adequately guarded.
- 4.2.2 Vibrating needless of poker type vibrators shall be completely sealed against concrete.
- 4.2.3 Electrically operated vibrator shall be totally enclosed units.
- 4.2.4 Air operated vibrators shall have arrangements to change the speed of rotating shaft and air motor to rotate the vibrating needle which shall be completely sealed against concrete.
- 4.2.5 Power operated vibrator shall be provided with effective means of stopping the vibration, if possible by disengaging the vibrator from the engine motor drive.
- 4.2.6 Where possible, the vibrator shall be fitted with shock absorbing handles with rubber or other suitable grips for ease in handling.
- 4.2.7 Electrically operated vibrators shall be protected against overload by suitable overload relays and shall be effectively earthed. Where the operator has to be in direct contact with the vibrator during its operation, low voltage drive with suitable transformer is recommended.

- 4.2.8 While starting the poker vibrators, the needle shall not be resting on a hard surface to avoid bouncing.
- 4.2.9 Excessive bending of the flexible shafts of the poker vibrators while in operation shall be avoided.
- 4.2.10 Electrical connections to electrically operated vibrators shall be well maintained and short circuiting with the steel reinforcements should be avoided.

### **4.3 Construction Machinery**

- 4.3.1 All other construction machinery viz. earth moving, lifting & hoisting, power shovels, cranes, motor trucks, trawlers, road rollers etc. shall be maintained and operated as per manufacturer's instructions and safety precautions shall be rigidly followed. IS:7293:1974 " Safety Code for Working with Construction, Machinery " shall be referred with regard to safety precautions for working with these machines.

# **Annexure II**

**DAKSHIN HARYANA BIJLI VITRAN NIGAM**

**( Govt of Haryana Undertaking )**

**Office of Sub-Divisional Officer Operation**

**Sub Division DHBVN, Badshahpur.**

**Tel.No.0124-2361238, Mob-9540954904.**

**Email: sdobadshahpur@gmail.com**

---

**To,**

Unitech Limited,  
Unitech House, Block-L,  
South City-1, Gurgaon-122101.

**Memo No:- 2339**

**Date:- 8-10-15**

**Sub: Assurance letter for releasing the load 20844 KW for commercial colony measuring 15.00 acre (License No.29 of 2009 dated 24.06.2009) in sector-69, Gurgaon.**

**Reference: - your letter on dated 08.10.2015.**

In this connection it is intimated that this office will release the electricity connection as per the prevailing norms and terms and condition of the DHBVN and availability of load at that time when you will apply for load.

  
**S/O 'OP' S/Divn  
DHBVN, Badshahpur**

---

**AREA = 15 ACRES**

TOTAL LOAD(MVA)

# **Annexure III**

# DUAL PLUMBING PLAN

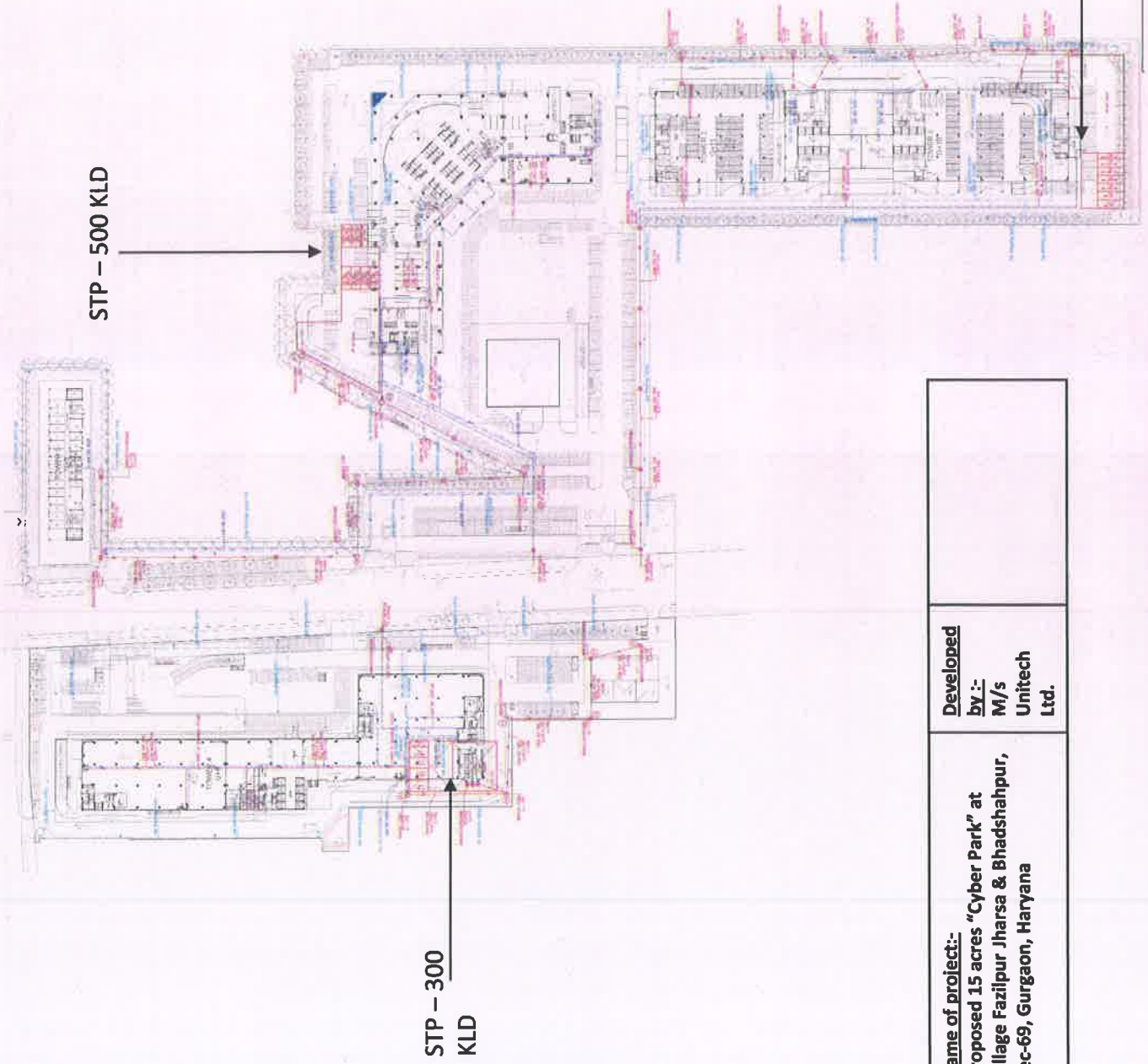

SEWER LEGEND	
GT	GULLY TRAP 300x200
MH	SEWER MANHOLE 900x900
MH	SEWER MANHOLE 1200x900
MH	SEWER MANHOLE 1300x900 DIA
MH	SEWER MANHOLE 1500x900 DIA
	SEWERAGE LINE
	100% STP OVER FLOW PIPE
	SOIL LINE
	WASTE LINE

	WATER SUPPLY LEAD IN
	FLY HOLE WATER RISER PIPE
	SOFT WATER SUPPLY RATER PIPE
	IRRIGATION LINE
	CAPTION HOBRANT

<p><b>Name of project:-</b> Proposed 15 acres "Cyber Park" at Village Fazilpur Jharsa &amp; Bhadshahpur, Sec-69, Gurgaon, Haryana</p>	<p><b>Developed by:-</b> M/s Unitech Ltd.</p>
---	---

# **Annexure IV**

# RAIN WATER HARVESTING SCHEME

SOIL TYPE	Silt Loam
NUMBER OF PITS	15 no.
SIZE OF PITS	3.3 m dia and 3.0 m depth
INFILTRATION RATE	15.2 mm/hr.
POROSITY	38.5 %
GROUND WATER LEVEL	23.1-24.5 m
ANNUAL RAINFALL	723 mm
PEAK HOURLY RAINFALL	45 mm/hr.

## RAIN WATER HARVESTING CALCULATION :

S.No.	Description of Area	Area Considered (Sq. M)	Harvesting Factor / Collection Efficiency per area	Retention time for recharge tank (in minutes) (Peak hourly: 45 mm/hr)	Total Volume of Water for Rain Water Harvesting (Cubic Mtrs) (Peak)
1	Water Available from Terraces of buildings and other roof-top surfaces	14795.51	0.85	11	138
2	Paved Surfaces, Roads & other Built-up Areas	30057.94 sqm	0.65	11	215
3	Lawns, Gardens & all other Open Areas	15849.3 sqm	0.20	11	35
	<b>GRAND TOTAL</b>	<b>60702.75 sqm</b>			<b>388 cubic mt</b>

# MAIN WATER LAYOUT

## DIAOGRAM

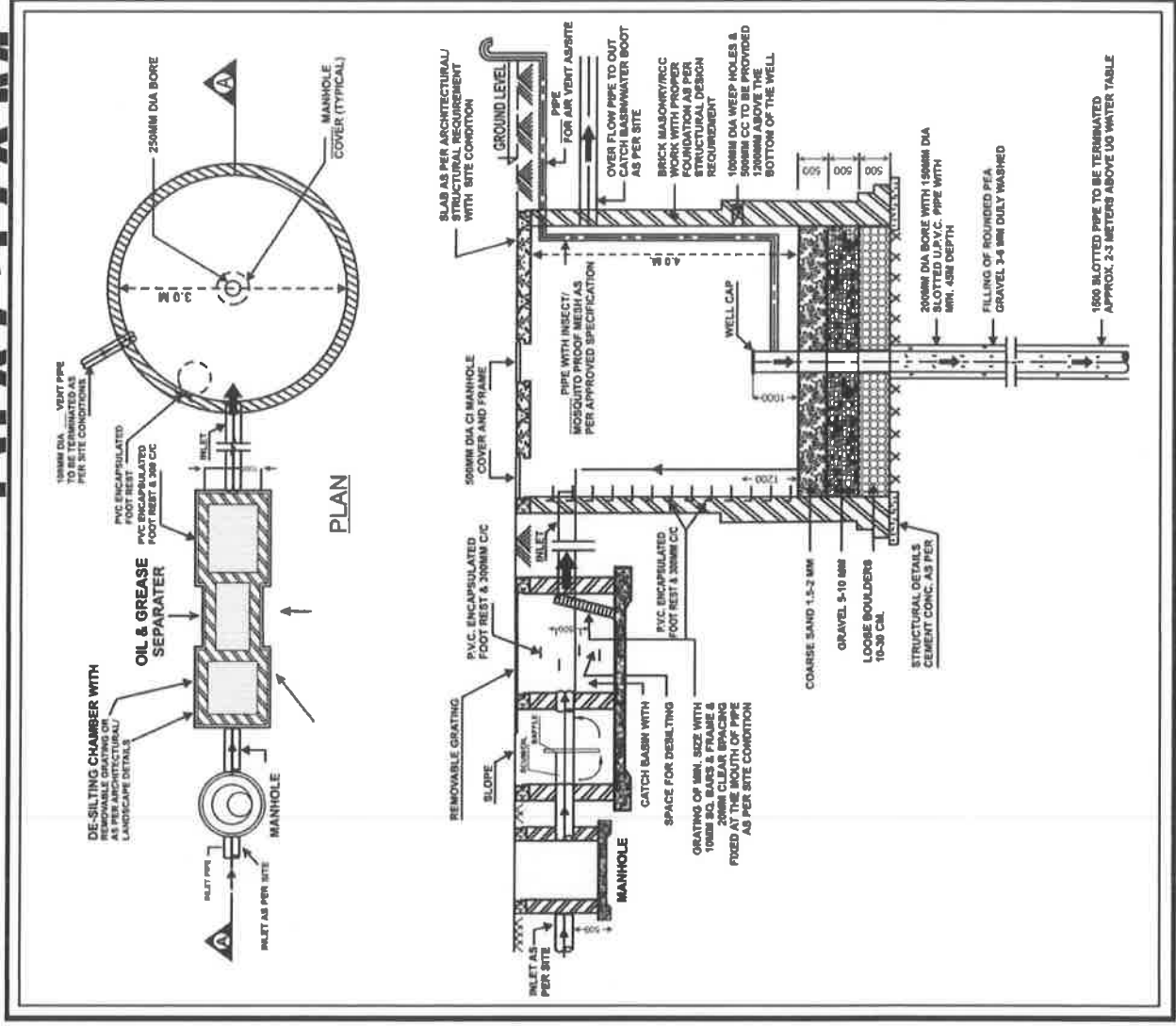

SIZE OF PITS	3.3 m dia and 3.0 m depth
--------------	------------------------------

# RAINWATER HARVESTING PLAN

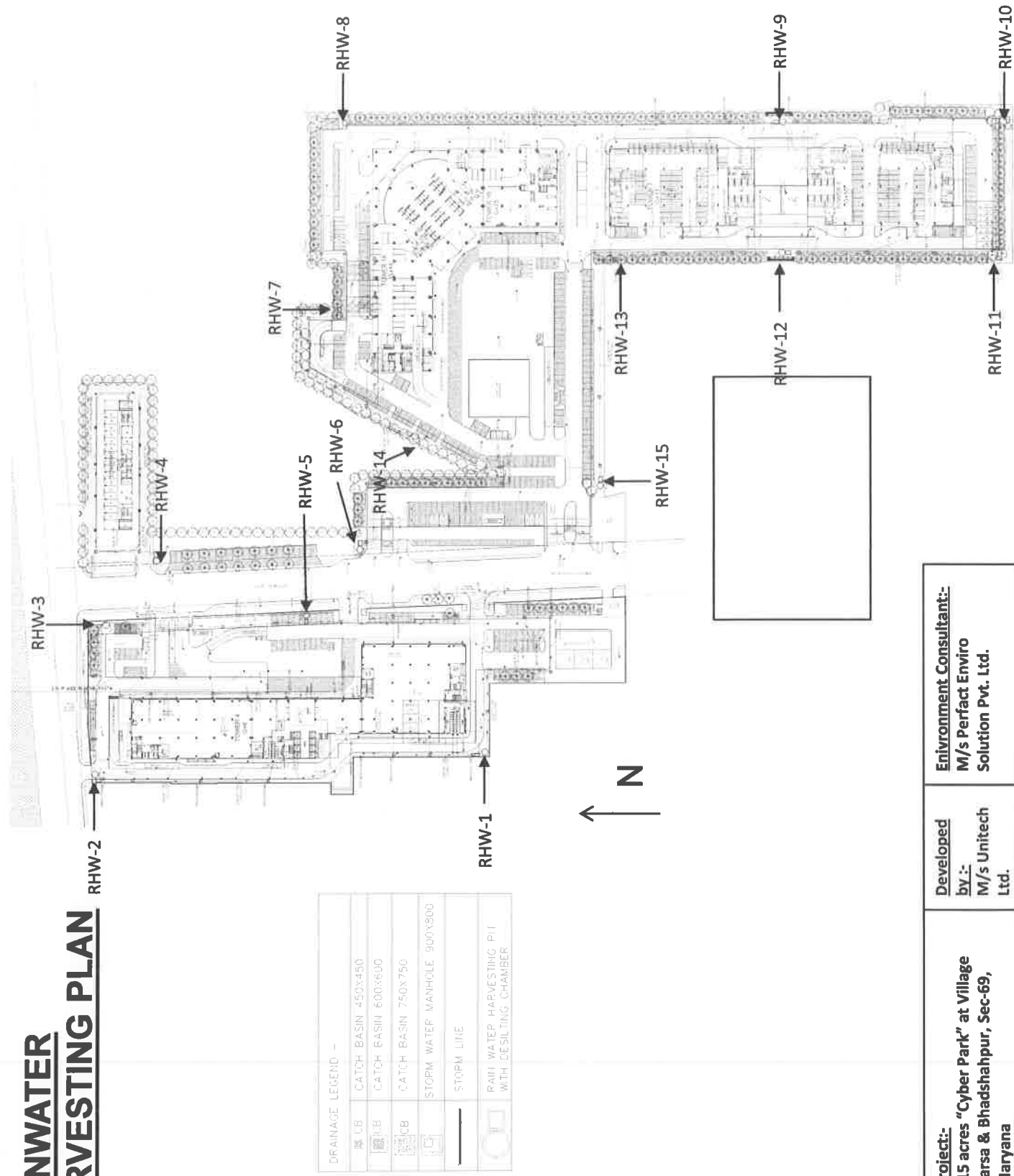

<b>Name of project:-</b> Proposed 15 acres "Cyber Park" at Village Fazilpur Jharsa & Bhadshahpur, Sec-69, Gurgaon, Haryana	<b>Developed by :-</b> M/s Unitech Ltd.	<b>Environment Consultant:-</b> M/s Perfect Enviro Solution Pvt. Ltd.
---	---	---

# **RAIN WATER HARVESTING PII**

## **MAINTNANCE PLAN**

- **Points to be considered for implementation and maintenance of Artificial recharge Structures**
- All the storm water drains will be kept clean. Connection of down spouts will be provided wherever required so as diverting the runoff to the structures.
- No contaminated water will be diverted into the storm water drains. Necessary peripheral drains will be constructed to divert the runoff to the recharge structures.
- Before the onset of the monsoon all the catchment area considered for recharge will be cleaned. The recharge structures will be in operation during the monsoon season only so as to avoid any contamination.
- A mesh will be provided on the mouth of the inlet to discard the debris entering into the recharge pit. A sluice/ shutter will be provided to ensure that no water other than rainwater is diverted to the recharge structure.
- Depth and location of the recharge wells may vary slightly as per the prevailing site conditions.
- After the first rain the de-silting pit will be cleaned and subsequently on the onset of next monsoon. A hygienic condition in the area would be maintained after implementation of artificial recharge structures, as the recharged water will augment the water level in the proposed tubewells. Depth of the retaining capacity of the recharge trenches (as per the enclosed designs) is below the proposed inlet pipes. All the dimensions indicated in the designs are the inner dimension.
- Harvesting pit shall be cleaned 4 times in year. All filter media shall be cleaned properly

# **Annexure V**

# ELECTRIC LOAD DETAILS & U,R & K VALUES

Description	Area of plot in Acres	FAR in Sqm	Load per unit in KW	Total Load in KW	Diversity Fator- 0.6	Maximum Demand Load in KW	Total Maximum Demand at P.F. @ 0.9 (KVA)
Cyber Park	15	148885.4	21 KW/100 sqm	31265.934	0.6	18759.560	20843.956
Total in KVA							20843.96 KVA say 20844 KVA

Analysis of the thermal properties of the Wall, Glass and Roof										
Wall										
Thickness	Specific (Cp)	Heat	Density Lb/ft3	K Value	R	Value	U	Value	U	Value in
230 mm thick brick wall	0.84 J/g.k		120	3.15			1.98			Btu/hr.ft2 °F
U value of the wall Assembly for the designed case=1.98 w/m2 C=0.35 Btu/hr/ft2 °F.										
As per ECBC requirement the U Value of the wall assembly=U-0.440 w/m2 C=0.077 Btu/hr/ft2 °F.										
Glass										
Glass Type	U value W/(m.K)	in	U	Value	in	SHGC	SC	Value	U	Value
Double Glazing	1.8		0.32			0.2523	0.29			39%
As per ECBC requirement										
Glass Type	U value W/(m.K)	in	U	Value	in	SHGC	SC	Value	U	Value
Double Gaging	3.29		0.581			0.25	0.29			25%
ROOF										
Roof assembly	Specific (Cp)	Heat	Density Lb/ft3	K Value	R	Value	U	Value	U	Value in
175 mm thick roof slab	0.88 J/g.k		45	1.86335404			1.7			Btu/hr.ft2 °F
70 mm	1500 J/g.k		36±2	0.21		18.93	0.3			0.053
U value of the combined roof assembly for designed case=2.55 w/m2 C=0.45 Btu/hr. ft2 °F										
As per ECBC requirement the u value of the roof assembly =U-0.4 w/m2 C=0.072 Btu/hr. ft2 °F										

Proposed 15 acres "Cyber Park" at Village Razipur Jharsa & Bhadshapur, Sec-69, Gurgaon, Haryana, By: M/s Unitech Ltd.

# **Annexure VI**

Permit No.....1680.....

w.e.f 25.05.16 to 24.11.2016

**Standard for permits for the grant of permission for disposal of mineral extracted incidental to developmental activities**

Whereas Sh./ Messers M/s Unitech Ltd . Through Sh. Sameer Singh R/o Unitech house L Block South City 1 Gurgaon . has applied for the grant of a short term permit under rule 27 to 35 of the Haryana Minor Mineral Concession, Stocking & Transportation of Minerals and Prevention of illegal Mining Rules 2012, for disposal of 183316 MT of Ordinary Clay excavated / removed from Sector 69, Village Badshapur , Gurgaon , digging of foundation/basement . The applicant has paid royalty and application fees in advance amounting to Rs. 803423/- vide D.D.No. 514746 dt. 07.05.16 & Security amount is Rs. 401712/- vide D.D.No. 514747 dt. 07.05.16 (50% of the amount of royalty).

- 2 The permission is hereby granted for disposal of 183316 MT mineral Ordinary Clay excavated / removed from the aforesaid area subject to the conditions that the permit holder will abide by the safety guards for such excavation or removal.
3. The permit holder shall transport/disposal off the ordinary clay/ earth from the site of the excavation , only by issuing a Mineral Transit Pass.
4. The amount of security deposit shall entail no interest. The security amount shall be refunded within a period of three months in case the same is not forfeited or required to be detained for any other purpose under this permit.
5. Any sum due from the permit holder shall be recovered from him as an arrear of land Revenue.

The permission shall be valid up to 24.11.2016.

Memo No. 1151

Dated 24/5/16

  
Assistant Mining Engineer  
Dept. of Mining Geology  
Gurgaon / Mewat

# **Annexure VII**

**OFFICE OF THE EXECUTIVE ENGINEER, HUDA, DIVISION NO V, GURGAON**

To

M/s Lanndscape Builders Ltd. and Others,  
C/o Unitech Ltd. Block-L,  
South City-I, Gurgaon

Memo No.

1703

Dated

11/2/16

**Sub:** Assurance of sewerage connection for discharge of treated water 925 KLD surplus domestic effluent after commissioning of Cyber park project at Village Badshapur, Sector-69, Gurgaon. (Licensed No. 29 of 2009 dated 24.06.2009 area measuring 15.00 Acres)

**Ref:** Your office memo No. UL/69(69)/2016/31 dated 08.02.2016.

In this regard it is submitted that the Sewerage connection in HUDA master Sewer line for discharge of 925KLD surplus treated domestic effluent of Cyber park project at Village Badshapur, Sector-69, Gurgaon. (Licensed No. 29 of 2009 dated 24.06.2009 area measuring 15.00 Acres) could be given after completion of the Master Sewer line in the area for which the scheme of providing Master Sewerage already stand approved.

The Sewerage connection for your above said project for discharge of treated waste water will be accorded after completion of the Master sewerage network and after obtaining the completion certificate from the Director Town & Country Planning Haryana Chandigarh.

This is for your information and further necessary action, please.

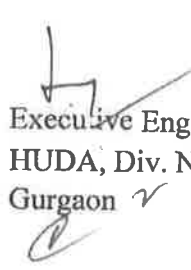
  
Executive Engineer,  
HUDA, Div. No. V,  
Gurgaon

# **Annexure VIII**



**OFFICE OF THE EXECUTIVE ENGINEER HUDA DIVISION. NO. III GURGAON**

To

M/s Unitech Ltd,  
Unitech House, Block-I.,  
South City-I,  
Gurgaon - 122001.

*Memo. No 20455*

*Dated 3/12/15*

**Sub: -** Status of supply of HUDA water (1524 KLD) to our Cyber Park Project admeasuring 15.00 Acres at Sec-69, Gurgaon (License No. 29 of 2009 dated 24.06.2009).

**Ref:-** Your application no. UL/69(69)/2015/339 dated 21.11.2015.

It is intimated that the master water supply available on the sector dividing road 69 of Gurgaon and sufficient water <sup>1524 KLD for the above project</sup> is available in these sectors.

You are requested to apply the water connection after collecting the water supply connection form from the undersigned office, so that further action could be taken.

**EXECUTIVE ENGINEER,  
HUDA DIV. NO. III,  
GURGAON**

**Endst No.**

**Dated**

A copy of the above is forwarded to Sub Divisional Engineer, HUDA, Sub Div No. X, Gurgaon w.r.t. his office memo no. 3164 dated 27.11.2015 for information.

**EXECUTIVE ENGINEER,  
HUDA DIV. NO. III,  
GURGAON**

# **Annexure IX**

# WATER MANAGEMENT

<b>SOURCE OF WATER</b>	HUDA
<b>TOTAL WATER REQUIREMENT</b>	1174 KLD
<b>FRESH WATER REQUIREMENT</b>	340 KLD
<b>TREATED WATER REUSE</b>	834 KLD
<b>TOTAL WASTEWATER GENERATED</b>	878 KLD
<b>STP CAPACITY</b>	500 KLD, 300 KLD & 200 KLD

S No.	Particulars	Population	Rate/Water Demand	Fresh Water Requirement	Treated Water Requirement	Total Water Requirement	Waste Water Generation
1	IT Office staff	21188	45	317.82	635.64	953.45	826.325877
2	Visitors	2119	15	12.71	19.07	31.78	27.3323175
3	Maintenance & Security Staff	636	45	9.53	19.07	28.60	24.7897763
4	Green Area	15849.3	@4 l/m	0	63.40	63.40	
5	DG Set & HVAC Cooling				97	97.00	
	<b>Total</b>			<b>340.06</b>	<b>834.17</b>	<b>1174.24</b>	<b>878.45</b>

# WATER BALANCE

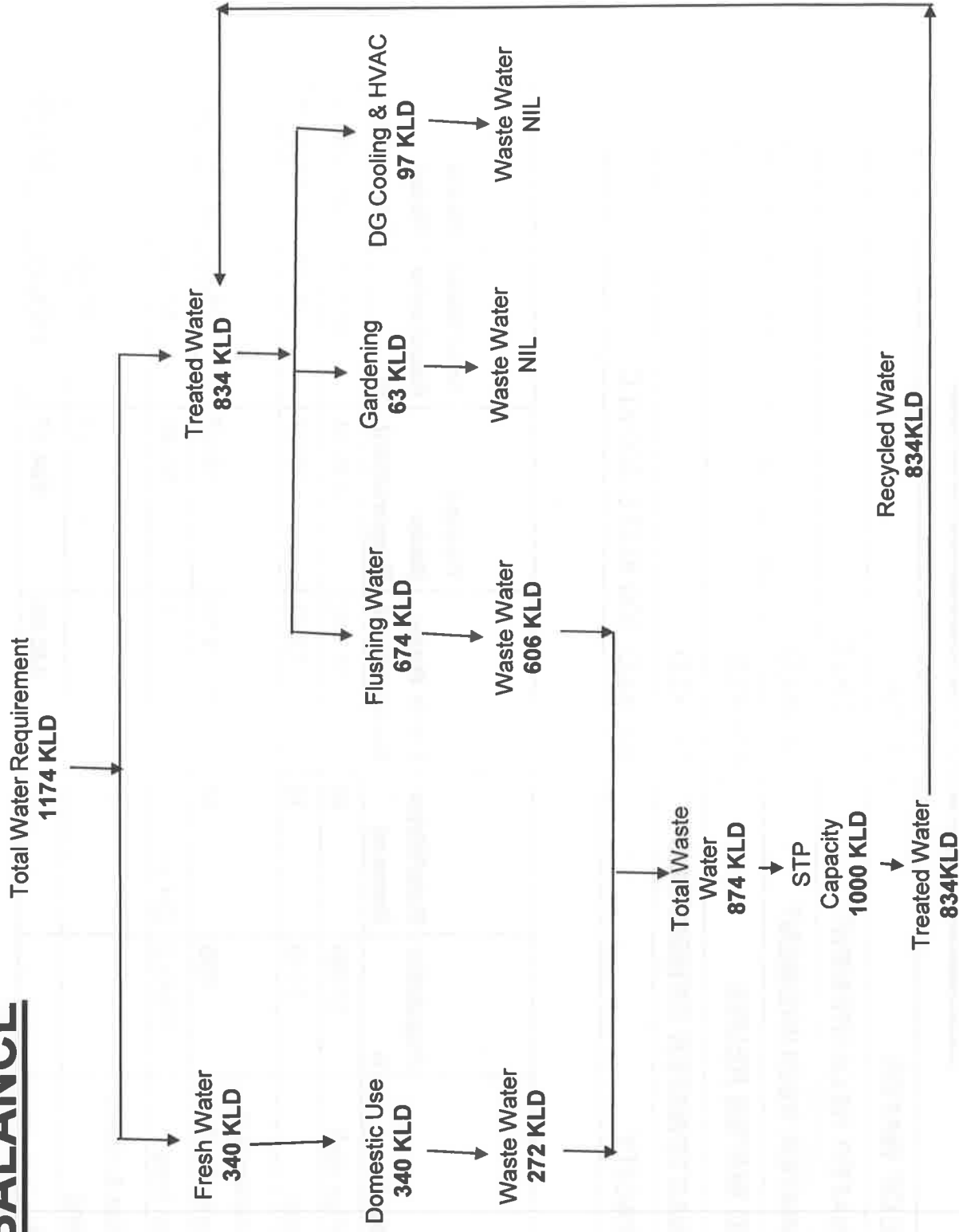

# **Annexure X**

# **WASTE MANAGEMENT**

<b>MUNICIPAL SOLID WASTE</b>				
<b>Type of Waste</b>	<b>Colour of Bins</b>	<b>Category</b>	<b>Disposal Method</b>	<b>Total Waste (Kg/day)</b>
<b>Organic Waste</b>	Green	Bio Degradable	The waste will be sent to Organic Waste Converter for conversion into compost. The compost shall be used as manure in green area within the project premises & unused manure shall be given to nursery.	3968
<b>Recyclable Items</b>	Blue	Recyclable	Approved Recycler	1700
<b>Total</b>				<b>5668 Kg/day</b>

<b>HAZARDOUS WASTE</b>				
<b>Type of Waste</b>	<b>Colours of Bins</b>	<b>Category</b>	<b>Disposal Method</b>	<b>Total Waste</b>
Used Oil	Black With Label	Hazardous Waste	Waste shall be collected in leak proof containers at isolated place and then it will be given to approved vendor of CPCB as per Hazardous Wastes (Management, Handling and Transboundary Movement) Rules, 2008 and Amended till date.	188 lt/month
Electronic	Black With Label	Hazardous Waste	It will be disposed off through approved vendor of CPCB as per Electronic Wastes (Management & Handling) Rules, 2011.	2-3 kg/day

- Battery waste will be generated from inverters & UPS, which shall be treated as per the Batteries (Management & Handling) Rules 2001

# 

#### SIZES AND SPECIFICATION OF ORGANIC WASTE CONVERTER:

Model No.	Capacity per Batch	Power	Dimension(L x W x H)
OWC-500	170 Kg/batch	16 HP	2.03 m x 1.37 m x 1.65 m

Biodegradable Waste	Batch Capacity	Curing Capacity	Time Taken	No of Batch
1716 kg/day	170/batch	200 kg/Batch	Machine Time= 15-20 m Total Time=1 hr	10 batch/day

Curing capacity: 200 kg/batch

Time take per batch: 15-20 min., Total time per batch: 1hr.

Capacity of curing batch: 6.0 mx1.2 m x1.2 m = 8.64 m3

Dimensions of OWC = 2.03 m x 1.37 m x 1.65 m = 4.58 m3

Space provided: 80 sqm

# **Annexure XI**

# PARKING MANAGEMENT

## Parking Requirement:

- Parking requirement = 3722 ECS
- Parking proposed = 4191 ECS

Parking provision will be done as follows,

## Parking Provision:

Parking Provision	Total area (In sqm)	Basement area	service area (In sqm)	Parking area (In sqm)	Factor (In sqm)	ECS Provided (In sqm)
Basement	132471.25		13016.25	119455	35	3413
Stilt Parking				3960	30	132
Surface Parking area				16150	25	646
Total ECS provision						4191 ECS

# SURFACE PARKING PLAN WITH TRAFFIC

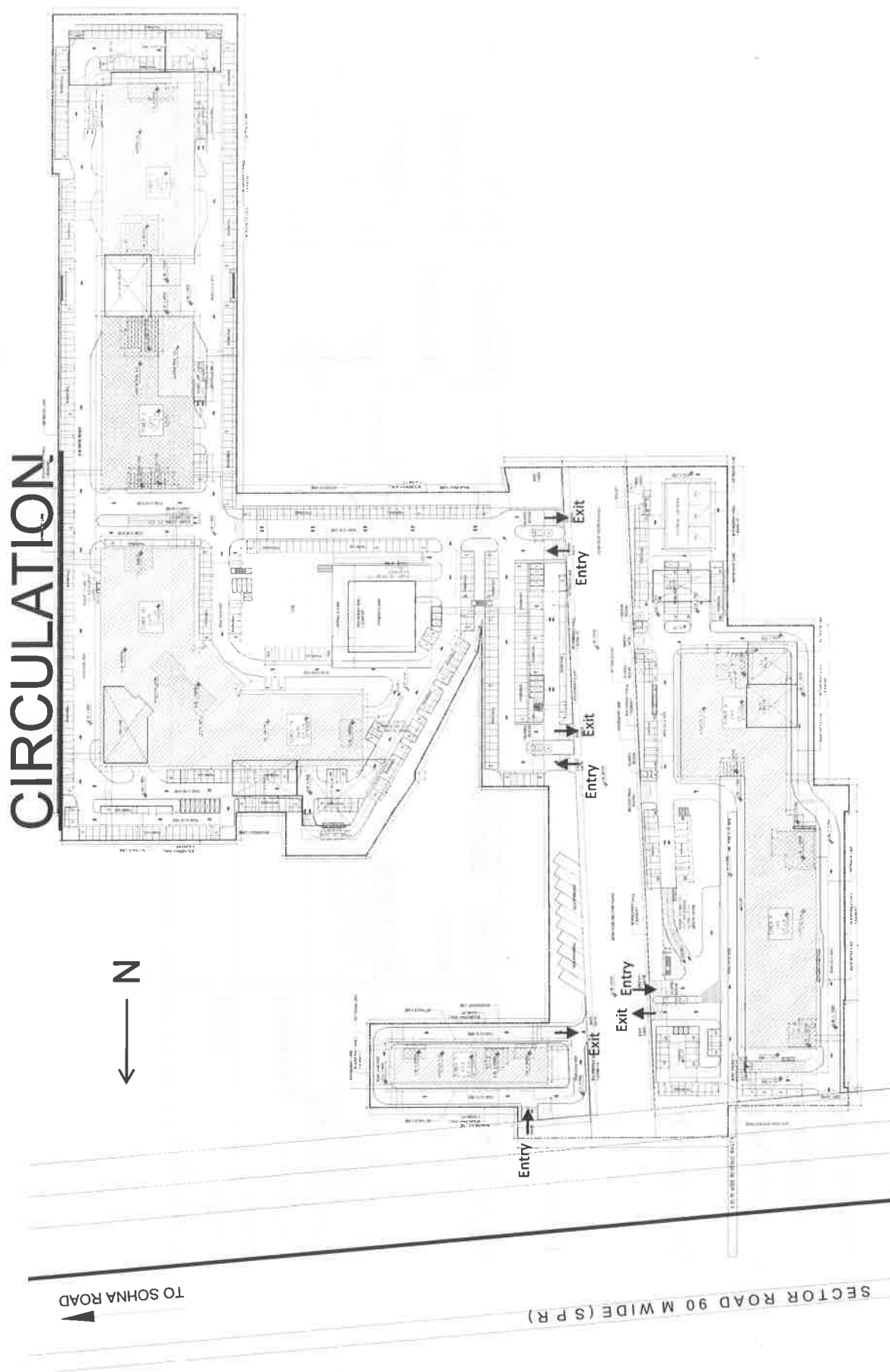

**Name of project:-**  
**Proposed 15 acres "Cyber Park" at Village Fazilpur Jharsa & Bhadshahpur, Sec-69, Gurgaon, Haryana**

**Developed by :-**  
**M/s Unitech Ltd.**

**Environment Consultant:-**  
**M/s Perfect Enviro Solution Pvt. Ltd.**

# BASEMENT PARKING PLAN

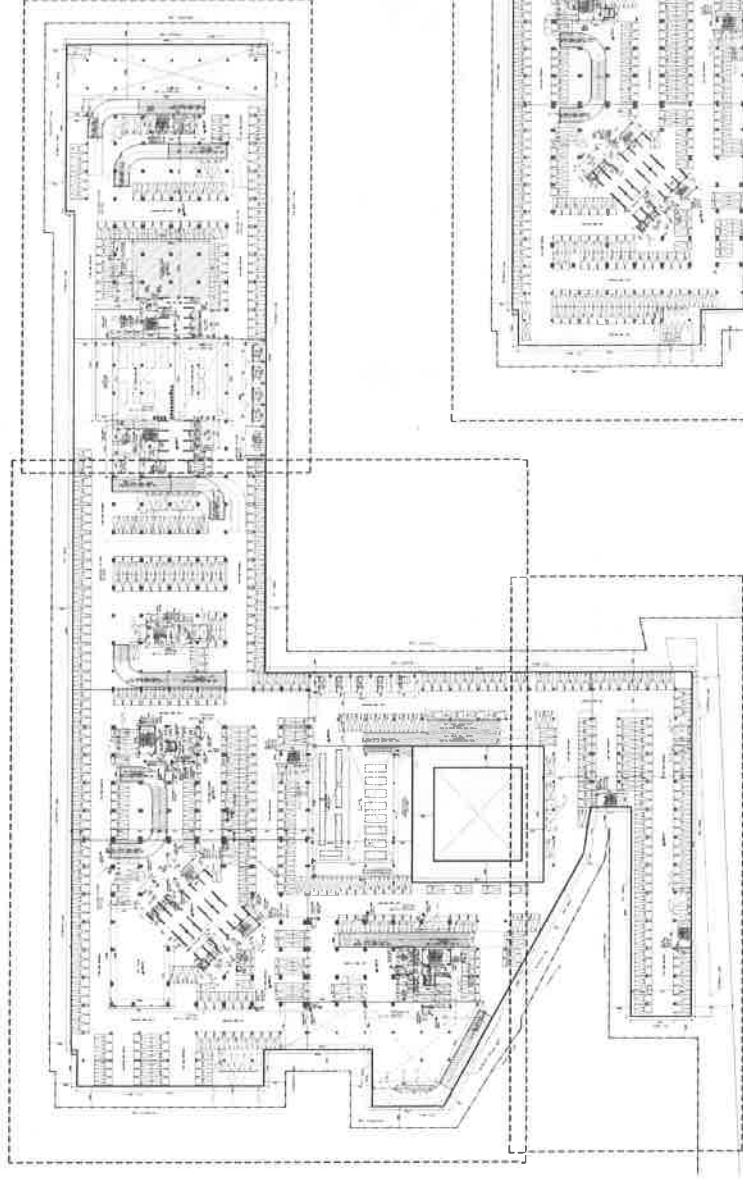

Tower 1A, 1B, 2 & 3 – 1<sup>st</sup>  
Basement Plan

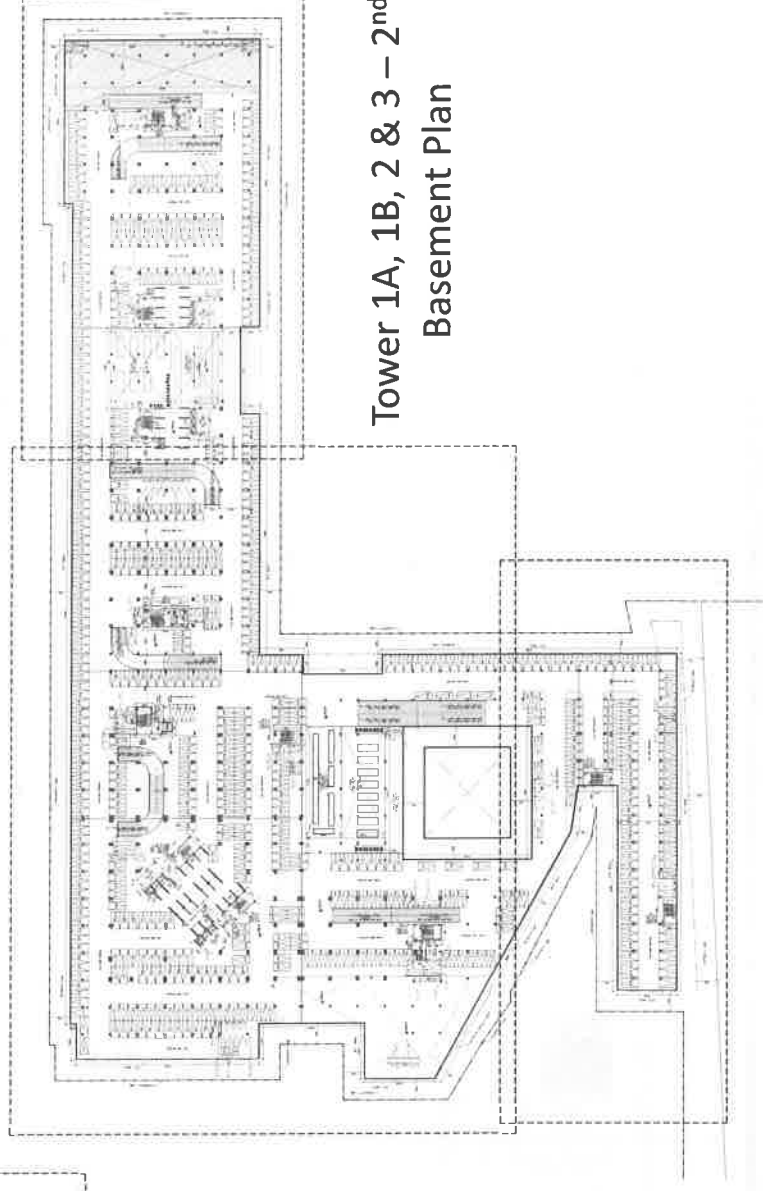

Tower 1A, 1B, 2 & 3 – 2<sup>nd</sup>  
Basement Plan

# BASEMENT PARKING PLAN

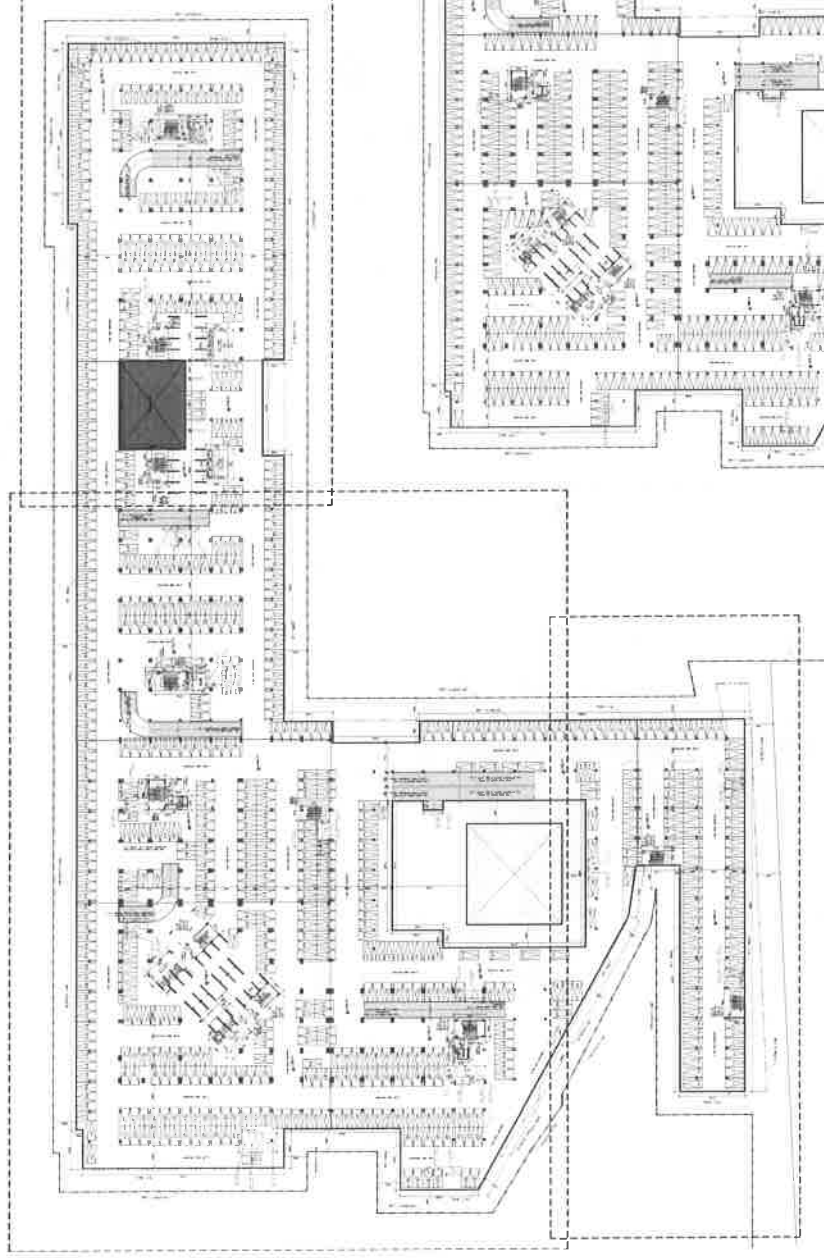

Tower 1A, 1B, 2 & 3 – 3<sup>rd</sup>  
Basement Plan

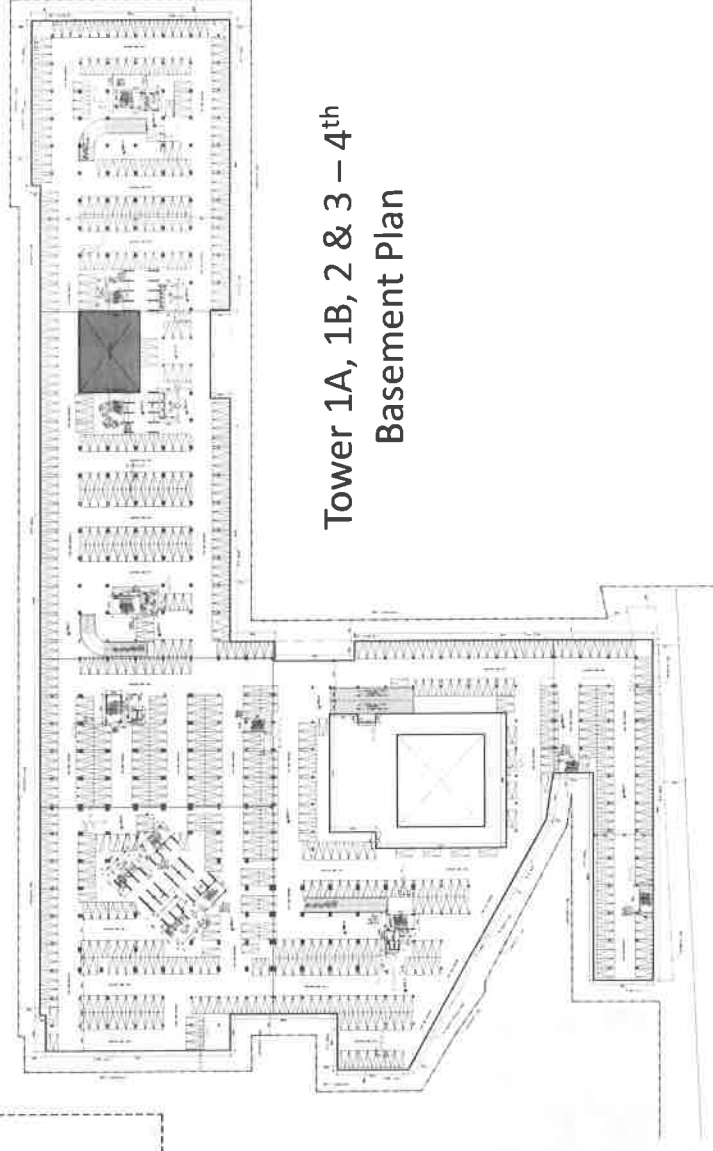

Tower 1A, 1B, 2 & 3 – 4<sup>th</sup>  
Basement Plan



# BASEMENT PARKING PLAN

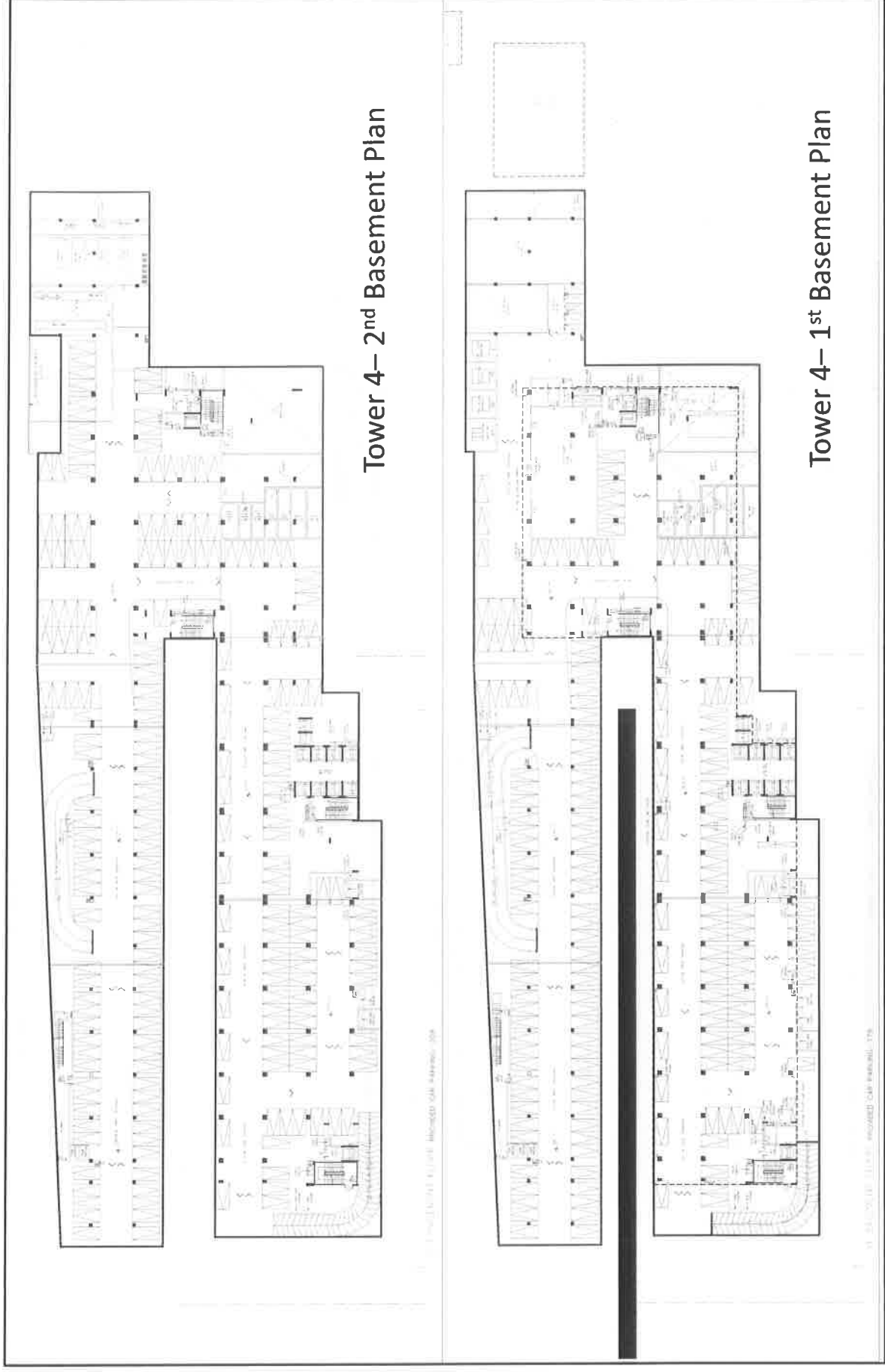

# BASEMENT PARKING PLAN

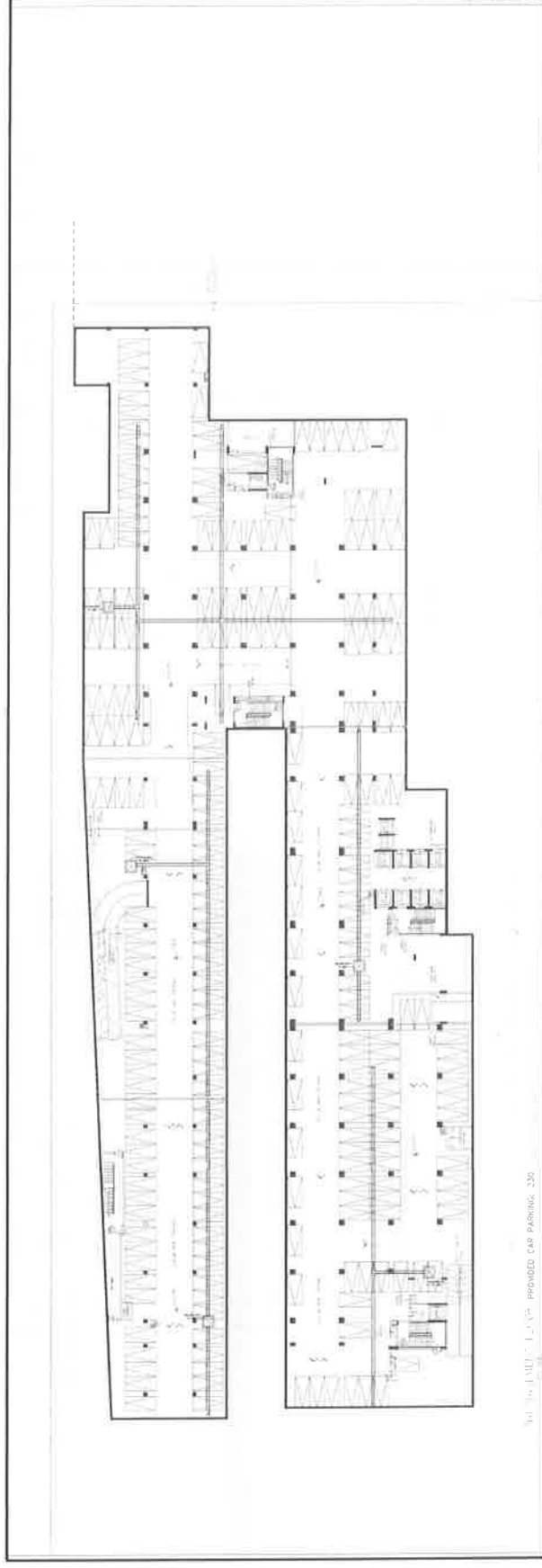

Tower 4- 3<sup>rd</sup> Basement Plan

# **Annexure XII**

**AMENDMENT NO. 2 SEPTEMBER 2015  
TO  
NATIONAL BUILDING CODE OF INDIA 2005  
(SP 7 : 2005)**

This amendment amends the provisions of Part 4 'Fire and Life Safety' of the Code, as follows:

(Page 24, **clause 3A.11.2**) — Delete.

(Page 26, **clause 3A.19**) — Substitute the following for the existing clause:

**3A.19** Glass of facade used in external walls shall comply with the following:

- a) For fully sprinklered buildings having fire separation of 9 m or more, tempered glass in a non-combustible assembly, with ability to hold the glass in place, shall be provided. It shall be ensured that sprinklers are located within 600 mm of the facade glass providing full coverage to the glass.

NOTE — In case of all other buildings, fire resistance rating of glass facade shall be in accordance with Table 1

- b) All gaps between floor-slabs and facade assembly shall be sealed at all levels by approved fire resistant sealant material of equal fire rating as that of floor slab to prevent fire and smoke propagation from one floor to another.
- c) Facade glass at each floor shall have means to open at least 10 percent of the total facade area to exhaust smoke during emergencies. Such openings, with sill level at 1.2 m, shall be in the form of openable panels of size not less than 1 500 mm x 1 000 mm opening outwards.

(Page 27, **clause 4.6.2, first sentence**) — Substitute the following for the existing sentence:

\*All buildings, as follows, shall have a minimum of two staircases:

- a) Buildings 15 m in height or above, and
- b) Irrespective of height of the building(s), the buildings used as business, educational, assembly, institutional, industrial, storage and hazardous occupancies and mixed occupancies having floor area more than 500 m<sup>2</sup> on any floor.

(Page 28, **clause 4.8.3**) — Insert the following at the end of the clause:

‘except for the areas required to be pressurized.’

(Page 34, **Fig. 3, Title**) — Substitute the following for the existing title:

‘FIG. 3 TYPICAL ARRANGEMENT OF WET RISER AND TOTAL SPRINKLER SYSTEM OF BUILDINGS’

(Page 42, **Table 23, Note 11**) — Substitute the following for the existing note:

**11** To be installed in entire building.’

(Page 43, **Table 23, Note 23**) — Insert the following new Note at the end, in supersession to the requirements regarding provisions on water supply and pump capacity for buildings of height 35 m or more:

# **Amendment No. 2 to SP 7 : 2005**

**\*24** For Residential Buildings, Dormitories (A-3) and Apartment Houses (A-4), building or group of contiguous buildings under a common ownership/management, the requirement of water storage and pumping shall be as follows:

Sl No.	Height of Building or of Tallest Building in a Group of Buildings	Water Supply		Pump Capacity for the Pumps near Underground Static Water Storage Tank with Minimum Pressure of 3.5 kg/cm <sup>2</sup> at Terrace Level				Number of Pump Sets as in col (5) to (8)
		litre		litre/min				
		Underground Static Water Storage Tank	Terrace Tank	Hydrant Pump	Sprinkler Pump	Stand-by Pump	Jockey Pump	
(1)	(2)	(3)		(5)	(6)	(7)	(8)	(9)
i)	Above 35 m but not exceeding 45 m in height	75 000 per set of pumps	5 000 over respective tower terrace	2 280	2 280	2 280	180 (for hydrant pump) + 180 (for sprinkler pump)	One set of pumps shall be provided for each 100 hydrants or part thereof, with a maximum of two sets. In case of more than one pump set installation, both pump sets shall be interconnected at their delivery headers
ii)	Above 45 m but not exceeding 60 m in height	150 000 per set of pumps	10 000 over respective tower terrace	2 280	2 280	2 280	180 (for hydrant pump) + 180 (for sprinkler pump)	One set of pumps shall be provided for each 100 hydrants or part thereof, with a maximum of two sets. In case of more than one pump set installation, both pump sets shall be interconnected at their delivery headers
iii)	Above 60 m in height	200 000 per set of pumps	10 000 over respective tower terrace	2 850	2 850	2 850	180 (for hydrant pump) + 180 (for sprinkler pump)	One set of pumps shall be provided for each 100 hydrants or part thereof, with a maximum of two sets. In case of more than one pump set installation, both pump sets shall be interconnected at their delivery headers
Lower levels in these high rise buildings are likely to experience high pressure and therefore, it is recommended to consider multi-stage, multi-outlet pumps (creating pressure zones) or variable frequency drive pumps or any other equivalent arrangement								

## Amendment No. 2 to SP 7 : 2005

(Page 52, clause 6.3.3.5) — Substitute the following for the existing clause:

**6.3.3.5** The requirements for compartmentation for institutional buildings of all heights shall be as given in Annex C.

[Page 65, clause C-1.5 (c)] — Insert the following at the end:

‘in case of fire lifts’

(Page 67, clause C-1.6.4.1) — Delete ‘and supply fans shall stop automatically’.

(Page 67, clause C-1.6.4.2 line 2) — Substitute ‘12 air changes per hour’ for ‘30 air changes per hour’.

(Page 67, clause C-1.8) — Substitute the following for the existing clause:

**C-1.8** All floors shall be compartmented/zoned with area of each compartment being not more than 750 m<sup>2</sup>. The size of the compartment may be as follows, in case of sprinklered basement/ building:

Sl No.	Use	Compartmentation Area m <sup>2</sup>
(1)	(2)	(3)
i)	Basement car parking	3 000
ii)	Basements (other than car parking)	2 000
iii)	Institutional Buildings sub-division C-1	1 800
iv)	Institutional Buildings sub-division C-2 and C-3	1 125
v)	Mercantile and Assembly Building	3 000
vi)	Business Buildings	2 000
vii)	All other buildings (excluding low hazard and moderate hazard industrial buildings and storage buildings)	750

<sup>a)</sup> Compartmentation for low hazard and moderate hazard industrial buildings and storage buildings shall be done in consultation with local fire department

A floor plate subject to compartmentation shall have minimum two compartments irrespective of the areas mentioned above.

Compartmentation shall be achieved by means of fire resisting wall of 2 h rating or fire curtain of 2 h rating or water curtain. In case of water curtain, existing water storage shall be supplemented by water demand for water curtain nozzles for 60 min considering the largest size of compartment. The water supply for the water curtain nozzles shall be through independent electric pump of adequate capacity (flow and head) with piping/ riser for the water supply to the nozzles.

(Page 67, clause C-1.11) — Substitute the following for the existing clause:

### **C-1.11 Refuge Area**

Provisions of 4.12.3 shall be applicable.

[Page 69, clause C-1.17 (m)] — Delete.

(Page 70, clause C-3.1) — Substitute the following for the existing clause:

**C-3.1** Buildings of different occupancies shall be equipped with manually operated fire alarm system and automatic fire alarm system in accordance with good practice [4(18)].

**Amendment No. 2 to SP 7 : 2005**

(Page 71, clause C-10) — Substitute the following for the existing clause:

**C-10 HELIPAD**

For high rise buildings above 200 m in height, provision for helipad is recommended for certain specific requirements like landing of firefighting equipment and support facilities or for other emergencies.

# **Annexure**

## **XIII**



Height Clearance  
**भारतीय विमानपत्तन प्राधिकरण**  
**AIRPORTS AUTHORITY OF INDIA**

M/s Landscape Builders Limited & others C/o M/s Un

Date: 11-02-2016

Unitech House, L-Block,  
South City-1, Gurgaon-122007

**System Generated Auto Assessment for Height Clearance**

1. Airports Authority of India (AAI) in pursuance of responsibility conferred by and as per the provisions of Govt. of India (Ministry of Civil Aviation) order GSR 751 (E) dated 30th Sep. 2015 for Safe and Regular Aircraft Operations has assessed the site data filled by the applicant.

2. Assessment details for Height Clearance:

NOCID : **PALM/NORTH/B/021116/120925**

Applicant Name : **Bharat Bhushan Wadhwa**

Type of Structure : **Building**

Site Address : **Cyber Park (15.0 Acres), Village Badshahpur, sector-69, Gurgaon**

Site Coordinates : **77 02 26.38-28 24 03.39, 77 02 27.57-28 23 59.20, 77 02 27.61-28 23 52.14, 77 02 28.91-28 23 57.43, 77 02 29.06-28 24 03.31,**

Site Elevation AMSL in **227 M**  
Mtrs as Submitted by  
Applicant:

As the site is located at a distance of 20020 m from the Aerodrome reference point of I.G.I Airport airport and the requested top elevation is 302 mtrs, the NOC for height clearance is not required from Airports Authority of India as per GSR 751(E).

3. This assessment is subject to the terms and conditions as given below:

a. The site-elevation and site coordinates provided by the applicant are taken for calculation of the permissible top elevation for the proposed structure. If, however, at any stage it is established that the actual data is different from the one, provided by the applicant, this NOC will become invalid.

b. The assessment is further subject to the provisions of Section 9-A of the Indian Aircraft Act, 1934 and any notifications issued there under from time to time including the Aircraft (Demolition of Obstruction caused by Buildings and Trees etc.) Rules, 1994.

c. The applicant is responsible to obtain all other statutory clearances from the concerned authorities including the approval of building plans. This assessment for height is to ensure the safe and regular aircraft operations and shall not be used as document for any other purpose/claim whatsoever, including ownership of land etc.

d. This assessment has been issued w.r.t. the Civil Airports as notified in GSR 751(E). Applicant needs to seek separate NOC from Defence, if the site lies within jurisdiction of Defence Airport.

Page 1/2

राजीव गांधी भवन  
Rajiv Gandhi Bhawan

सफदरजंग हवाई अड्डा नई दिल्ली-110003  
Safdarjung Airport, New Delhi-110003

दूरभाष : 24632950  
Phone: 24632950

1/7



भारतीय विमानपत्तन प्राधिकरण  
AIRPORTS AUTHORITY OF INDIA

This assessment is system auto generated and thus does not require any signature

Designated Officer

Region Name: NORTH

Address: General Manager Airports  
Authority of India, Regional  
Headquarter, Northern Region,  
Operational Offices, Gurgaon  
Road, New Delhi-110037

Email ID: noc\_nr@aai.aero

Contact No: 011-25653551

# **Annexure**

## **XIV**

**Ref: UL/Advertisement/SEIAA-15-CP/1606/2016**

**Date: 16.06.2016**

**To**  
**The Member Secretary,**  
**State Environment Impact Assessment Authority (SEIAA), Haryana**  
**Bays No. - 55-58, Prayatan Bhavan, Sector-2, Panchkula-134109**  
**Haryana**

**Ref: EC letter No. SEIAA/HR/2016/330 dated 04.05.2016 received on 10.05.2016**

**Subject: Submission of Advertisement Copy Published in two local News Paper regarding the Grant of Environmental clearance for our proposed 15 Acres "Cyber Park" at Village-Faziplur, Jharsa & Bhadshahpur, Sector 69, Gurgaon, Haryana.**

**Dear Sir,**

With reference to the above mentioned subject we are pleased to intimate you that, we have obtained Environmental Clearance letter for our Proposed 15 Acres "Cyber Park" Project at village- Faziplur, Jharsa & Bhadshahpur, Sector 69, Gurgaon, Haryana from SEIAA Haryana ref no. SEIAA/HR/2016/330 dated 04.05.2016 received on 10.05.2016. And as per General Condition- Part B, point no VII of the Environmental Clearance, the advertisement has been published in two local News Paper (English & Hindi) viz The Times of India (English) & Navbharat Times (Hindi) on dated 02.06.2016. The copy of same is enclosed herewith for your ready reference. The Environmental Clearance letter also available on our official website [www.unitechgroup.com](http://www.unitechgroup.com) for public awareness. This is your kind information and necessary records.

Thanking you,

Yours faithfully,  
**For Unitech Ltd**

  
**Authorised Signatory**

**Encl: As stated above.**

## Goan people unhappy with Nigrians: State CM

Times News Network

**Panaji:** Goan chief minister on Wednesday expressed a firm conviction with his remarks that people of Goa are annoyed by Nigrians' behaviour and attitude.

"Generally, people in Goa are not happy with them," Panaji said while talking to reporters, a day after state leader Dilip Patil's remarks that Nigrians are a problem not only in Goa but also in the rest of the country.

**Congress slammed Patil, saying it reflected the racist attitude of the BJP government.**

"On many occasions, I hear complaints about Nigrians," the CM said referring to a recent complaint of rape filed by a 20-year-old Goan woman against a Nigerian national who was later arrested in Maharashtra.

Congress slammed Patil, saying it reflected the racist attitude of the BJP government.

## Dead on paper for 12 yrs, he's living a nightmare

**New Delhi:** Sanjay Singh (55) has been declared as a missing person since 2002. And his kin unique problem - he has been officially dead for 12 years and everything he does is done in the name of the dead.

Sanjay Singh, 55, was married to a woman named Sunita. They had a son named Arjun. Sanjay Singh was a well-known person in his village in Uttar Pradesh. He was a successful businessman and a social worker.

## Delhi is becoming racist, says HC

Court: No Let Up In Crime Against Women Either; Centre Says Fixing It

**New Delhi:** The Delhi high court on Wednesday remarked that while crime against women was not continuing, "Delhi is becoming racist".

A division bench of Justices J.S. Mehta and Justice R.K. Jaisankar expressed their concern over the rising incidents of violence against women in the city.

The court also questioned the government's failure to take effective measures to protect women from such crimes.

## LINE OF NO CONTROL



Source: Anand

## Ban of Chinese manjas sought

Times News Network

**New Delhi:** The Delhi high court on Wednesday sought a ban on the sale and consumption of manjas (a type of Chinese food) in the city.

The court expressed concern over the health risks associated with the consumption of manjas, which are often made with expired ingredients and lack proper hygiene.

## Exotic tortoises rescued from park

**New Delhi:** Two Indian star tortoises were rescued by the Delhi Forest Department from a private park in the city.

The tortoises were found in a cage and were in poor health. They were rescued and taken to a wildlife sanctuary for rehabilitation.

The park owner claimed that the tortoises were part of a private collection. However, the Forest Department officials stated that the tortoises were illegally kept in a private park and were in need of immediate medical attention.

**King George Medical University, U.P., Lucknow**

Applications are invited for M.Sc. Nursing Courses at K.G. Medical University, Yashwantrao Chavan College of Nursing and Hind College of Nursing, for session 2016. Application form and details on website: [www.kgmuni.org](http://www.kgmuni.org)

**Indian Council of Agricultural Research**

Central Arid Zone Research Institute  
Light Industrial Area, Jodhpur- 342003

**Walk-in-Interview**

Applications are invited for Senior Research Fellow (SRF) at the Central Arid Zone Research Institute, Jodhpur. The post is in the category of Agricultural Scientist (M.Sc. in Agricultural Science) and is a full-time position. The candidate should have a M.Sc. degree in Agricultural Science and should have worked for at least two years in a research organization. The salary is Rs. 25,000 per month. The closing date for applications is June 10, 2015. For details visit the ICAR website: [www.icar.org](http://www.icar.org)

**many SAT / ACT GRE GMAT**

Batches Starting June 4, 2015

1 ON 1 Tutoring Also Available

The Prime Learning Centre - Gurukul  
Near Sector 13, Gurukul  
Ph: 0124-403 683, 8825527682

**NOTICE**

This is for the information of all the students of the Institute of Management Studies, Delhi, who are enrolled in the M.A. (English) programme. The Institute has decided to conduct the final examination for the M.A. (English) programme in the month of June 2015. The examination will be held on June 10, 2015. The students are requested to appear for the examination on the date mentioned above. The Institute reserves the right to cancel the examination if the number of students appearing is less than the minimum required. For more details, please contact the Institute office.

**Dead on paper for 12 yrs, he's living a nightmare**

Sanjay Singh, 55, was married to a woman named Sunita. They had a son named Arjun. Sanjay Singh was a well-known person in his village in Uttar Pradesh. He was a successful businessman and a social worker.

Sanjay Singh was declared dead in 2002. However, he has been alive ever since. He has been living a nightmare, as he has to deal with the legal and financial consequences of being declared dead.



# **Annexure XV**

## **ENVIRONMENTAL POLICY**

**unitech**

We, at Unitech Ltd. are committed not only to fulfill applicable Environmental legislations but also to take our own initiatives for the betterment of the environment, both during the Construction as well as Operation phase of our construction projects. We are continuously evolving & improving our construction standards by adopting best available techniques.

### **ENVIRONMENTAL IMPLEMENTATION GUIDELINES:**

- To identify, assess and responsibly manage the environmental risk through management plan.
- To comply with all the applicable rules and regulations.
- To minimize / optimize consumption of natural resources through the reduction, reuse or recycling of materials, as much as possible.
- To actively promote the concept of sustainability in the building design & implementation.
- To integrate the consideration of environmental concerns and impacts in all of our decision making and activities.
- To promote environmental awareness among our employee and encourage them to work in an environmentally responsible manner.
- To impart knowledge & training and motivate all those influenced by the project's activities to participate responsibly in Environment improvement.
- To have systems in place to appraise employees and partners in meeting Environmental obligations
- To strive to continually improve its environmental performance by periodically reviewing its environmental policy in light of current and planned work.

**Dated: 05<sup>th</sup> June, 2012**

  
(Chairman)  
**Unitech Limited**