

**ORIGINAL SANCTIONED PLAN
(MEMO NO 57911, DATED 19-11-2013)**

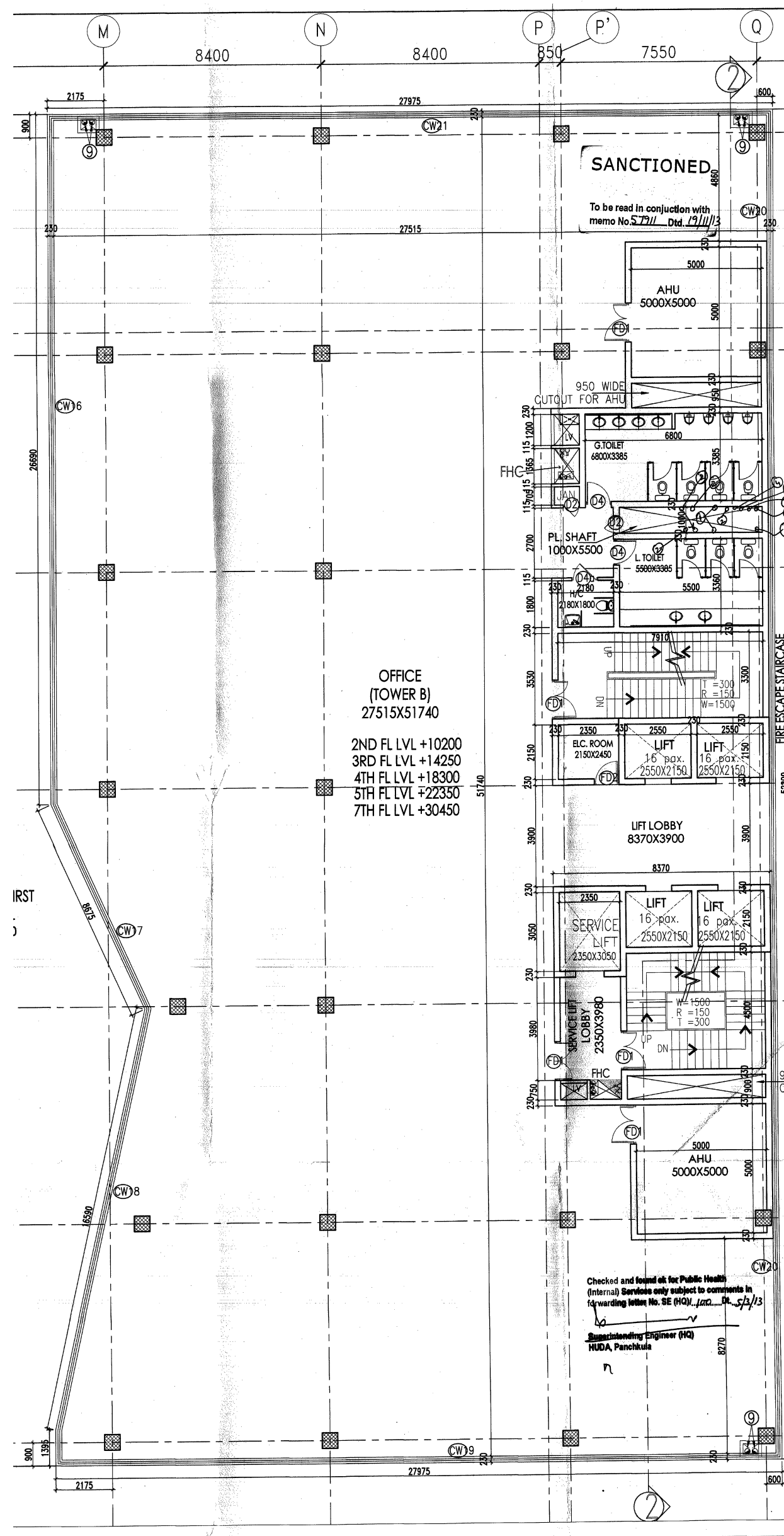

GENERAL NOTES
 1. ALL BUILDING INCLUDING BASEMENTS ARE MECHANICALLY LIGHTED AND VENTILATED AS PER B.C. NORMS.
 2. ALL BUILDING INCLUDING BASEMENT FULLY SPRINKLERED AS PER B.C. NORMS.
 3. SHAFTS ARE MECHANICALLY LIGHTED AND VENTILATED AS PER B.C. NORMS.
 4. 100% POWER BACKUP PROVIDED.

SCHEDULE OF OPENING (CIVIL OPENING)

TYPE	SIZE	C.LVL	L.LVL	REMARKS
D1	650X2000	+100	+2100	SHAFT DOOR
D2	750X2100	+000	+2100	SINGLE SHUTTER FLUSH DOOR
D3	900X2100	+000	+2100	SINGLE SHUTTER FLUSH DOOR
D4	1000X2100	+000	+2100	SINGLE SHUTTER FLUSH DOOR
D5	1050X2100	+000	+2100	SINGLE SHUTTER FLUSH DOOR
D6	1500X2100	+000	+2100	DOUBLE SHUTTER FLUSH DOOR
D7	1800X2100	+000	+2100	DOUBLE SHUTTER FLUSH DOOR
F01	1500X2100	+000	+2100	FIRE RATED INSULATED SHUTTER DOOR
F02	1050X2100	+000	+2100	FIRE RATED SHUTTER DOOR
F03	1500X1800	+300	+2100	FIRE RATED STEEL DOOR
CW 12				EXTERIOR CURTAIN WALL
CW 13				EXTERIOR CURTAIN WALL
CW 14				EXTERIOR CURTAIN WALL
CW 15				EXTERIOR CURTAIN WALL
CW 16				EXTERIOR CURTAIN WALL
CW 17				EXTERIOR CURTAIN WALL
CW 18				EXTERIOR CURTAIN WALL
CW 19				EXTERIOR CURTAIN WALL
CW 20				EXTERIOR CURTAIN WALL

SH. VIRENDER KUMAR BHATNAGAR
 S/O SH. K.C. BHATNAGAR
 C/O UNITECH LIMITED
 6, COMMUNITY CENTRE, SAKET
 NEW DELHI - 110017

PROPOSED PLAN FOR COMMERCIAL COLONY MEASURING AREA 3.37 Acres (LICENCE NO.106 OF 2012 DATED 08/10/2012) SECTOR-26, GURGAON MANESAR URBAN COMPLEX BEING DEVELOPED BY SH. VIRENDER KUMAR BHATNAGAR S/O SH. KISHAN CHAND BHATNAGAR IN COLLABORATION WITH UNITECH LIMITED.

SAA
SIKKA ASSOCIATES ARCHITECTS
 P.L. SIKKA ARCHITECT, 2ND FLOOR, 10/10, SECTOR-26, GURGAON, HARYANA
 2ND FLOOR, 10/10, SECTOR-26, GURGAON, HARYANA

For UNITECH LIMITED
S. K. MAHAJAN
 Authorised Signatory
 anand kr. tiwari
 REGN. NO. CA/2007/40/03

SCALE: 1:50
 DATE ISSUED: 24-08-2017
 DRAWN BY: Nishu Das
 CHECKED BY:

TYPICAL FLOOR PLAN (2nd, 3rd, 4th, 5th & 7th)
VGC-07

BLOCK - B , 5TH FLOOR PLAN

**IN PRINCIPLE REVISED SANCTIONED PLAN
(MEMO NO ZP-859/AD(RA)/2018/32207, DATED 22.11.2018)**

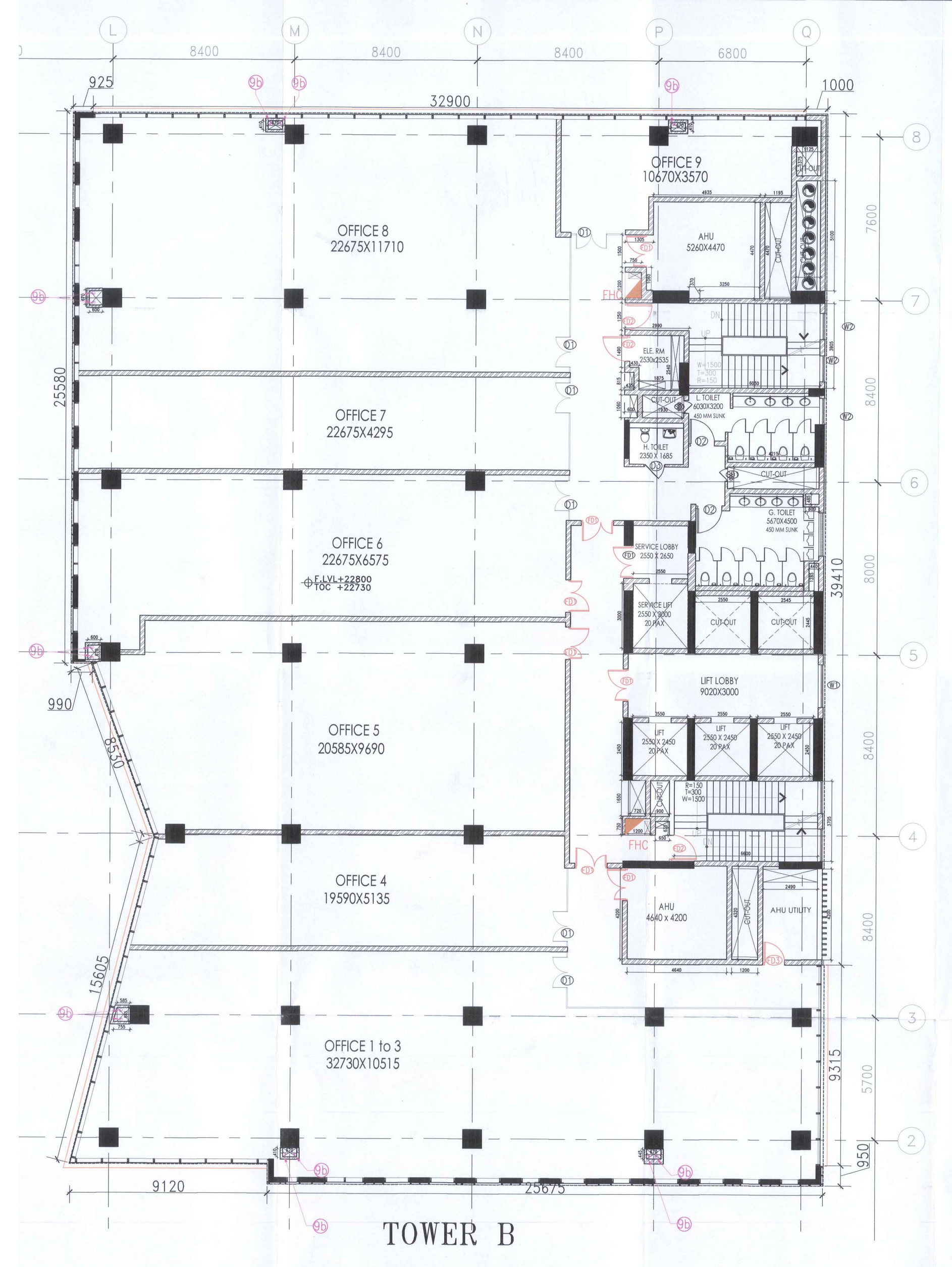

GENERAL NOTES
 1. ALL BUILDING INCLUDING BASEMENTS ARE MECHANICALLY LIGHTED AND VENTILATED AS PER B.C. NORMS.
 2. ALL BUILDING INCLUDING BASEMENT FULLY SPRINKLERED AS PER B.C. NORMS.
 3. SHAFTS ARE MECHANICALLY LIGHTED AND VENTILATED AS PER B.C. NORMS.
 4. 100% POWER BACKUP PROVIDED.

SH. VIRENDER KUMAR BHATNAGAR
 S/O SH. K.C. BHATNAGAR
 C/O UNITECH LIMITED
 6, COMMUNITY CENTRE, SAKET
 NEW DELHI - 110017

REVISED PLAN FOR COMMERCIAL COLONY MEASURING AREA 3.37 Acres (LICENCE NO.106 OF 2012 DATED 08/10/2012) SECTOR-26, GURGAON MANESAR URBAN COMPLEX BEING DEVELOPED BY SH. VIRENDER KUMAR BHATNAGAR S/O SH. KISHAN CHAND BHATNAGAR IN COLLABORATION WITH UNITECH LIMITED.

SAA
SIKKA ASSOCIATES ARCHITECTS
 P.L. SIKKA ARCHITECT, 2ND FLOOR, 10/10, SECTOR-26, GURGAON, HARYANA
 2ND FLOOR, 10/10, SECTOR-26, GURGAON, HARYANA

For UNITECH LIMITED
S. K. MAHAJAN
 Authorised Signatory
 raman sikka
 REGN. No. 93/16497

SCALE: 1:50
 DATE ISSUED: 24-08-2017
 DRAWN BY: R.M.
 CHECKED BY: ASHWIN

5TH FLOOR PLAN
VGC-09

BLOCK - B , 5TH FLOOR PLAN