

Location Map

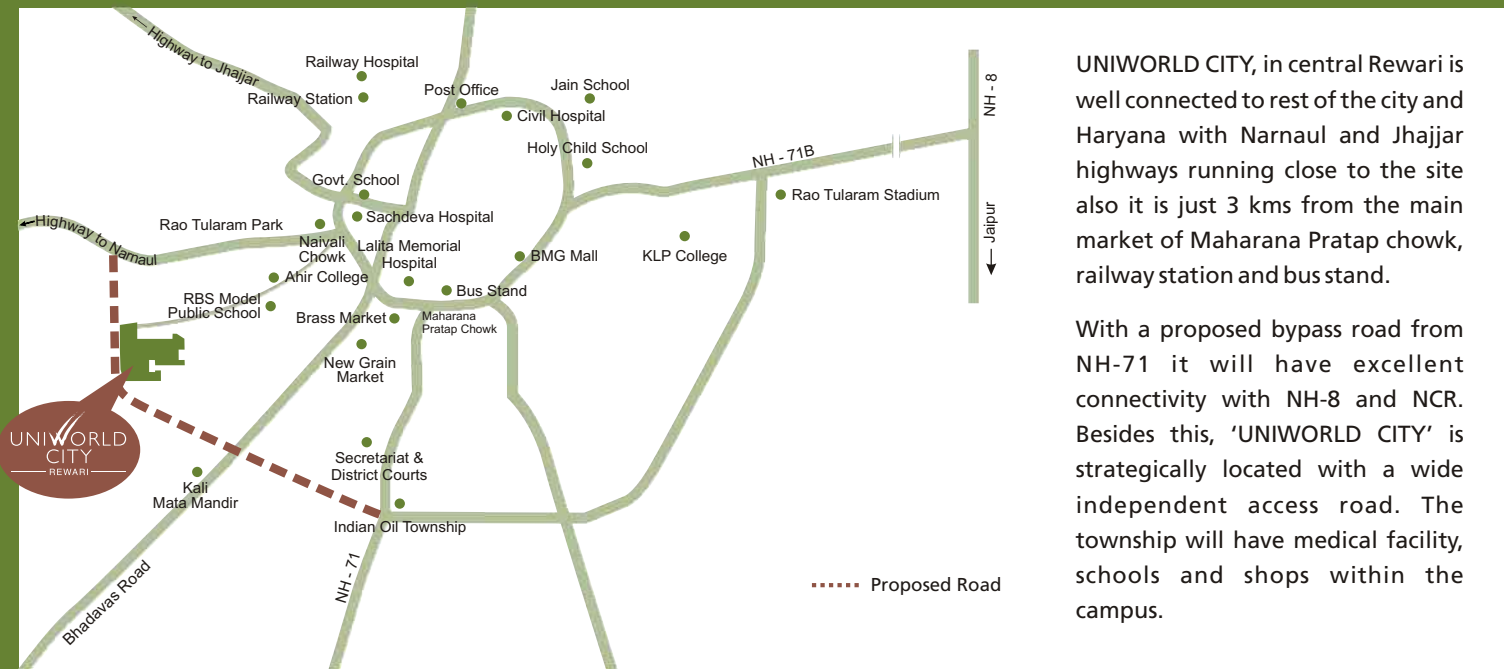

UNIWORLD CITY, in central Rewari is well connected to rest of the city and Haryana with Narnaul and Jhajjar highways running close to the site also it is just 3 kms from the main market of Maharana Pratap chowk, railway station and bus stand.

With a proposed bypass road from NH-71 it will have excellent connectivity with NH-8 and NCR. Besides this, 'UNIWORLD CITY' is strategically located with a wide independent access road. The township will have medical facility, schools and shops within the campus.

About Unitech



Established in 1972, Unitech is today a leading real estate developer in India. Known for the quality of its products, it is the first developer to have been certified ISO 9001:2000 in North India and offers the most diversified product mix comprising residential, commercial/IT parks, retail, hotels, amusement parks and SEZs.

The well-recognised brand was yet again conferred with the title of 'Superbrand' by Superbrands India in 2009. The Company is also the recipient of the CW Architect and Builders Award, 2008 for being one of India's Top Ten Builders. Unitech has long partnered with internationally acclaimed architects and design consultants including SOM (USA), BDP (UK), Maunsell AECOM (HK), MEA Systra (France), Callison Inc. (USA), FORREC (Canada), SWA and HOK (USA) for various projects.

It has an enviable clientele for commercial projects including Fidelity, McKinsey, Bank of America, Ford Motors, Nike, EDS, Hewitt, Amdocs, Ernst & Young, Reebok, Keane, Seagrams, Perfetti, Exxon Mobil and AT Kearney. Recently the Company has ventured into the infrastructure business by launching Unitech Infra, thus leveraging its decades of experience and expertise in real estate.

Unitech Scrip is one of the most liquid stocks in the Indian stock markets and was the first real estate company to be part of the National Stock Exchange's NIFTY 50 Index. The company has over 600,000 shareholders.



Rewari (Sales Office) : Sector - 15, Near Gopaldev Chowk, Rampura, Rewari, Haryana.
Ph.: 8930444358, 8930444359

Mktg. Office (Gurgaon) : Unitech Signature Towers, Level - 1, South City - 1, N.H. - 8, Gurgaon - 122001
Tel: +91 124 4552000 | sales@unitechgroup.com | www.unitechgroup.com

UNIWORLD
CITY
REWARI

unitech

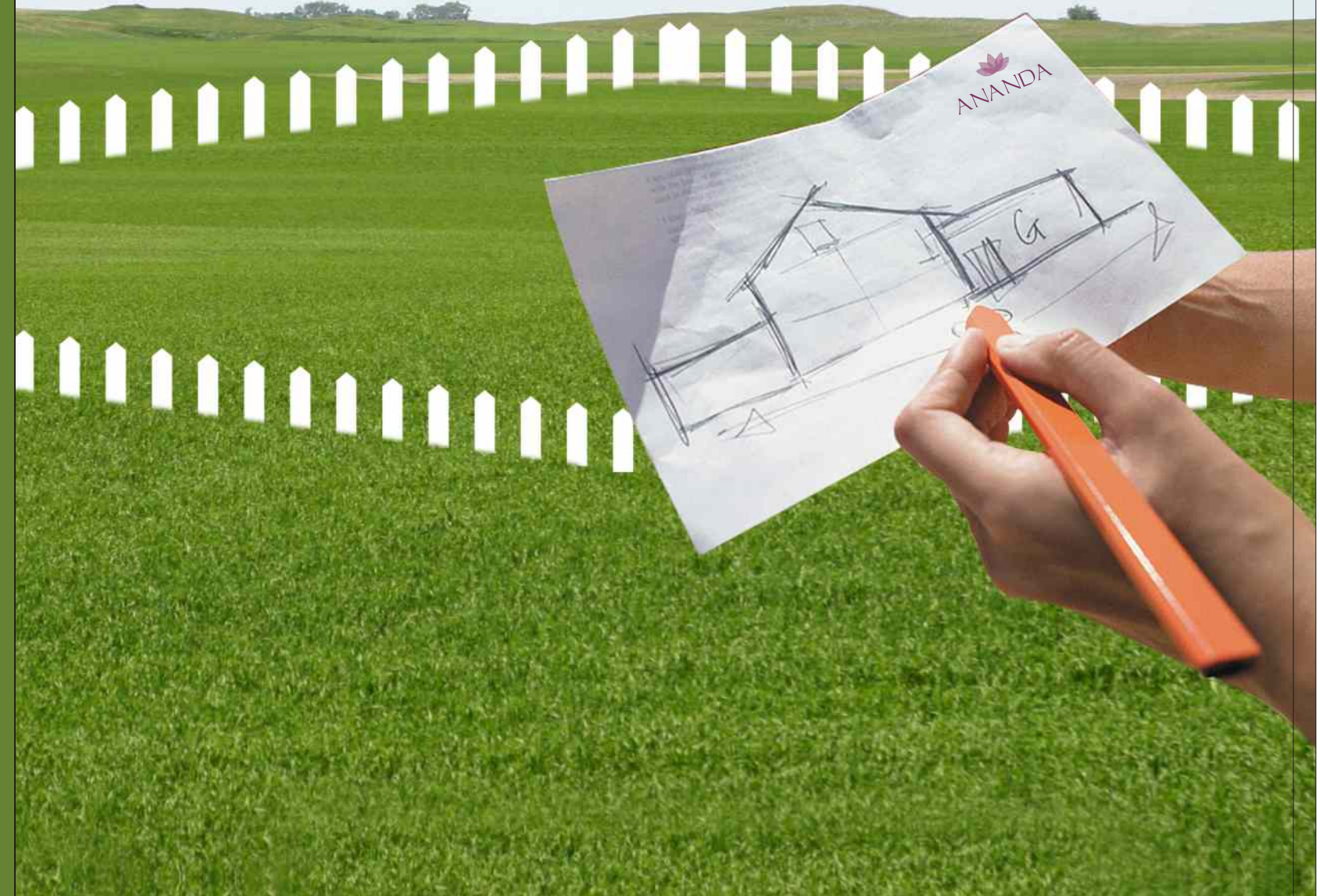

ANANDA

Ananda - Uniworld City, Rewari



Feature

- 83 acres of Secured Gated Township
- 5 minutes drive from Brass Market, Railway Station & Bus Stand
- Strategically located on 45 m wide road linking the site to Narnaul Highway & NH-71
- Convenience Shopping, Schools & Medical Facilities within the township
- Community Centre

Spread across 83 acres of integrated township, Ananda at Uniworld City Rewari offers you tranquil living in plots ranging from 360 – 1000 sq. yds. Uniworld City Rewari is strategically located on 45 m wide road linking the site to Narnaul Highway & NH-71 just 5 minutes drive from Brass market, Railway station & Bus stand. Come and live amidst nature in an idyllic ambience designed by renowned architects.

Project Specification

Location : Uniworld City, Rewari
 Total Area : Part of 83 acres Integrated Township
 Sizes : 360 - 1000 sq. yds.

Plot Utilization

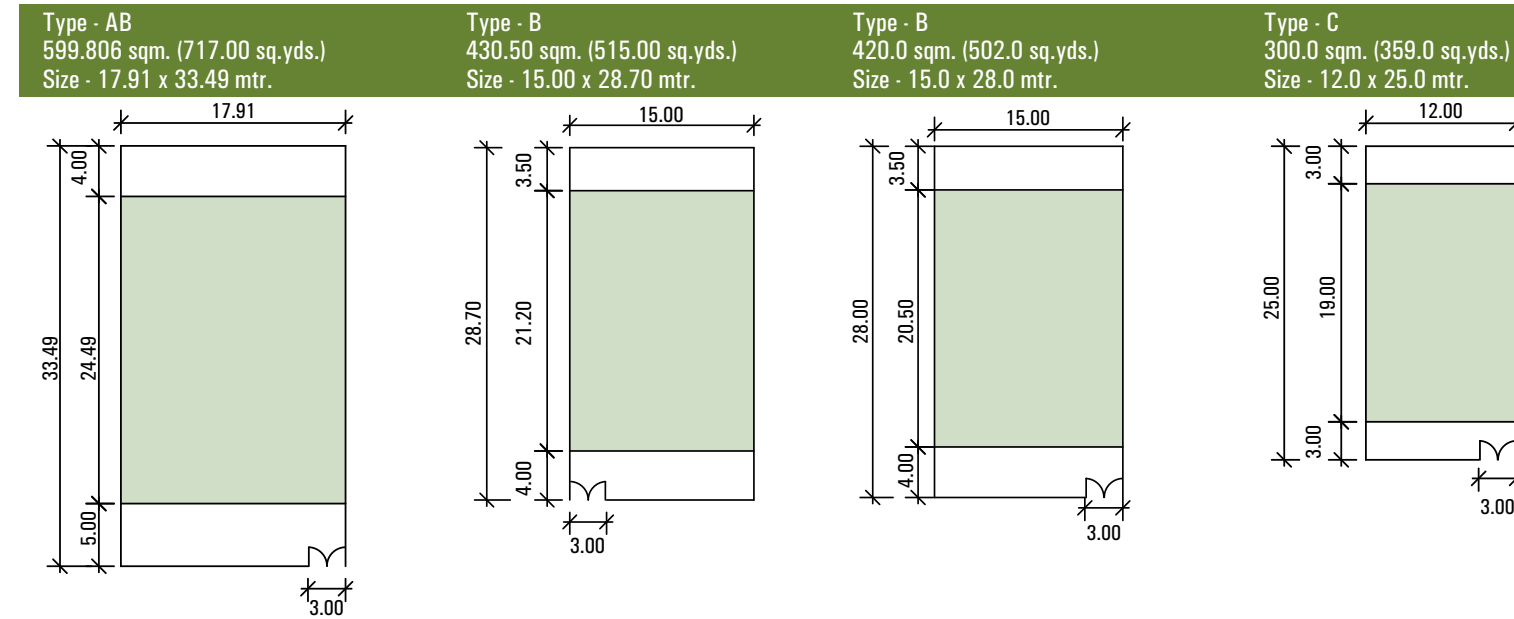

Block	Type	Area (in sq.mts.)	Area (in sq.yds.)	Dimensions (in mts.)	Permissible Ground Coverage (in sq.ft.)	F.A.R (in sq.ft.)
C	AB	599.81	717.00	17.91 x 33.49	2986.28	7017.00
C	AB 15	567.66	679.00	16.95 x 33.90	2865.18	6740.15
C	AB 8	567.32	678.50	16.94 x 33.90	2863.90	6737.26
D	B	430.50	515.00	15.00 x 28.70	2337.94	5559.06
C	B	420.00	502.00	15.00 x 28.00	2292.73	5468.65
C	B 23	394.80	472.00	14.10 x 28.00	2184.23	5210.96
A	C 56	353.75	423.00	14.15 x 25.00	2007.49	4791.19
A	C 91	353.75	423.00	14.15 x 25.00	2007.49	4791.19
A	C	300.00	359.00	12.00 x 25.00	1776.06	4241.55

Master Plan

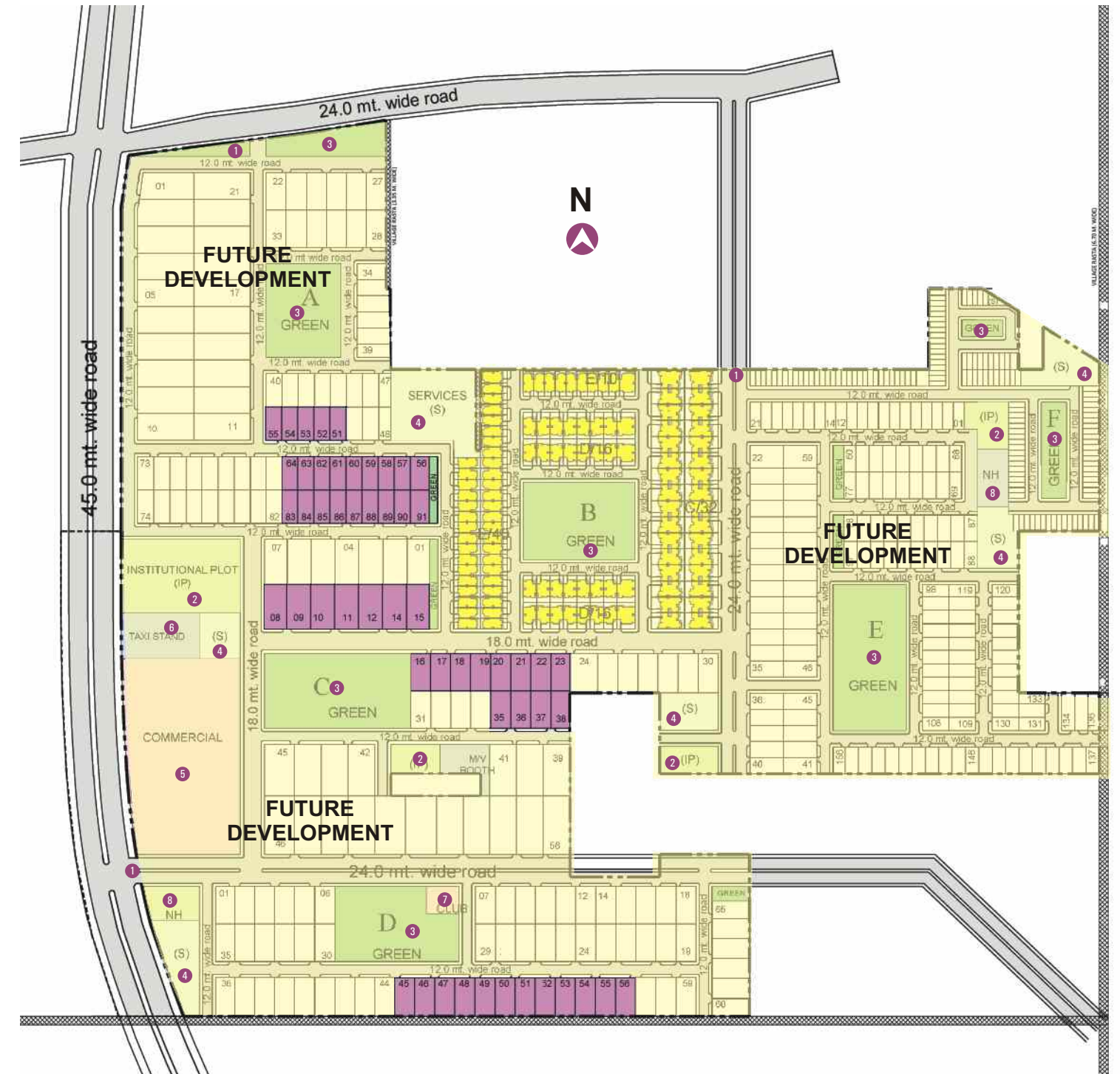

- 1 Entry / Exit
- 2 School
- 3 Green Area
- 4 Services
- 5 Commercial Office / Shopping Center
- 6 Utilities
- 7 Club
- 8 Nursing Home

